

# Technical data

Pump name 2CDX 70/12

Customer	Date 09.06.2024	Company
Contact	Item no.	Issued by
Phone	Project	Phone
E-mail	Project ID	E-mail

## Requested data

1	Pump type	CENTRIFUGAL PUMPS	Fluid	Water
2	Number of pumps / Reserve	1 / 0	Liquid temperature °C	20
3	Flow m <sup>3</sup> /h		Kin. viscosity cSt	1.005
4	Head m		Vapour pressure kPa	2.34
5	Geodetic head m		PH value	
6	Inlet pressure (pin) kPa	0	Density kg/m <sup>3</sup>	998.3
7	Available system NPSH		Solids Weight %	0
8	Ambient temperature °C	20		

## Pump

9	Pump name	2CDX 70/12	Frequency Hz	50
10	Design	CENTRIFUGAL PUMPS	Installation type	STANDARD
11	Manufacturer	EBARA	Impeller Diameter	Max. mm -
12	Speed rpm	2800		Designed mm
13	No. of Stage	2		Min. mm -
14	Connection Suction side	UNI ISO 228-1	Flow	Operating m <sup>3</sup> /h
15	Connection Discharge side	UNI ISO 228-1		Max- m <sup>3</sup> /h 4.8
16	Max Working Pressure kPa	800		Min- m <sup>3</sup> /h 1.2
17	Shut-off head kPa	470.08	Head	Operating m
18	Total weight kg	See the table of "Dimensions".		- (Qmax.) m 30.0
19	Shaft power kW			- (Qmin.) m 44.5
20			Max. Shaft Power at max. impeller kW	1.06
21	Required pump NPSH m		Efficiency %	

## Materials

22	Impeller	AISI 304		
23	Casing	AISI 304		
24	Shaft	AISI 304		
25				
26				
27				

## Motor

28	Manufacturer	EPE Standard	Insulation class	F
29	Type	TEFC_2CDXM 70/12_230_Single Phase	Phases	1~
30	Specific design	IE2 / 50 Hz / Pole pairs 1	Frame size	
31	Rated power kW	0.9	Weight kg	
32	Number of poles	2	Electric voltage V	230
33	Speed rpm	2800	Electric current A	5.4
34	Degree of protection	IP 55		
35				

## Remarks

# Performance curve

Pump name 2CDX 70/12

Customer	Date 09.06.2024	Company
Contact	Item no.	Issued by
Phone	Project	Phone
E-mail	Project ID	E-mail

## Requested data

1	Flow	m <sup>3</sup> /h	
2	Head	m	
3	Geodetic head	m	

## Pump

Operating flow	m <sup>3</sup> /h	Impeller Diameter Designed	mm	
Operating head	m	Frequency	Hz	50
		Speed	rpm	2800

Test standard: ISO 9906:2012 - Grade3B

Water; 20°C; 998.3kg/m<sup>3</sup>; 1cSt

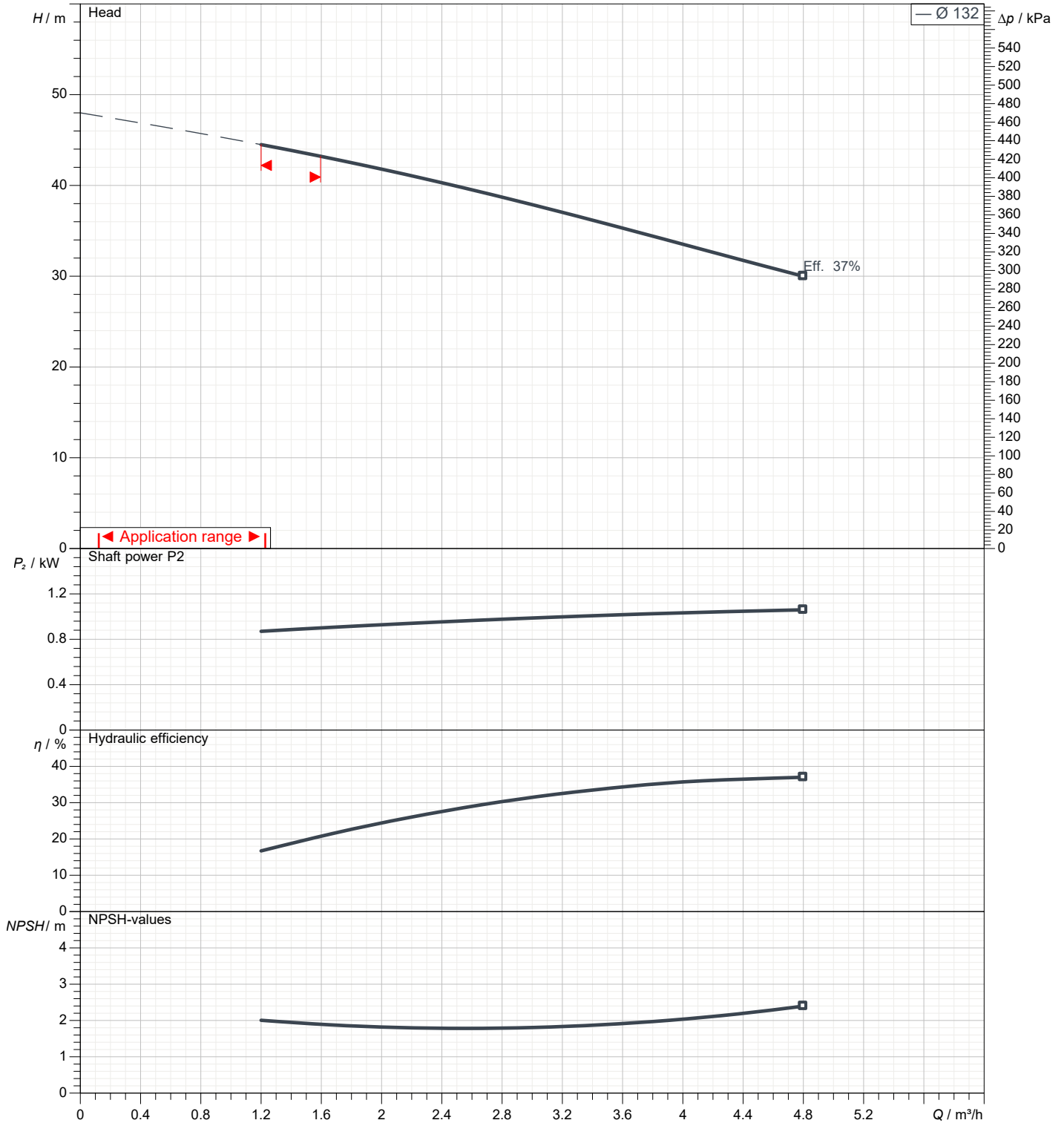

# Dimensions

Pump Name 2CDX 70/12

Customer	Date 09.06.2024	Company
Contact	Item no.	Issued by
Phone	Project	Phone
E-mail	Project ID	E-mail

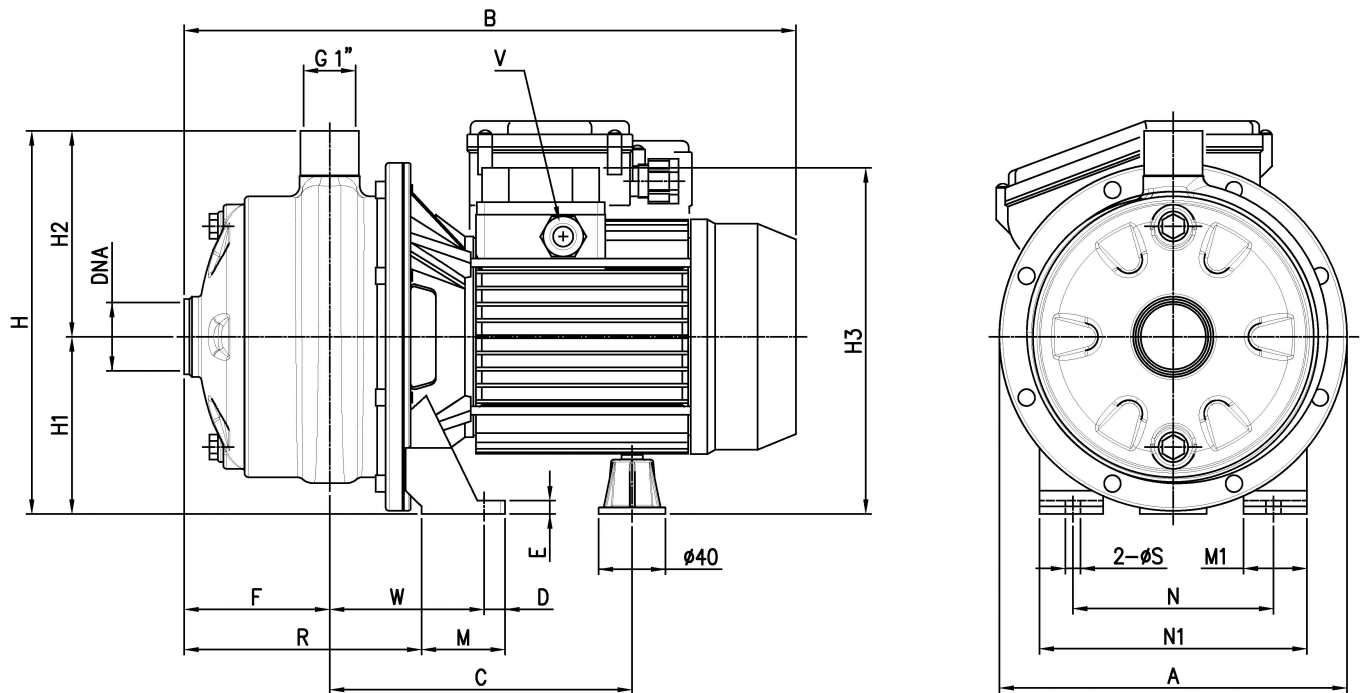

Dimensions in		mm						
1	A	208	R	142				
2	B	366	S	9				
3	C	181	V	M16X1.5				
4	D	12.5	W	95				
5	DNA	G1 1/4	Weight P&M	13.7 kg				
6	E	8						
7	F	89						
8	H	229						
9	H1	106						
10	H2	123						
11	H3	207						
12	M	50						
13	M1	40						
14	N	140						
15	N1	160						

(1/3)

# Construction

Pump Name 2CDX 70/12

Customer	Date 09.06.2024	Company
Contact	Item no.	Issued by
Phone	Project	Phone
E-mail	Project ID	E-mail

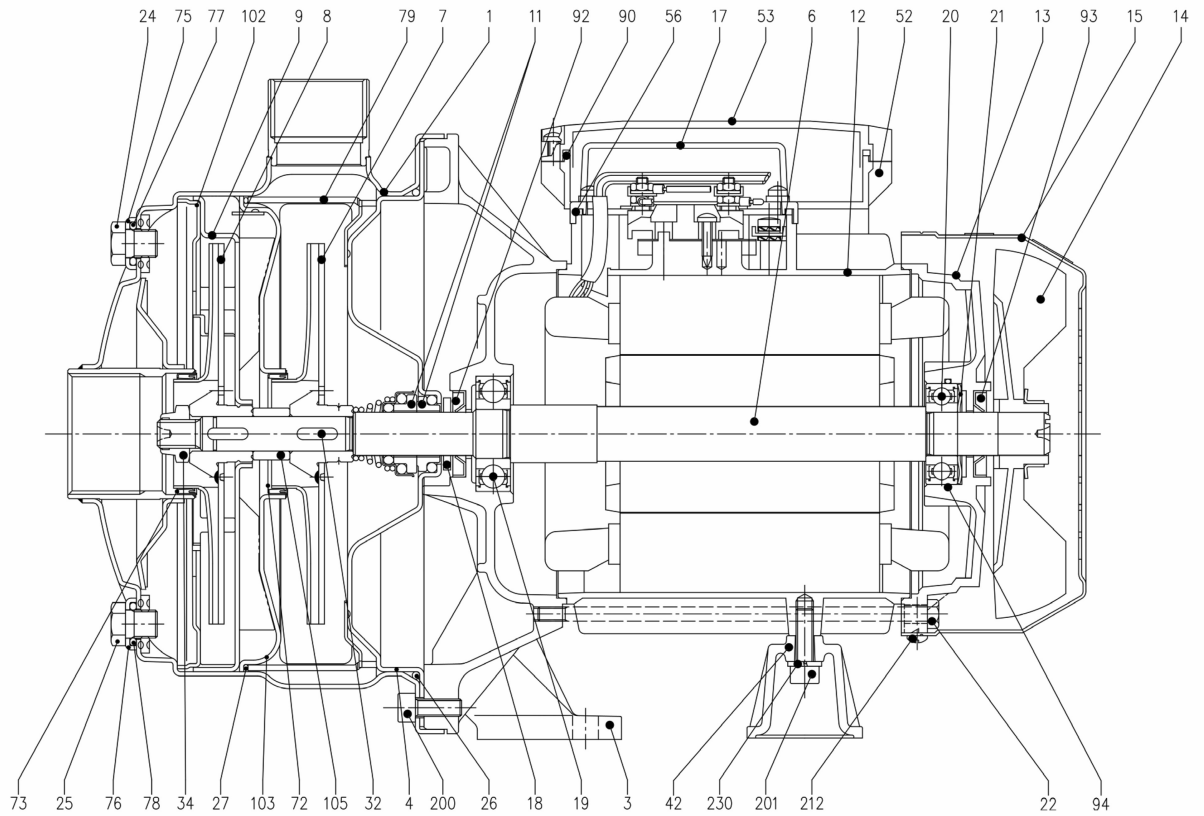

(2/3)

# Construction

Pump Name 2CDX 70/12

Customer	Date 09.06.2024	Company
Contact	Item no.	Issued by
Phone	Project	Phone
E-mail	Project ID	E-mail

N°	PART NAME	MATERIAL	DIMENSION	STANDARD	Q.TY
1	Casing	AISI 304 / AISI 316L [6]			1
3	Motor bracket	[4]			1
4	Casing cover	AISI 304 / AISI 316L [6]			1
6	Shaft with rotor	AISI 303 / AISI 316L [6] (Wet extension)			1
7	Impeller	AISI 304 / AISI 316L [6]			1
8	Impeller	AISI 304 / AISI 316L [6]			1
9	Diffuser	AISI 304 / AISI 316L [6]			1
11	Mechanical seal [7]	Ceramic/Carbon/NBR			1
12	Motor frame with stator	-			1
13	Motor cover	Aluminium			1
14	Fan	PA			1
15	Fan cover	Fe P04 Galvanized			1
17	Terminal box cover [2]	Aluminium			1
18	Splash ring	NBR			1
19	Pump side ball bearing	-			1
20	Fan side ball bearing	-			1
21	Adjusting ring	Steel C70			1
22	Tie rod	Fe 420 Galvanized			4
24	Priming plug	AISI 304 / AISI 316 [6]			1
25	Drain plug	AISI 304 / AISI 316 [6]			1
26	O-ring [3]	NBR			1
27	O-ring [3]	NBR			1
32	Key	AISI 316			2
34	Impeller nut	Stainless steel A2-70	M10X1.25	UNI 7474	1

N°	PART NAME	MATERIAL	DIMENSION	STANDARD	Q.TY
42	Motor support	Aluminium			1
52	Capacitor box	[1] ABS class V-0			1
53	Capacitor box cover	[1] ABS class V-0			1
56	Box gasket	NBR			1
72	Casing ring	[5] NBR			1
73	Casing ring	[5] NBR			1
75	Washer	AISI 304			1
76	Washer	AISI 304			1
77	O-ring	[3] NBR			1
78	O-ring	[3] NBR			1
79	Space diffuser	AISI 304 / AISI 316 [6]			1
90	Terminal box cover gasket	[1] NBR			1
92	Lip seal	NBR			1
93	Lip seal	NBR			1
94	O-ring	[8] NBR	34.65x1.78		1
102	Suction cover	AISI 304 / AISI 316 [6]			1
103	Conveyor cover	AISI 304 / AISI 316 [6]			1
105	Sleeve	AISI 304 / AISI 316 [6]			1
200	Screw	70/10, 120/15, 120/20, 200/30	M6X16	UNI 5931	8
		70/12, 70/15, 70/20, 120/30, 120/40, 200/40, 200/50	M8X18		
201	Screw	Zn. Steel cl.8.8		UNI 5931	1
212	Screw	Stainless steel A2	3.5X9.5	UNI 6954	4
230	Washer	Steel C70	6.4	UNI 1751	1

[1] Only for single phase

[2] Only for three phase

[3] FPM for H-HS-HW-HSW

EPDM for E and Special Mechanical Seals

[4] Material: Aluminium for version up to 1.5 kW included  
Cast iron for version 2.2 kW and above

[5] FPM for H-HS-HW-HSW

[6] Only for "L" version

[7] See CONSTRUCTION 3

[8] Only for 70/12 (three phase)

# (3/3) Construction

Pump Name 2CDX 70/12

Customer	Date 09.06.2024	Company
Contact	Item no.	Issued by
Phone	Project	Phone
E-mail	Project ID	E-mail

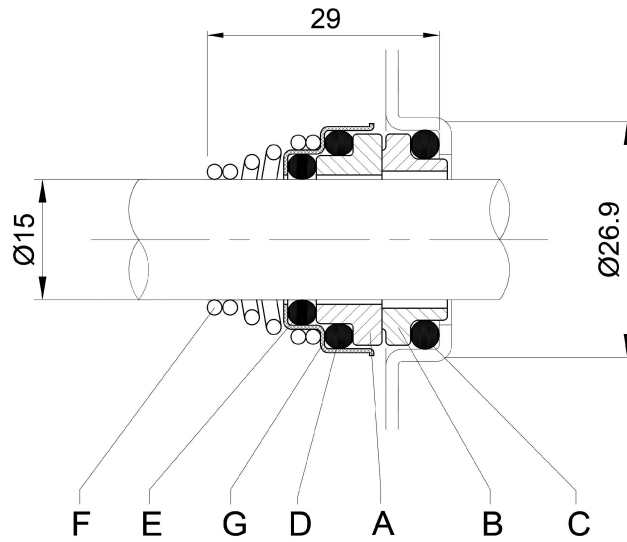

REF	PART NAME	MATERIAL Standard and L version
A	Rotary seal ring	Ceramic
B	Stationary seal ring	Carbon graphite
C	O-Ring	NBR
D	O-Ring	NBR
E	O-Ring	NBR
F	Self-driving spring	AISI 316
G	Frame	AISI 304