

Technical Data

Booster set name
2GP AGA 3.00

Customer	Date 09.06.2024	Company
Contact	Item no.	Issued by
Phone	Project	Phone
E-mail	Project ID	E-mail

Requested data

1	Pump type	Booster Set	Fluid	Water
2	Number of pumps	2	Liquid temperature °C	20
3	Flow m ³ /h		Kin. viscosity cSt	1.005
4	Head m		Vapour pressure kPa	2.34
5	Geodetic head m		PH value	
6	Inlet pressure kPa	0	Density kg/m ³	998.3
7	Available system NPSH	Ask our technical department.	Solids Weight %	0
8	Ambient temperature °C	20	Installation height m	100

Booster Set

9	Booster set name	2GP AGA 3.00	Frequency Hz	50
10	Design	Booster Set		
11	Manufacturer	EBARA	Impeller Dia.	Max. mm 164
12	Speed rpm	2850		Designed mm 164
13	No. of Stage	1		Min. mm 164
14	Connection Suction side	G2 1/2 PN10	Flow	Operating m ³ /h
15	Connection Discharge side	G1 1/2 PN10		Max- m ³ /h 6
16	Max Working Pressure kPa	1000		Min- m ³ /h 0.6
17	Shut-off head kPa	705.06	Head	Operating m
18	Total weight kg	See the table of "Dimensions".		- (Qmax.) m 42.0
19	Shaft power kW			- (Qmin.) m 68.0
20			Max. Shaft Power at max. impeller kW	2.07
21	Required NPSH m		Efficiency %	

Materials

22	Frame	Galvanized steel	Casing cover	Cast Iron built-in on the motor bracket
23	Manifold	AISI 304	Shaft	AISI 303
24	Check valve	Brass / NBR	Shaft seal	Ceramic/Carbon/NBR
25	Ball valve	Brass / PTFE	O-ring	NBR
26	Impeller	Brass	Ejector	PPE+PS glass fibre reinforced
27	Casing	Cast iron	Diffuser	PPE+PS glass fibre reinforced

Motor

28	Manufacturer	EPE Standard	Insulation class	F
29	Type	TEFC_AGA 3.00 T_400_Three Phase	Phases	3~
30	Specific design	IE3 / 50 Hz / Pole pairs 1	Frame size	
31	Rated power kW	2.2	Weight; motor kg	
32	Number of poles	2	Electric voltage V	400
33	Speed rpm	2800	Electric current A	4.7
34	Degree of protection	IP 44		
35				

Remarks

--

Performance curve

Booster set name
2GP AGA 3.00

Customer	Date 09.06.2024	Company
Contact	Item no.	Issued by
Phone	Project	Phone
E-mail	Project ID	E-mail

Requested data

1	Flow	m³/h	
2	Head	m	
3	Geodetic head	m	

Booster set

Operating flow	m³/h		Frequency	Hz	50
Operating head	m		Number of poles		2
ImpellerDiameter Designed	mm	164	Speed	rpm	2850

Test standard: ISO 9906:2012 - Grade3B

Water; 20°C; 998.3kg/m³; 1cSt

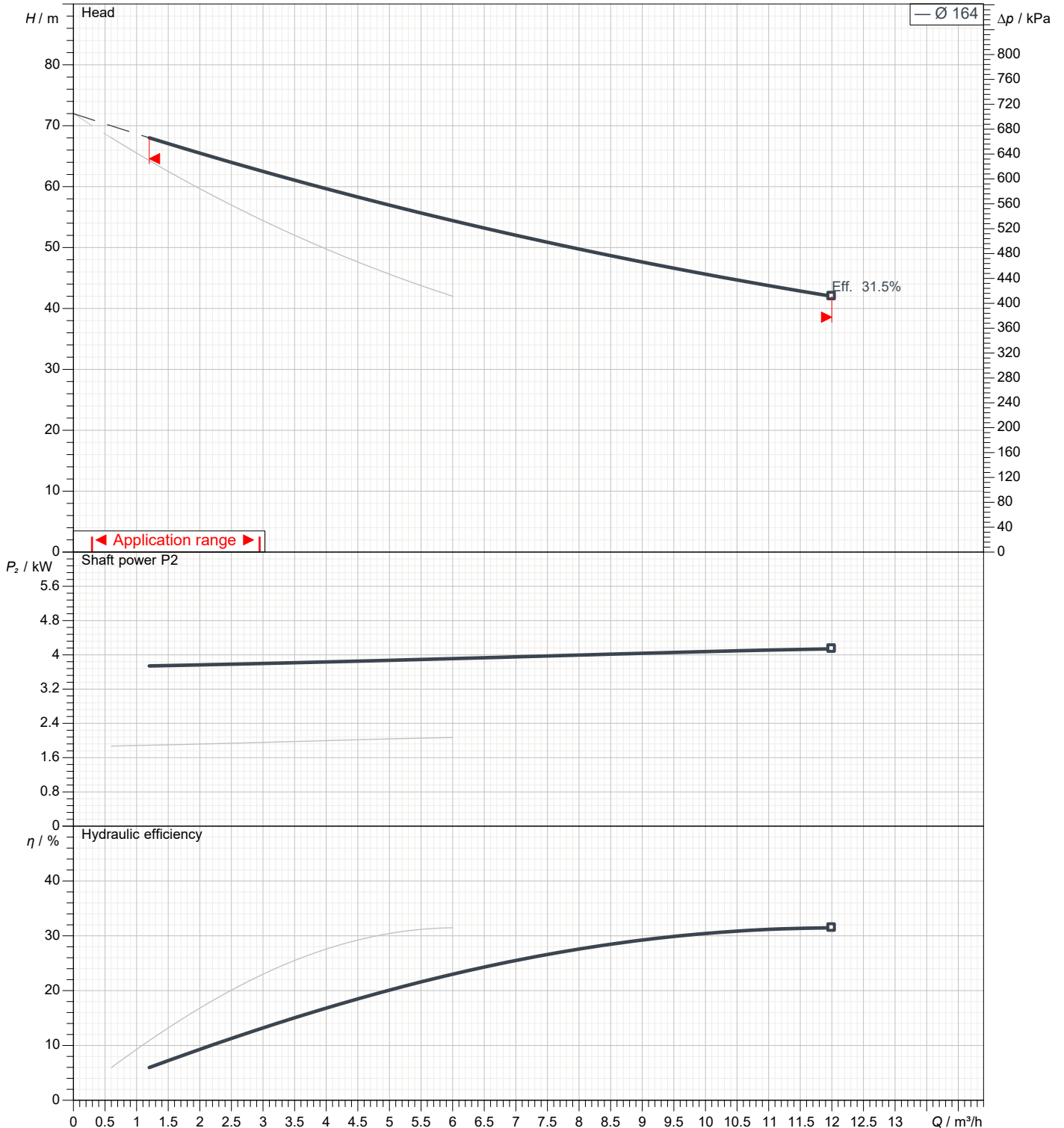

Dimensions

Booster set name
2GP AGA 3.00

Customer	Date 09.06.2024	Company
Contact	Item no.	Issued by
Phone	Project	Phone
E-mail	Project ID	E-mail

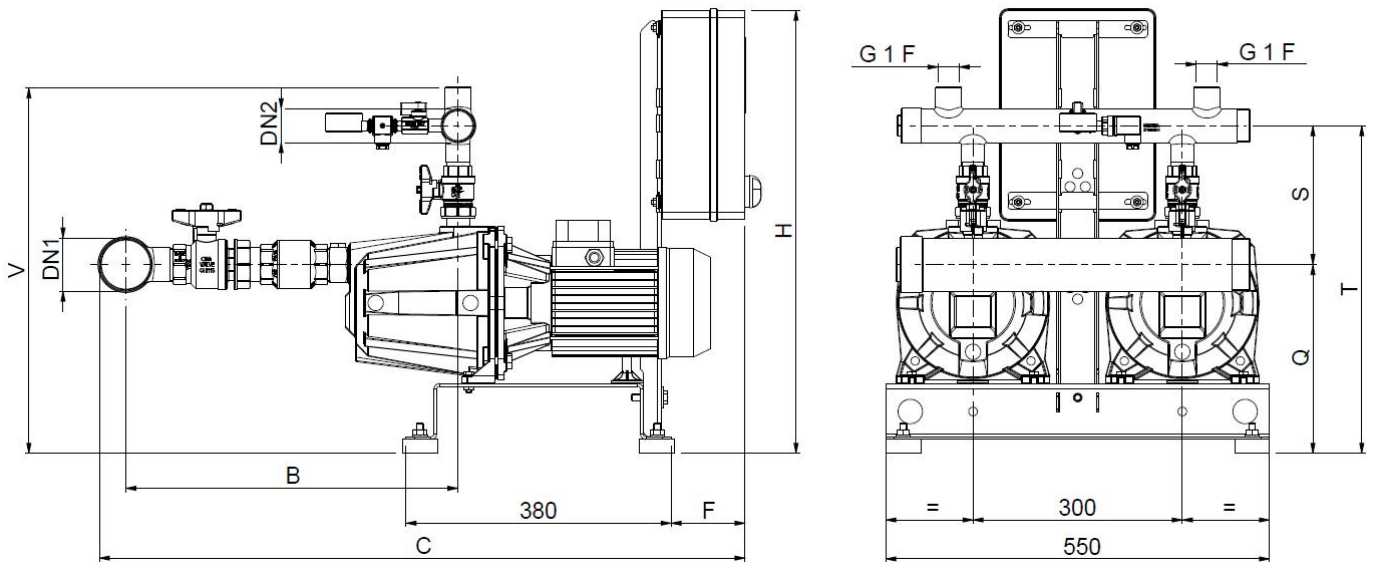

Dimensions in		mm						
1	B	475						
2	C	925						
3	DN1	G2 1/2						
4	DN2	G1 1/2						
5	F	105						
6	H	635						
7	Q	270						
8	S	200						
9	T	470						
10	V	525						
11	Weight kg	96						
12								
13								
14								
15								

(1/2) Construction

Booster set name
2GP AGA 3.00

Customer	Date 09.06.2024	Company
Contact	Item no.	Issued by
Phone	Project	Phone
E-mail	Project ID	E-mail

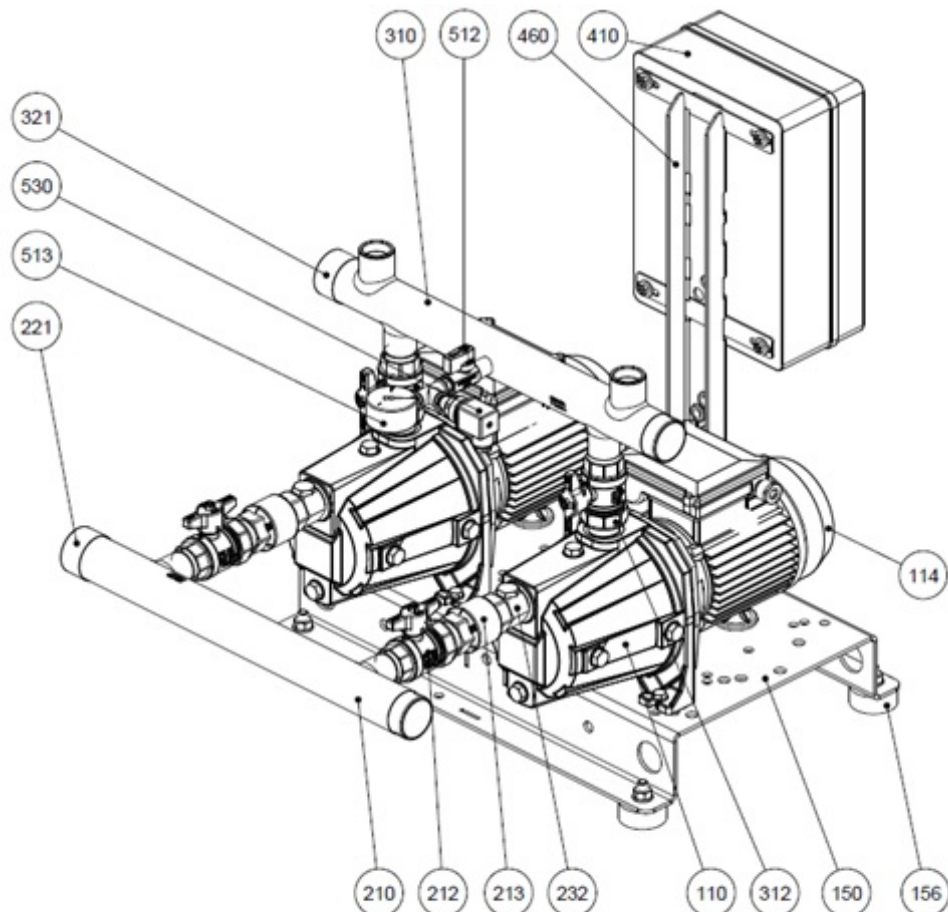

N°	PART NAME	MATERIAL	Quantity
110	Principal pump	-	2
114	Electric motor	-	2
150	Baseplate	Galvanized steel	1
156	Baseplate foot	SBR	4
210	Suction manifold	AISI 304	1
212	Union ball valve	Brass / P.T.F.E.	2
213	Check valve	Brass / NBR	2
221	Threaded female cap	AISI 304	1
232	Nipple for air feeders	Yellow brass	2
310	Discharge manifold	AISI 304	1
312	Union ball valve	Brass / P.T.F.E.	2
321	Threaded female cap	AISI 304	1
410	Control panel	-	1
460	Control panel frame	Galvanized steel	1
512	Ball valve	Brass / P.T.F.E.	1
513	Pressure gauge	Copper alloy / plastic	1
530	Pressure transmitter	-	1

(2/2) Construction

Booster set name
2GP AGA 3.00

Customer	Date 09.06.2024	Company
Contact	Item no.	Issued by
Phone	Project	Phone
E-mail	Project ID	E-mail

MECHANICAL SEAL

UP TO 0.75 kW

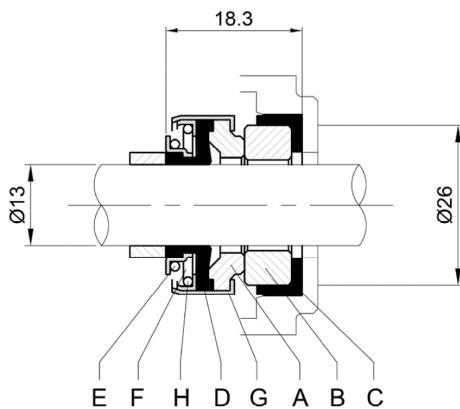

REF	PART NAME	MATERIAL
A	Rotary seal ring	Carbon graphite
B	Stationary seal ring	Ceramic
C	Gasket	NBR
D	Bellows	NBR
E	O-Ring	AISI 304
F	Self-driving spring	AISI 304
G	Frame	AISI 304
H	Retainer ring	AISI 304

1.1 kW AND ABOVE

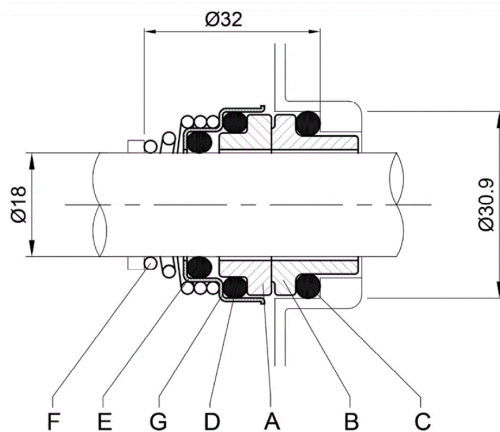

REF	PART NAME	MATERIAL
A	Rotary seal ring	Ceramic
B	Stationary seal ring	Carbon graphite
C	O-Ring	NBR
D	O-Ring	NBR
E	O-Ring	NBR
F	Self-driving spring	AISI 316
G	Frame	AISI 304

BEARINGS

Type pumps		Ball Bearing	
Single Phase	Three Phase	Pump side	Fan side
AGA 0.60 M	AGA 0.60 T	6202 2RSH	6202 2RSH
AGA 0.75 M	AGA 0.75 T	6202 2RSH	6202 2RSH
AGA 1.00 M	AGA 1.00 T	6202-ZZ C3	6202-ZZ C3
AGA 1.50 M	AGA 1.50 T	6204-ZZ C3	6203-ZZ C3
AGA 2.00 M	AGA 2.00 T	6204-ZZ C3	6203-ZZ C3
-	AGA 3.00 T	6204-ZZ C3	6203-ZZ C3
AGC 1.50 M	AGC 1.50 T	6204-ZZ C3	6203-ZZ C3
AGC 2.00 M	AGC 2.00 T	6204-ZZ C3	6203-ZZ C3
-	AGC 3.00 T	6204-ZZ C3	6203-ZZ C3