

Technical Data

Pump Name

3LSF 65-250/37

Customer	Date	10.06.2024	Company
Contact	Item no.		Issued by
Phone	Project		Phone
E-mail	Project ID		E-mail

Requested data

1	Pump type	CENTRIFUGAL PUMPS	Fluid	Water
2	Number of pumps / Reserve	1 / 0	Liquid temperature	°C
3	Flow	m³/h	Kin. viscosity	cSt
4	Head	m	Vapour pressure	kPa
5	Geodetic head	m	PH value	
6	Inlet pressure (pin)	kPa	Density	kg/m³
7	Available system NPSH		Solids	Weight %
8	Ambient temperature	°C		

Pump

9	Pump Name	3LSF 65-250/37	Frequency	Hz	50	
10	Design	CENTRIFUGAL PUMPS	Installation type		STANDARD	
11	Manufacturer	EBARA	Impeller Diameter	Max.	mm	
12	Speed	rpm		2900	Designed	mm
13	No. of Stage	1		Min.	mm	250
14	Connection	Suction side	DIN 2532	Flow	Operating	m³/h
15	Connection	Discharge side	DIN 2532		Max-	m³/h
16	Max Working Pressure	kPa	1000		Min-	m³/h
17	Shut-off head	kPa	871.36	Head	Operating	m
18	Total weight	kg	See the table of "Dimensions".		- (Qmax.)	m
19	Shaft power	kW			- (Qmin.)	m
20				Max. Shaft Power at max. impeller	kW	36.82
21	Required pump NPSH	m		Efficiency	%	

Materials

22	Impeller	AISI 316		
23	Casing	AISI 316		
24	Shaft	Duplex stainless steel		
25				
26				
27				

Motor

28	Manufacturer	without motor	Insulation class	
29	Type	without motor 3	Phases	
30	Specific design	without motor / 50 Hz / Pole pairs 1	Frame size	
31	Rated power	kW	Weight	kg
32	Number of poles	2	Electric voltage	V
33	Speed	rpm	Electric current	A
34	Degree of protection			
35				

Remarks

Performance Curve

Pump Name

3LSF 65-250/37

Customer	Date	10.06.2024	Company
Contact	Item no.		Issued by
Phone	Project		Phone
E-mail	Project ID		E-mail

Requested data

1	Flow	m³/h	
2	Head	m	
3	Geodetic head	m	

Pump

Operating flow	m³/h		Frequency	Hz	50
Operating head	m		Number of poles		2
Impeller diameter designed	mm	250	Speed	rpm	2900

Test standard: ISO 9906:2012 - Grade3B

Water; 20°C; 998.3kg/m³; 1cSt

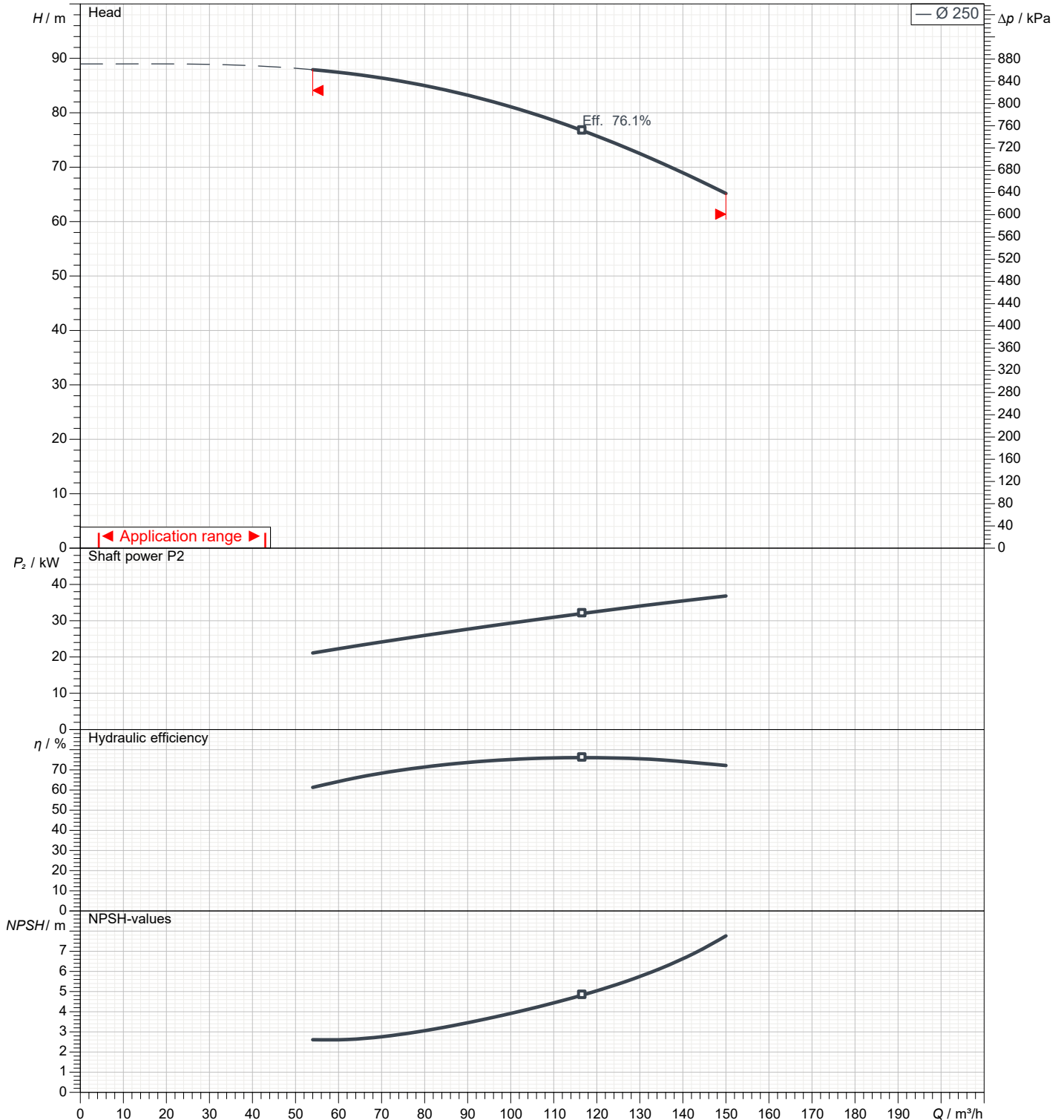

Dimensions

Pump Name 3LSF 65-250/37

Customer	Date 10.06.2024	Company
Contact	Item no.	Issued by
Phone	Project	Phone
E-mail	Project ID	E-mail

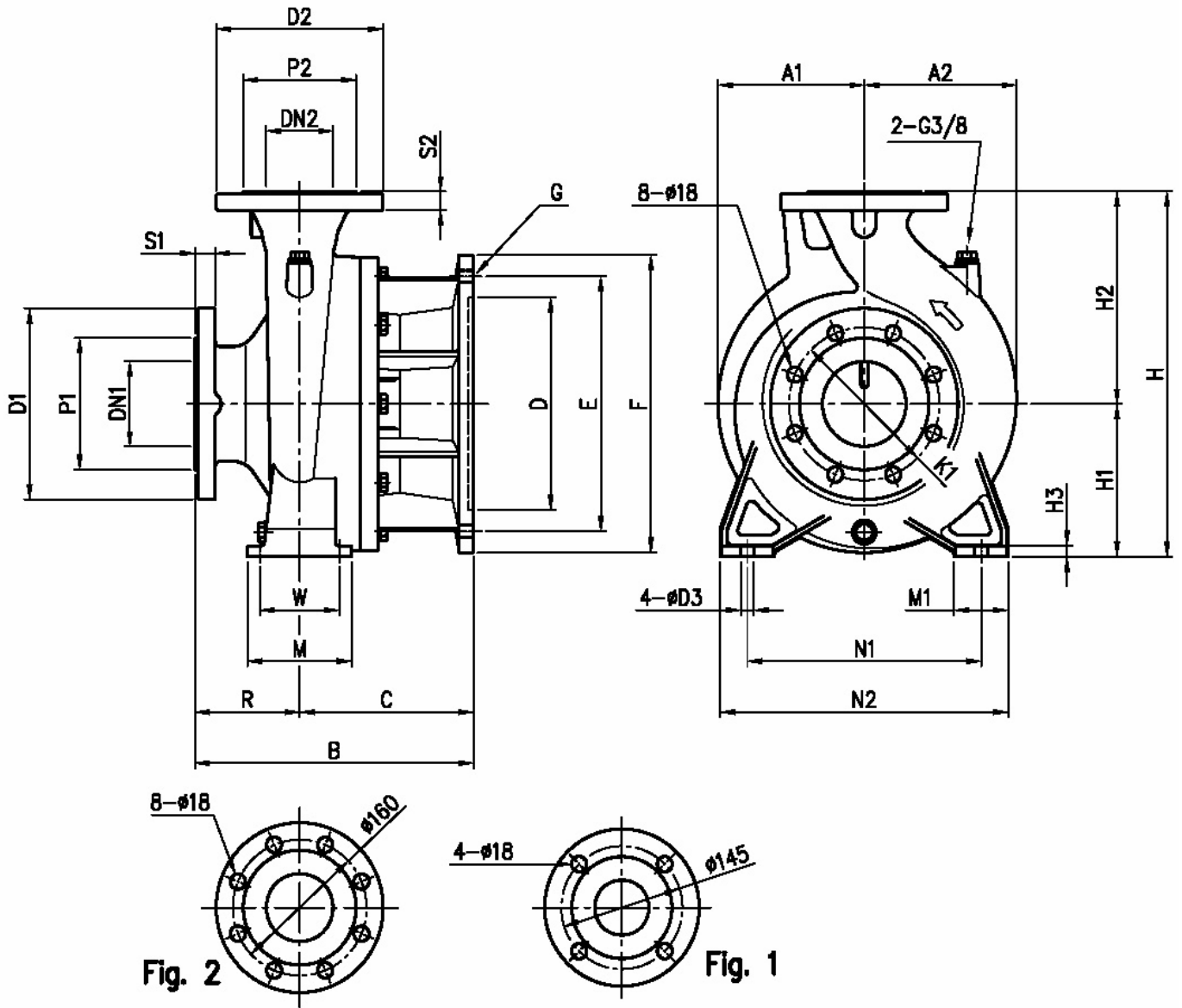

Dimensions in		mm					
1	A1	200	Fig	1			
2	A2	200	G	4-M16			
3	B	308	H	450			
4	C	208	H1	200			
5	D	300	H2	250			
6	D3	19	H3	15			
7	Dia D1	200	M	160			
8	Dia D2	185	M1	80			
9	Dia DN1	80	N1	280			
10	Dia DN2	65	N2	360			
11	Dia K1	160	R	100			
12	Dia P1	135	S1	22			
13	Dia P2	120	S2	20			
14	E	350	W	120			
15	F	400	Weight PUMP	71 kg			

(1/3)

Construction

Pump Name 3LSF 65-250/37

Customer	Date 10.06.2024	Company
Contact	Item no.	Issued by
Phone	Project	Phone
E-mail	Project ID	E-mail

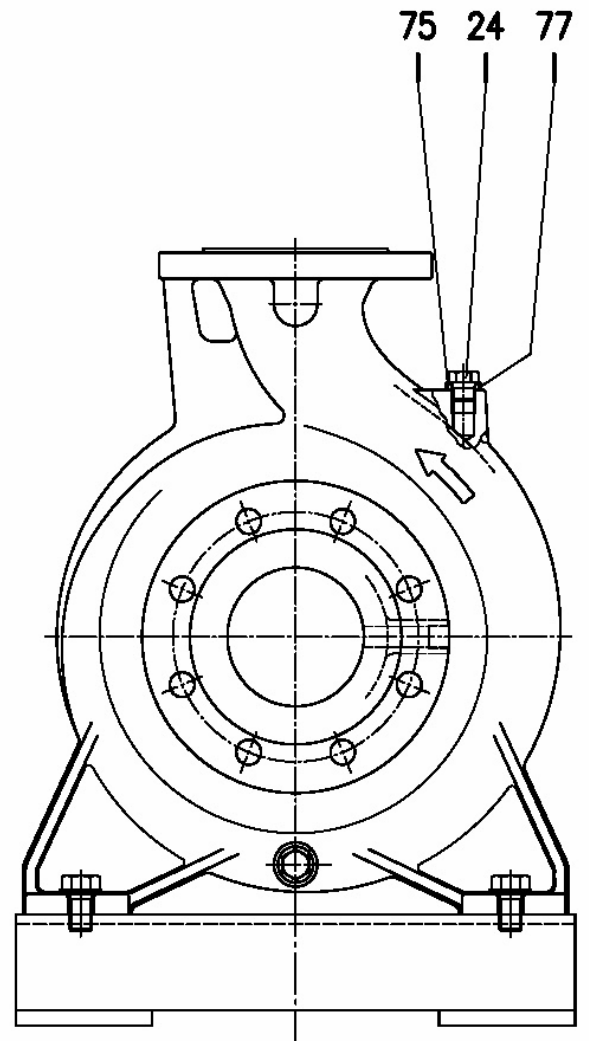
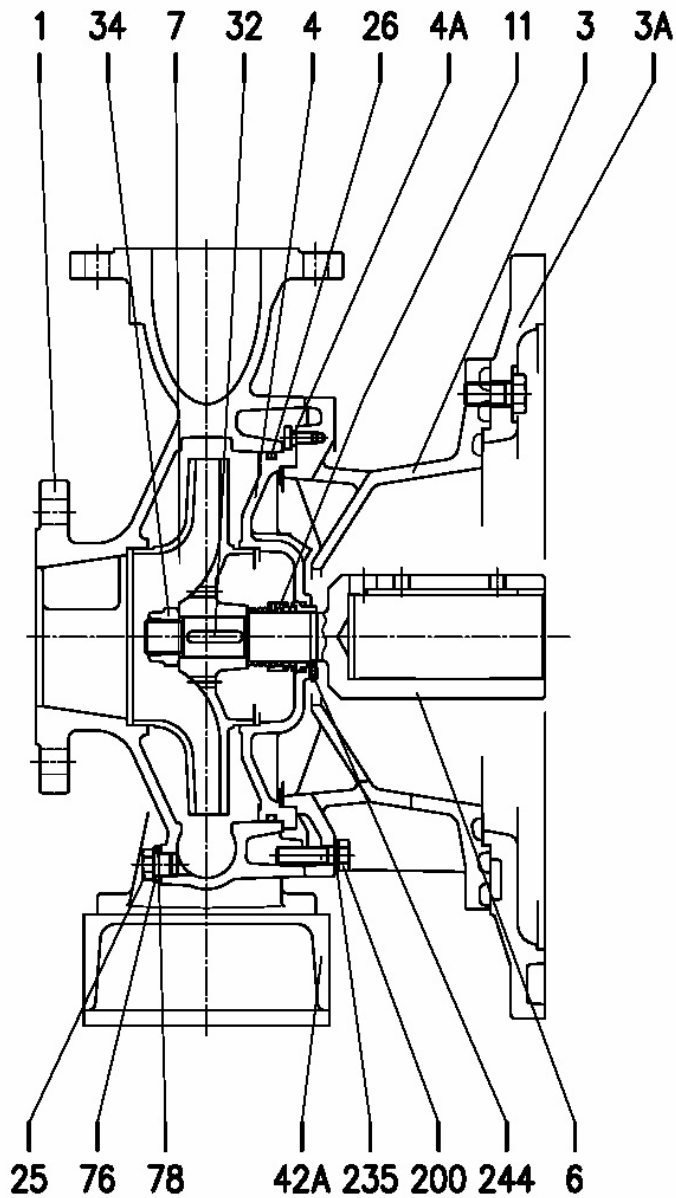

(2/3)

Construction

Pump Name 3LSF 65-250/37

Customer	Date 10.06.2024	Company
Contact	Item no.	Issued by
Phone	Project	Phone
E-mail	Project ID	E-mail

N°	PART NAME	MATERIAL	DIMENSIONS	STANDARD	Q.TY	
1	Casing	EN 1.4401 (AISI 316)			1	
3	Motor bracket	Cast iron EN-GJL-200-EN 1561			1	
3A	Adapter ring	Cast iron EN-GJL-200-EN 1561			[1]	
4	Casing cover	EN 1.4401 (AISI 316)			1	
4A	Screw for casing cover	EN 1.4301(AISI 304)			2	
6	Coupling	65-250 d=24 mm	EN 1.4462 (Duplex stainless steel)		1	
		80-200 d=24 mm	EN 1.4404 (AISI 316L) for 22 kW			
		80-250 d=29 mm	EN 1.4462 (Duplex stainless steel) for 30-37 kW			
7	Impeller	EN 1.4401 (AISI 316)			1	
11	Mechanical seal [4]	SiC/SiC/FPM			1	
24	Plug	EN 1.4404 (AISI 316L)	G3/8	EPE DRAWING	1	
25	Plug	EN 1.4404 (AISI 316L)	G3/8	EPE DRAWING	1	
26	"O" ring	FPM [5]	253.36x5.34	OR 6995	1	
32	Key	65-250 d=24 mm	EN 1.4401 (AISI 316)	8 x7x 30	UNI 6604	1
		80-200 d=29 mm		8x7x40		1
		80-250 d=29 mm				1
34	impeller nut	65-250 d=24 mm	EN 1.4404 (AISI 316L)	M20x1.5	UNI 7474	1
		80-200 d=24 mm				1
		80-250 d=29 mm		M24x2		1
042A	Foot for pump	Aluminium/zincked steel (only for 80-250/55)			[2]	
75	Washer (plug)	EN 1.4404 (AISI 316L)			1	
76	Washer (plug)				1	
77	O-ring (plug)	FPM			1	
78	O-ring (plug)	EPDM (E version)			1	
200	Screw	Stainless steel A2-70 class ISO 3506/1	M 12x45	UNI 5739	10	
235	Washer	EN 1.4301(AISI 304)	13	UNI 8842	10	
244	Pin [3]	EN 1.4301(AISI 304)	4x12		1	

[1] Only for 65-250/37, 80-200/37, 80-250/37, 80-250/45 and 80-250/55

[2] Q.TY=2 for 80-200/30 , 80-200/37 , 80-250/45
Q.TY=1 for 80-250/55

[3] Not for H and E version.

[4] Special version: see **CONSTRUCTION 3**

[5] FPM for H-HW-HSW version

EPDM for E version 65-250 and 80-200: Q1Q1EGG, Q1U3EGG, U3CEGG, Q1AEGG EPDM
for ES only for 80-250 version

(3/3)

Construction

Pump Name 3LSF 65-250/37

Customer	Date 10.06.2024	Company
Contact	Item no.	Issued by
Phone	Project	Phone
E-mail	Project ID	E-mail

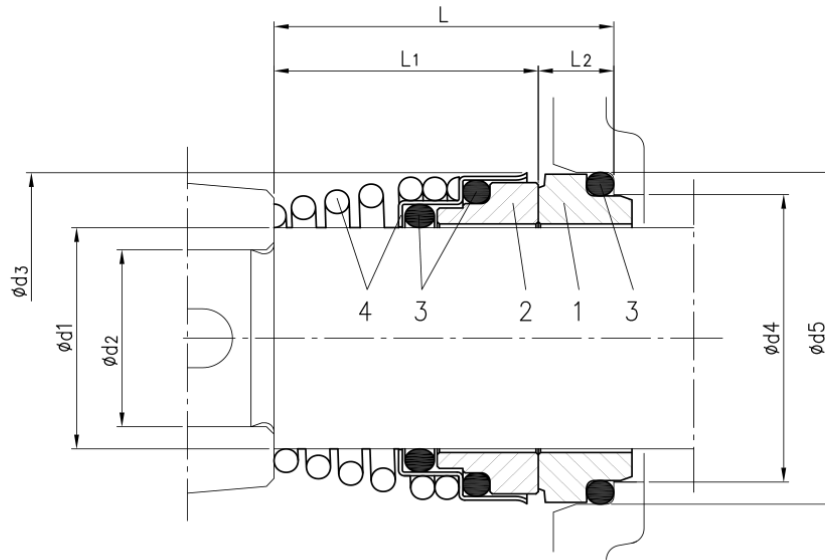

Version	Pump type	Dimensions									Material			
		d1	d2	d3	d4	d5	L	L1	L2	1 Stationary seal ring	2 Rotary seal ring	3 Rubber	4 Frame + spring	
L ø30	65-160/15 65-200/250 80-160/200	30	24	44	39	45	42.5	31	11.5	SiC	SiC	FPM	EN 1.4571 (AISI 316Ti)	
L ø35	80-250	35	29	49	44	50	42.5	31	11.5	SiC	SiC	FPM	EN 1.4571 (AISI 316Ti)	