

# Technical Data

Pump Name

3LS 65-250/37

Customer	Date	10.06.2024	Company
Contact	Item no.		Issued by
Phone	Project		Phone
E-mail	Project ID		E-mail

## Requested data

1	Pump type	CENTRIFUGAL PUMPS	Fluid	Water
2	Number of pumps / Reserve	1 / 0	Liquid temperature	°C 20
3	Flow m³/h		Kin. viscosity	cSt 1.005
4	Head m		Vapour pressure	kPa 2.34
5	Geodetic head m		PH value	
6	Inlet pressure (pin) kPa	0	Density	kg/m³ 998.3
7	Available system NPSH		Solids	Weight % 0
8	Ambient temperature °C	20		

## Pump

9	Pump Name	3LS 65-250/37	Frequency	Hz 50
10	Design	CENTRIFUGAL PUMPS	Installation type	STANDARD
11	Manufacturer	EBARA	Impeller Diameter	Max. mm 250
12	Speed rpm	2900		Designed mm 250
13	No. of Stage	1		Min. mm 250
14	Connection Suction side	DIN 2532	Flow	Operating m³/h
15	Connection Discharge side	DIN 2532		Max- m³/h 150
16	Max Working Pressure kPa	1000		Min- m³/h 54
17	Shut-off head kPa	871.56	Head	Operating m
18	Total weight kg	See the table of "Dimensions".		- (Qmax.) m 65.1
19	Shaft power kW			- (Qmin.) m 88.1
20			Max. Shaft Power at max. impeller	kW 36.92
21	Required pump NPSH m		Efficiency	%

## Materials

22	Impeller	CF8M	
23	Casing	CF8M	
24	Shaft	AISI 316L	
25			
26			
27			

## Motor

28	Manufacturer	LAFERT	Insulation class	F
29	Type	TEFC_3LS65-250/37_400_Three Phase	Phases	3~
30	Specific design	IE3 / 50 Hz / Pole pairs 1	Frame size	200
31	Rated power kW	37	Weight	kg 242
32	Number of poles	2	Electric voltage	V 400
33	Speed rpm	2900	Electric current	A 62.5
34	Degree of protection			
35				

## Remarks

# Performance Curve

Pump Name

3LS 65-250/37

Customer	Date	10.06.2024	Company
Contact	Item no.		Issued by
Phone	Project		Phone
E-mail	Project ID		E-mail

## Requested data

1	Flow	m³/h	
2	Head	m	
3	Geodetic head	m	

## Pump

Operating flow	m³/h		Frequency	Hz	50
Operating head	m		Number of poles		2
Impeller diameter designed	mm	250	Speed	rpm	2900

Test standard: ISO 9906:2012 - Grade3B

Water; 20°C; 998.3kg/m³; 1cSt

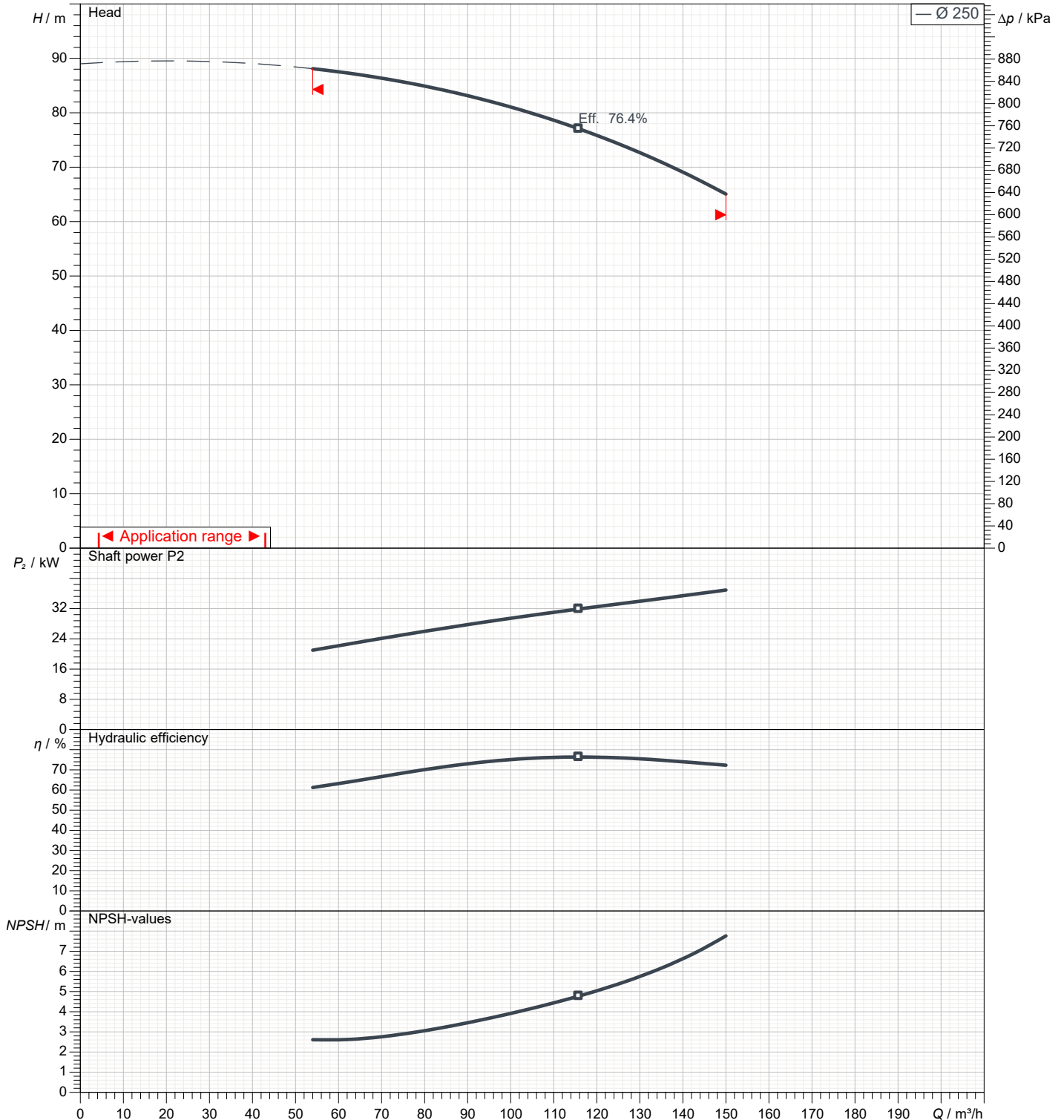

# Dimensions

Pump Name 3LS 65-250/37

Customer	Date 10.06.2024	Company
Contact	Item no.	Issued by
Phone	Project	Phone
E-mail	Project ID	E-mail

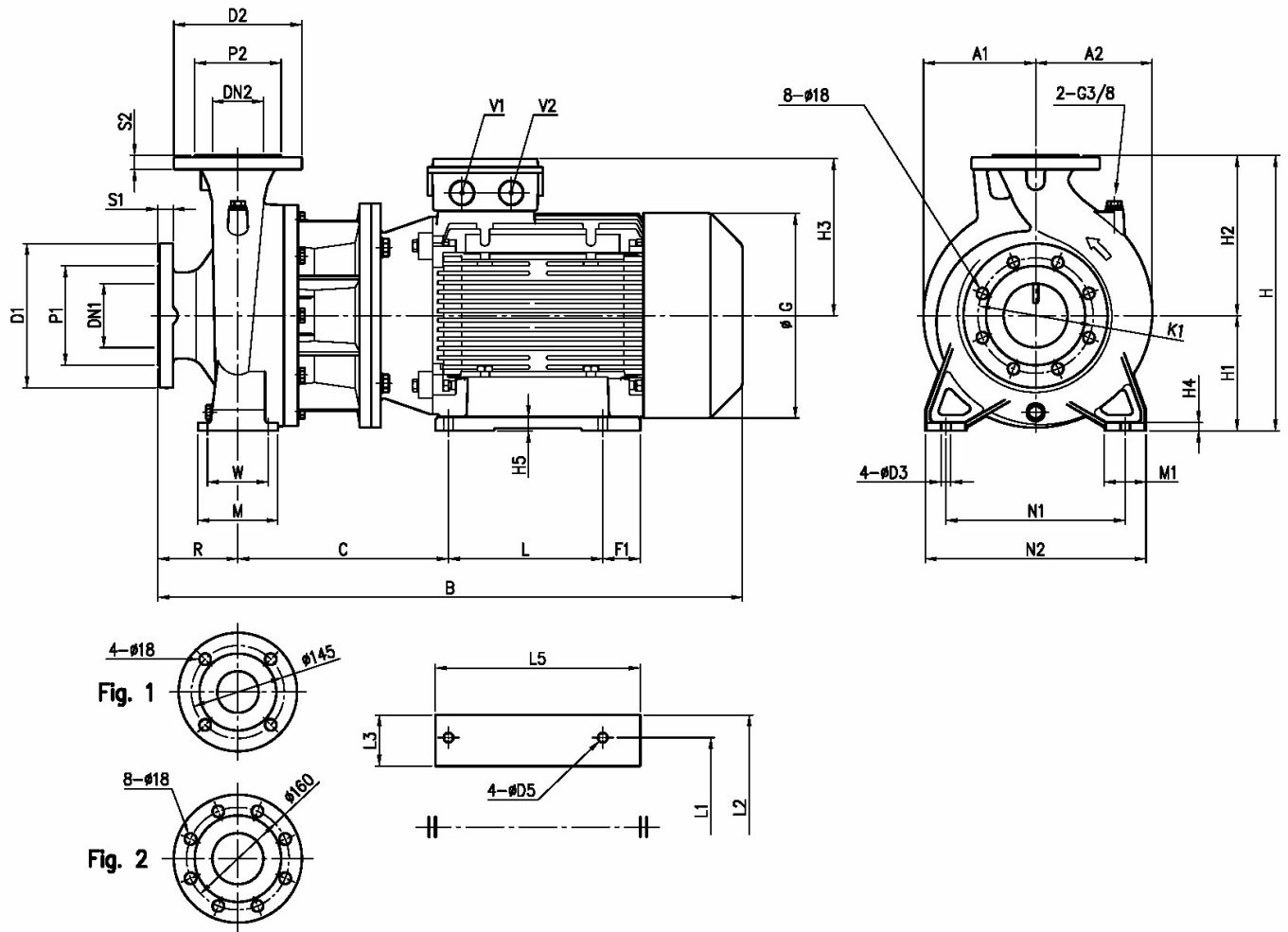

Dimensions in		mm						
1	A1	200	H	450	R	100		
2	A2	200	H1	200	S1	22		
3	B	966	H2	250	S2	20		
4	C	341	H3	300	V1	[M40x1].5		
5	D3	19	H4	15	V2	[M40x1].5		
6	D5	17	H5	25	W	120		
7	Dia D1	200	L	305	Weight P&M	320 kg		
8	Dia D2	185	L1	318				
9	Dia DN1	80	L2	388				
10	Dia DN2	[65 Fig].1	L3	80				
11	Dia K1	160	L5	358				
12	Dia P1	135	M	160				
13	Dia P2	120	M1	80				
14	F1	21.5	N1	280				
15	G	399	N2	360				

(1/3)

# Construction

Pump Name 3LS 65-250/37

Customer	Date 10.06.2024	Company
Contact	Item no.	Issued by
Phone	Project	Phone
E-mail	Project ID	E-mail

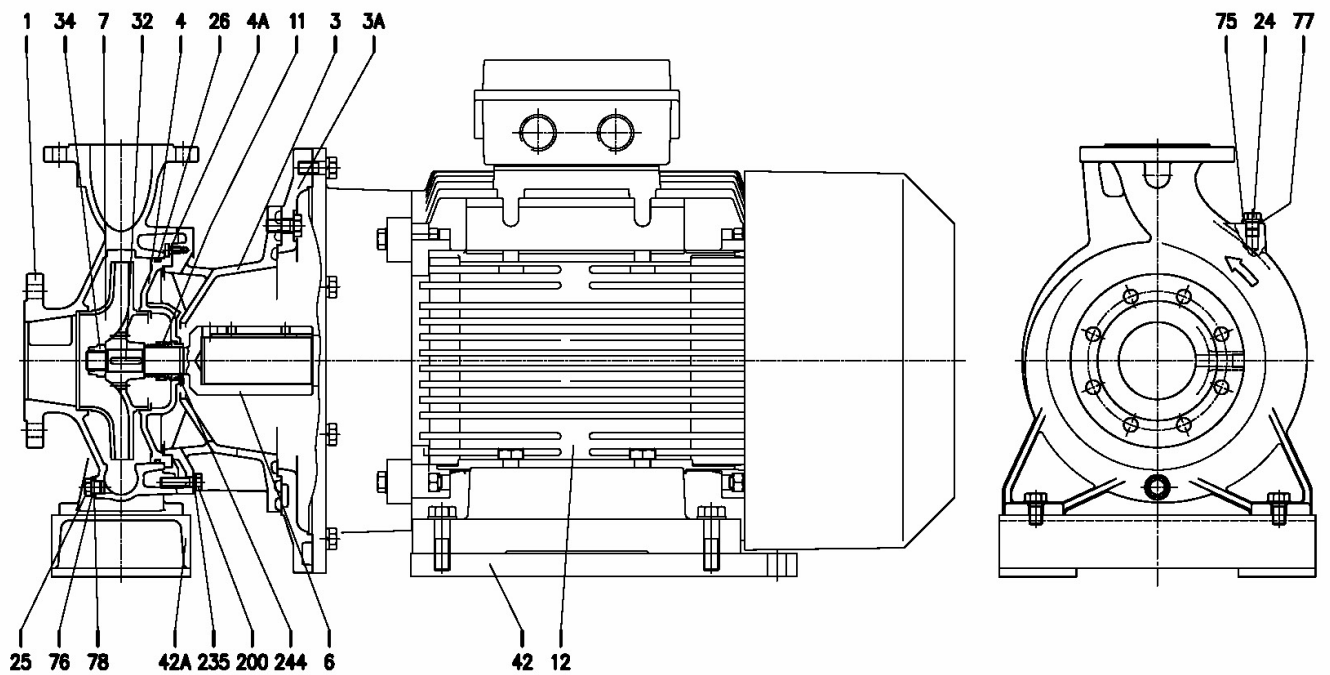

**(2/3)****Construction****Pump Name 3LS 65-250/37**

Customer	Date	10.06.2024	Company
Contact	Item no.		Issued by
Phone	Project		Phone
E-mail	Project ID		E-mail

N°	PART NAME		MATERIAL	DIMENSIONS	STANDARD	Q.TY
1	Casing		CF8M-EN 1.4408 (AISI 316)			1
3	Motor bracket		Cast iron EN-GJL-200-EN 1561			1
3 A	Adapter ring		Cast iron EN-GJL-200-EN 1561			[1]
4	Casing cover		EN 1.4401 (AISI 316)			1
4 A	Screw for casing cover		EN 1.4301(AISI 304)			2
6	Coupling	65-250 d=24 mm	EN 1.4404 (AISI 316L) for 22 kW			1
			EN 1.4462 (Duplex stainless steel) for 30-37 kW			1
		80-200 d=24 mm	EN 1.4404 (AISI 316L) for 22 kW			1
			EN 1.4462 (Duplex stainless steel) for 30-37 kW			1
		80-250 d=29 mm	EN 1.4462 (Duplex stainless steel)			1
7	Impeller		CF8M-EN 1.4408 (AISI 316)			1
11	Mechanical seal		SiC/SiC/FPM	[6]		1
12	Motor		-			1
24	Plug		EN 1.4404 (AISI 316L)	G3/8	EPE DRAWING	1
25	Plug		EN 1.4404 (AISI 316L)	G3/8	EPE DRAWING	1
26	"O" ring		FPM [5]	253.36x5.34	OR 6995	1
32	Key	65-250 d=24 mm	EN 1.4401 (AISI 316)	8x7x30	UNI 6604	1
		80-200 d=24 mm		8x7x40		1
		80-250 d=29 mm				1
34	impeller nut	65-250 d=24 mm	EN 1.4404 (AISI 316L)	M20x1.5	UNI 7474	1
		80-200 d=24 mm				1
		85-250 d=29 mm		M24x2		1
42	Foot for motor		Aluminium		EPE DRAWING	[2]
42 A	Foot for pump		Aluminium/Galvanized steel (only for 80-250/55)			[3]
75	Washer (plug)		EN 1.4404 (AISI 316L)			1
76	Washer (plug)					1
77	O-ring (plug)					1
78	O-ring (plug)			FPM [5]		
200	Screw		Stainless steel A2-70 class ISO 3506/1	M 12x45	UNI 5739	10
235	Washer		C70	13	UNI 1751	10
244	Pin [4]		EN 1.4301(AISI 304)	4x12		1

[1] Only for 65-250/37 , 80-200/37 , 80-250/37 – 80-250/45 and 80-250/55

[2] Quantity =2 for 80-250/55

[3] Quantity =2 for 80-200/30 , 80-200/37 , 80-250/45

Quantity =1 for 80-250/55

[4] Not for H and E version

[5] FPM for H, HW, HSW version

EPDM for E version and Special seals Q1Q1EGG, Q1U3EGG, U3CEGG, Q1AEGG (Not for model 80-250)

EPDM for ES version only model 80-250

[6] Special version: see COSTRUCTION 3

(3/3)

# Construction

Pump Name 3LS 65-250/37

Customer	Date 10.06.2024	Company
Contact	Item no.	Issued by
Phone	Project	Phone
E-mail	Project ID	E-mail

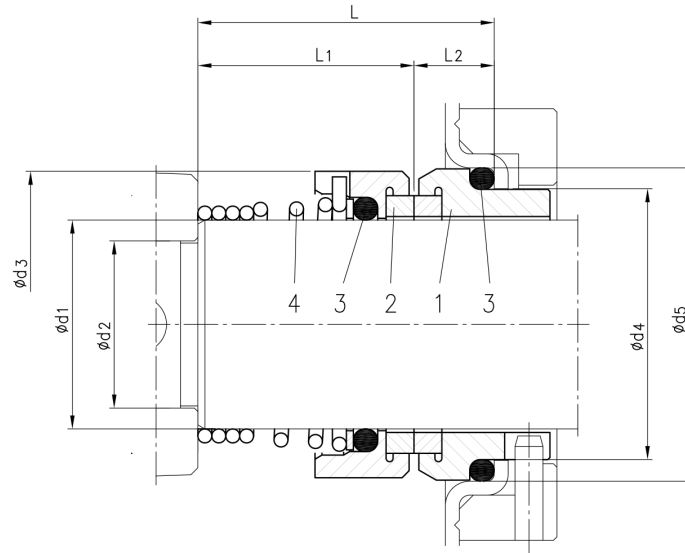

Version	Pump type	Dimensions								Material			
		d1	d2	d3	d4	d5	L	L1	L2	1 Stationary seal ring	2 Rotary seal ring	3 Rubber	4 Frame + spring
L $\phi 30$	65-160/15 65-200/250 80-160/200	30	24	44	39	45	42.5	31	11.5	SiC	SiC	FPM	EN 1.4571 (AISI 316Ti)
L $\phi 35$	80-250	35	29	49	44	50	42.5	31	11.5				