

# Technical data

Pump name 65X50 FSS4JC 5 2.2 H

|          |  |           |
|----------|--|-----------|
| Customer | Date 2024-06-14                                  | Company   |
| Contact  | Item no.   | Issued by |
| Phone    | Project  | Phone     |
| E-mail   | Project ID Proiect redenumit 2024-06-14 18:50:31 | E-mail    |

## Requested data

|   |                           |                         |                                   |        |
|---|---------------------------|-------------------------|-----------------------------------|--------|
| 1 | Pump type                 | End Suction Volute Pump | Fluid                             | Water  |
| 2 | Number of pumps / Reserve | 1 / 0                   | Liquid temperature °C             | 20     |
| 3 | Flow m <sup>3</sup> /h    |                         | Kin. viscosity mm <sup>2</sup> /s | 1.005  |
| 4 | Head m                    |                         | Vapour pressure bar               | 0.0234 |
| 5 | Geodetic head m           |                         | PH value                          |        |
| 6 | Inlet pressure (pin) bar  | 0                       | Density kg/m <sup>3</sup>         | 998.3  |
| 7 | Available system NPSH     |                         | Solids Weight %                   | 0      |
| 8 | Ambient temperature °C    | 20                      |                                   |        |

## Pump

|    |                           |                                |                                      |                             |
|----|---------------------------|--------------------------------|--------------------------------------|-----------------------------|
| 9  | Pump name                 | 65X50 FSS4JC 5 2.2 H           | Frequency Hz                         | 50                          |
| 10 | Design                    | End Suction Volute Pump        |                                      |                             |
| 11 | Manufacturer              | EBARA                          | Impeller Diameter                    | Max. mm 260                 |
| 12 | Speed rpm                 | 1450                           |                                      | Designed mm 260             |
| 13 | No. of Stage              | 1                              |                                      | Min. mm 222                 |
| 14 | Connection Suction side   | JIS 16K                        | Flow                                 | Operating m <sup>3</sup> /h |
| 15 | Connection Discharge side | JIS 16K                        |                                      | Max- m <sup>3</sup> /h 30.6 |
| 16 | Max Working Pressure bar  | 16                             |                                      | Min- m <sup>3</sup> /h 5.98 |
| 17 | Shut-off head bar         | 2.35                           | Head                                 | Operating m                 |
| 18 | Total weight kg           | See the table of "Dimensions". |                                      | - (Qmax.) m 12.2            |
| 19 | Shaft power kW            |                                |                                      | - (Qmin.) m 23.6            |
| 20 |                           |                                | Max. Shaft Power at max. impeller kW | 2.18                        |
| 21 | Required pump NPSH m      |                                | Efficiency %                         |                             |

## Materials

|    |                 |            |                 |        |
|----|-----------------|------------|-----------------|--------|
| 22 | Casing          | SCS13      | M.S.mating ring | SIC    |
| 23 | Impeller        | SCS13      | M.S.seal ring   | Carbon |
| 24 | Shaft           | SUS316L    |                 |        |
| 25 | Case wear ring  | SUS316     |                 |        |
| 26 | Mechanical seal | SIC/Carbon |                 |        |
| 27 | Ball bearing    | Grease     |                 |        |

## Motor

|    |                      |                             |                    |           |
|----|----------------------|-----------------------------|--------------------|-----------|
| 28 | Manufacturer         | SIEMENS                     | Insulation class   | F         |
| 29 | Type                 | 100L_B3_2.2_3_380           | Phases             | 3~        |
| 30 | Specific design      | TEFC / 50 Hz / Pole pairs 2 | Frame size         | 100 L_2.2 |
| 31 | Rated power kW       | 2.2                         | Weight kg          | 40        |
| 32 | Number of poles      | 4                           | Electric voltage V | 380       |
| 33 | Speed rpm            | 1440                        | Electric current A | 4.7       |
| 34 | Degree of protection | IP55                        |                    |           |
| 35 |                      |                             |                    |           |

## Remarks

# Performance Curve

Pump Name

65X50 FSS4JC 5 2.2 H

|          |            |                                       |           |
|----------|------------|---------------------------------------|-----------|
| Customer | Date       | 2024-06-14                            | Company   |
| Contact  | Item no.   |                                       | Issued by |
| Phone    | Project    |                                       | Phone     |
| E-mail   | Project ID | Proiect redenumit 2024-06-14 18:50:31 | E-mail    |

**Requested data**

|   |               |      |  |
|---|---------------|------|--|
| 1 | Flow          | m³/h |  |
| 2 | Head          | m    |  |
| 3 | Geodetic head | m    |  |

**Pump**

|                            |      |     |                 |     |      |
|----------------------------|------|-----|-----------------|-----|------|
| Operating flow             | m³/h |     | Frequency       | Hz  | 50   |
| Operating head             | m    |     | Number of poles |     | 4    |
| Impeller diameter designed | mm   | 260 | Speed           | rpm | 1450 |

Test standard: ISO 9906:2012 - Grade3B

Water; 20°C; 998.3kg/m³; 1mm²/s

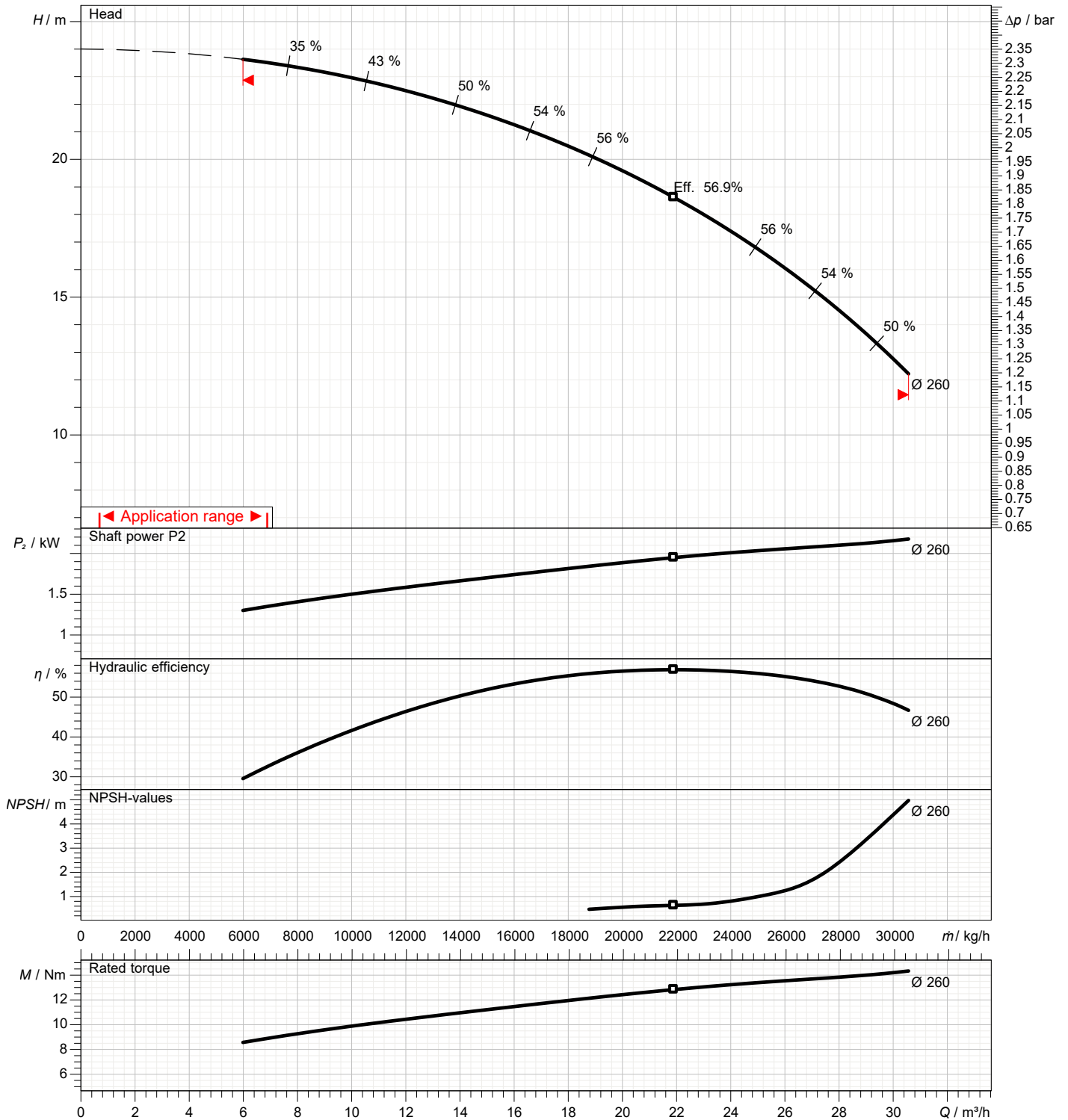

# Dimensions

Pump name 65X50 FSS4JC 5 2.2 H

|          |   |           |
|----------|---|-----------|
| Customer | Date 2024-06-14                                 | Company   |
| Contact  | Item no.  | Issued by |
| Phone    | Project   | Phone     |
| E-mail   | Project ID Project redenumit 2024-06-14 18:50:3 | E-mail    |

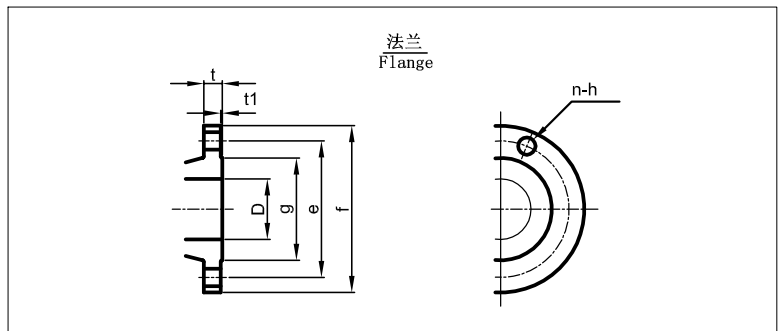
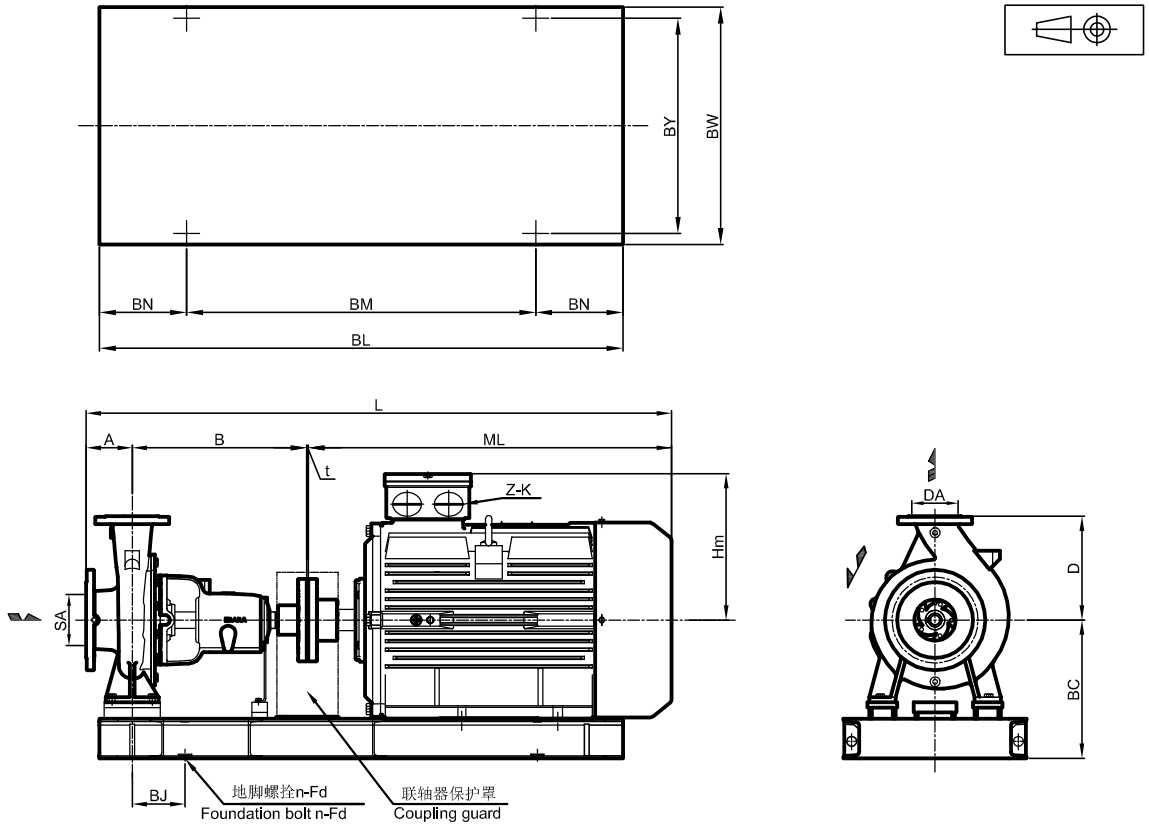

Motor manufacturer : SIEMENS

Total weight : 117 kg

| Pump dimensions |      |     |           | mm    |        | Suction side |        | mm |  | Discharge side |  | mm |  |
|-----------------|------|-----|-----------|-------|--------|--------------|--------|----|--|----------------|--|----|--|
| A               | 100  | n   | 4(Num)    | D     | 65     | D            | 50     |    |  |                |  |    |  |
| B               | 360  | SA  | 65        | e     | 140    | e            | 120    |    |  |                |  |    |  |
| BC              | 260  | t   | 3         | f     | 175    | f            | 155    |    |  |                |  |    |  |
| BJ              | 42.5 | Z-K | 2-M32X1.5 | g     | 116    | g            | 96     |    |  |                |  |    |  |
| BL              | 750  |     |           | h     | 19     | h            | 19     |    |  |                |  |    |  |
| BM              | 510  |     |           | n Num | 8(Num) | n Num        | 8(Num) |    |  |                |  |    |  |
| BN              | 120  |     |           | t     | 18     | t            | 16     |    |  |                |  |    |  |
| BW              | 350  |     |           | t1    | 2      | t1           | 2      |    |  |                |  |    |  |
| BY              | 320  |     |           |       |        |              |        |    |  |                |  |    |  |
| D               | 225  |     |           |       |        |              |        |    |  |                |  |    |  |
| DA              | 50   |     |           |       |        |              |        |    |  |                |  |    |  |
| Fd              | 15   |     |           |       |        |              |        |    |  |                |  |    |  |
| Hm              | 177  |     |           |       |        |              |        |    |  |                |  |    |  |
| L               | 928  |     |           |       |        |              |        |    |  |                |  |    |  |
| ML              | 465  |     |           |       |        |              |        |    |  |                |  |    |  |

# Construction

Pump name 65X50 FSS4JC 5 2.2 H

|          |   |           |
|----------|---|-----------|
| Customer | Date 2024-06-14                                 | Company   |
| Contact  | Item no.  | Issued by |
| Phone    | Project   | Phone     |
| E-mail   | Project ID Proiect redenumit 2024-06-14 18:50:3 | E-mail    |



|            |                               |                |                |           |              |            |                            |                |               |           |              |
|------------|-------------------------------|----------------|----------------|-----------|--------------|------------|----------------------------|----------------|---------------|-----------|--------------|
| 095        | 轴承支架 Stay                     | SS400          | Q235A          | 1         |              | 903        | 机械挡圈 Distance piece        | SUS304         | 06Cr19Ni10    | 1         |              |
| 093-3      | 甩水环 Flinger                   | NBR            | NBR            | 1         |              | 135        | 叶轮止动垫圈 Impeller Nut Washer | SUS304         | 06Cr19Ni10    | 1         |              |
| 056        | 球轴承 Ball Bearing              | —              | —              | 2         |              | 120-17     | 紧定螺钉 Set Screw             | SUS304         | 06Cr19Ni10    | 4         |              |
| 053-2      | 轴承压盖 Bearing Cover            | FC250          | HT250          | 1         |              | 120-13     | 六角头螺栓 Hex.Head Bolt        | SS400          | Q235A         | 2         |              |
| 051        | 轴承体 Bearing Housing           | FC250          | HT250          | 1         |              | 120-3      | 六角头螺栓/垫片 Hex.Head Bolt/Nut | SUS304         | 06Cr19Ni10    | 4         |              |
| 048        | 叶轮螺母 Impeller Nut             | SUS304         | 06Cr19Ni10     | 1         |              | 120-1      | 六角头螺栓/垫片 Hex.Head Bolt/Nut | SUS420J1       | 20Cr13        | 8         |              |
| 039-3      | 联轴器用键 Key For Couplings       | S50C           | 50#            | 1         |              | 120        | 双头螺栓 Stud Bolt             | SUS304         | 06Cr19Ni10    | 4         |              |
| 039-1      | 叶轮用键 Key For Impeller         | SUS304         | 06Cr19Ni10     | 1         |              | 117-1      | 密封垫 Sealing Gasket         | V6500          | V6500         | 1         |              |
| 031        | 主轴 Shaft                      | SUS316L        | 022Cr17Ni12Mo2 | 1         |              | 115-1      | O型圈 O-rings                | FPM            | FPM           | 1         |              |
| 021        | 叶轮 Impeller                   | SCS13          | 06Cr19Ni10     | 1         |              | 111        | 机械密封 Mechanical Seal       |                |               | 1 SET     |              |
| 018-1      | 泵盖 Casing Cover               | SCS13          | 06Cr19Ni10     | 1         |              | 107-2      | 密封环 Case Wear Ring         | SUS316         | 06Cr17Ni12Mo2 | 1         |              |
| 016        | 机械密封 Mechanical Sealing Gland | SUS304         | 06Cr19Ni10     | 1         |              | 107-1      | 密封环 Case Wear Ring         | SUS316         | 06Cr17Ni12Mo2 | 1         |              |
| 001        | 泵壳 Casing                     | SCS13          | 06Cr19Ni10     | 1         |              |            |                            |                |               |           |              |
| 零件号<br>No. | 零件名<br>Name of Part           | JIS            | GB             | 数量<br>No. | 备注<br>Remark | 零件号<br>No. | 零件名<br>Name of Part        | JIS            | GB            | 数量<br>No. | 备注<br>Remark |
|            |                               | 材料<br>Material |                |           |              |            |                            | 材料<br>Material |               |           |              |

注意: 上表只显示标准配置的材料, 如有其他材料要求, 请参照技术数据表。

Note: The table above shows material of standard specification.

Please refer to the Data Sheet if designated material is required.