

Technical Data

Pump Name

MMD 80-200/37 QQPFF

Customer	Date	2024-06-16	Company
Contact	Item no.		Issued by
Phone	Project		Phone
E-mail	Project ID	Proiect redenumit 2024-06-16 15:45:44	E-mail

Requested data

1	Pump type	CENTRIFUGAL PUMPS	Fluid	Water
2	Number of pumps / Reserve	1 / 0	Liquid temperature	°C 20
3	Flow m³/h		Kin. viscosity	mm²/s 1.005
4	Head m		Vapour pressure	bar 0.0234
5	Geodetic head m		PH value	
6	Inlet pressure (pin) bar	0	Density	kg/m³ 998.3
7	Available system NPSH		Solids	Weight % 0
8	Ambient temperature °C	20		

Pump

9	Pump Name	MMD 80-200/37 QQPFF	Frequency	Hz 50
10	Design	CENTRIFUGAL PUMPS	Installation type	STANDARD
11	Manufacturer	EBARA	Impeller Diameter	Max. mm 209
12	Speed rpm	2900		Designed mm 209
13	No. of Stage	1		Min. mm 209
14	Connection Suction side		Flow	Operating m³/h
15	Connection Discharge side			Max- m³/h 210
16	Max Working Pressure bar	10		Min- m³/h 50
17	Shut-off head bar	5.60	Head	Operating m
18	Total weight kg	See the table of "Dimensions".		- (Qmax.) m 42.0
19	Shaft power kW			- (Qmin.) m 56.9
20			Max. Shaft Power at max. impeller	kW 31.97
21	Required pump NPSH m		Efficiency	%

Materials

22	Impeller	EN-GJL-200	
23	Intermediate casing	EN-GJL-200	
24	Bottom casing	EN-GJL-200	
25	Shaft	Stainless steel	
26	Gasket	AF1600	
27			

Motor

28	Manufacturer	ABLE	Insulation class	F
29	Type	TEFC_MMD 80-200/37_400_Three Phase	Phases	3~
30	Specific design	IE3 / 50 Hz / Pole pairs 1	Frame size	200
31	Rated power kW	37	Weight	kg
32	Number of poles	2	Electric voltage	V 400
33	Speed rpm	2950	Electric current	A 64.9
34	Degree of protection	IP 55		
35				

Remarks

Performance Curve

Pump Name

MMD 80-200/37 QQPFF

Customer	Date	2024-06-16	Company
Contact	Item no.		Issued by
Phone	Project		Phone
E-mail	Project ID	Proiect redenumit 2024-06-16 15:45:44	E-mail

Requested data

1	Flow	m³/h	
2	Head	m	
3	Geodetic head	m	

Pump

Operating flow	m³/h		Frequency	Hz	50
Operating head	m		Number of poles		2
Impeller diameter designed	mm	209	Speed	rpm	2900

Test standard: ISO 9906:2012 - Grade3B

Water; 20°C; 998.3kg/m³; 1mm²/s

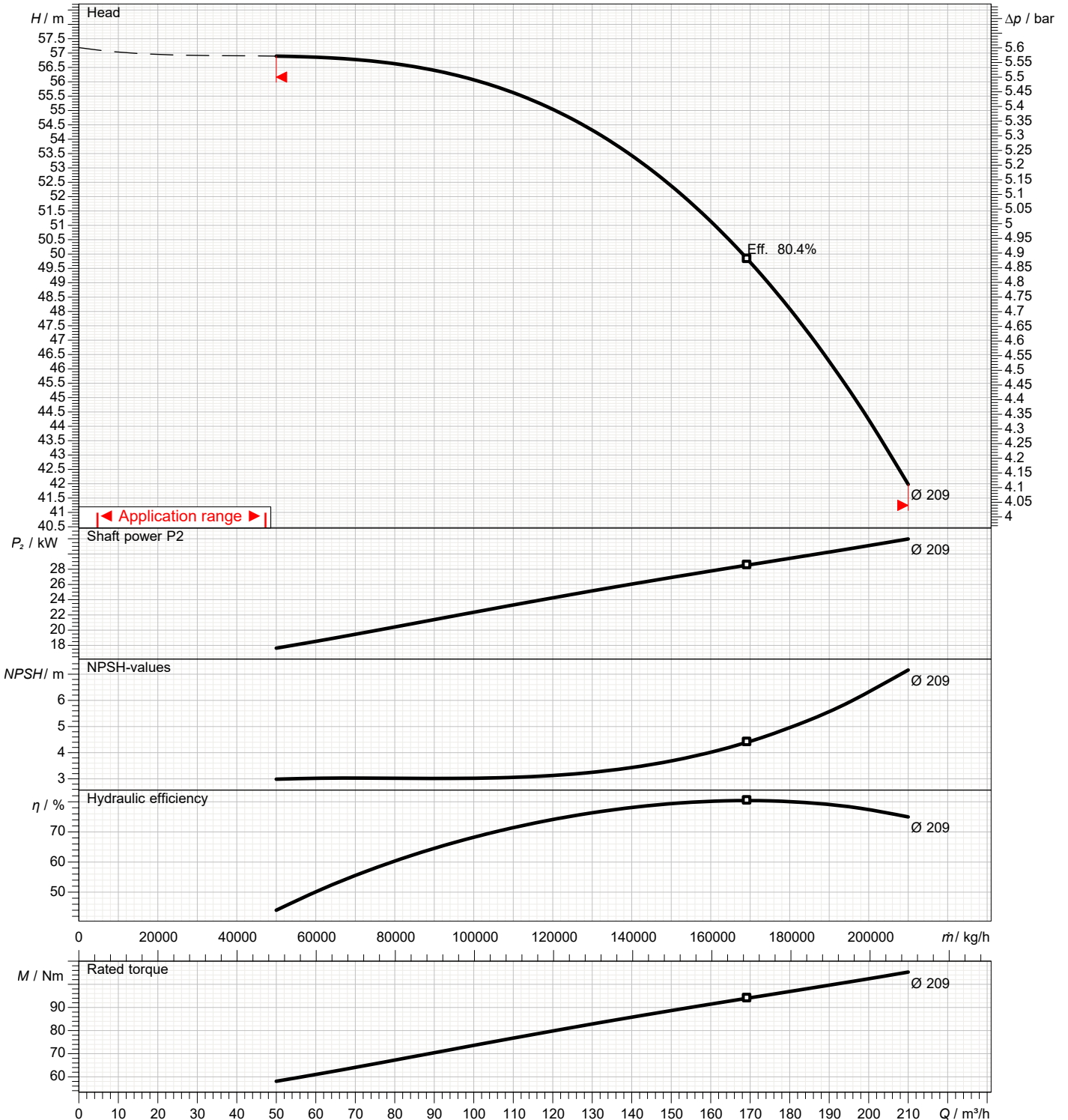

Dimensions

Pump name MMD 80-200/37 QQPFF

Customer	Date 2024-06-16	Company
Contact	Item no.	Issued by
Phone	Project	Phone
E-mail	Project ID Proiect redenumit 2024-06-16 15:45:44	E-mail

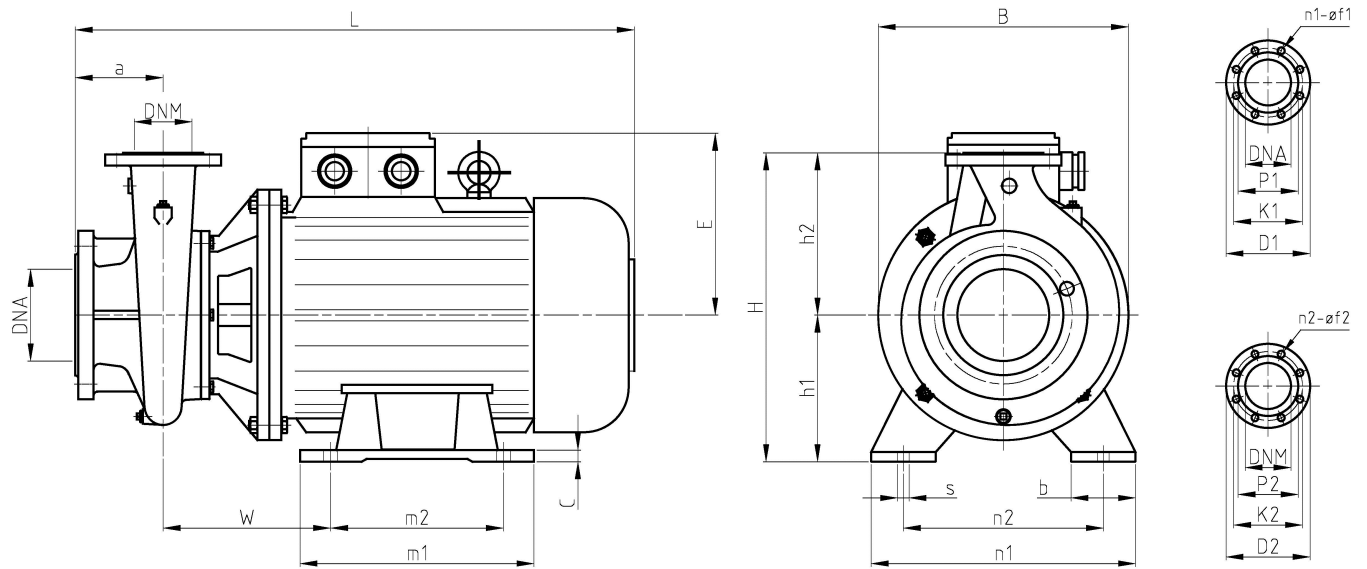

Dimensions in		mm						
1	a	125	Dia P2	138				
2	b	60	E	305				
3	B	400	H	450				
4	C	24	h1	200				
5	Dia D1	220	h2	250				
6	Dia D2	200	L	977				
7	Dia DNA	100	m1	345				
8	Dia DNM	80	m2	305				
9	Dia f1	18	n1	380				
10	Dia f2	18	n2	318				
11	Dia K1	180	s	18				
12	Dia K2	160	W	325				
13	Dia n1	8	Weight P&M	317 kg				
14	Dia n2	8						
15	Dia P1	158						

(1/2)

Construction

Pump name MMD 80-200/37 QQPFF

Customer	Date 2024-06-16	Company
Contact	Item no.	Issued by
Phone	Project	Phone
E-mail	Project ID Proiect redenumit 2024-06-16 15:45:44	E-mail

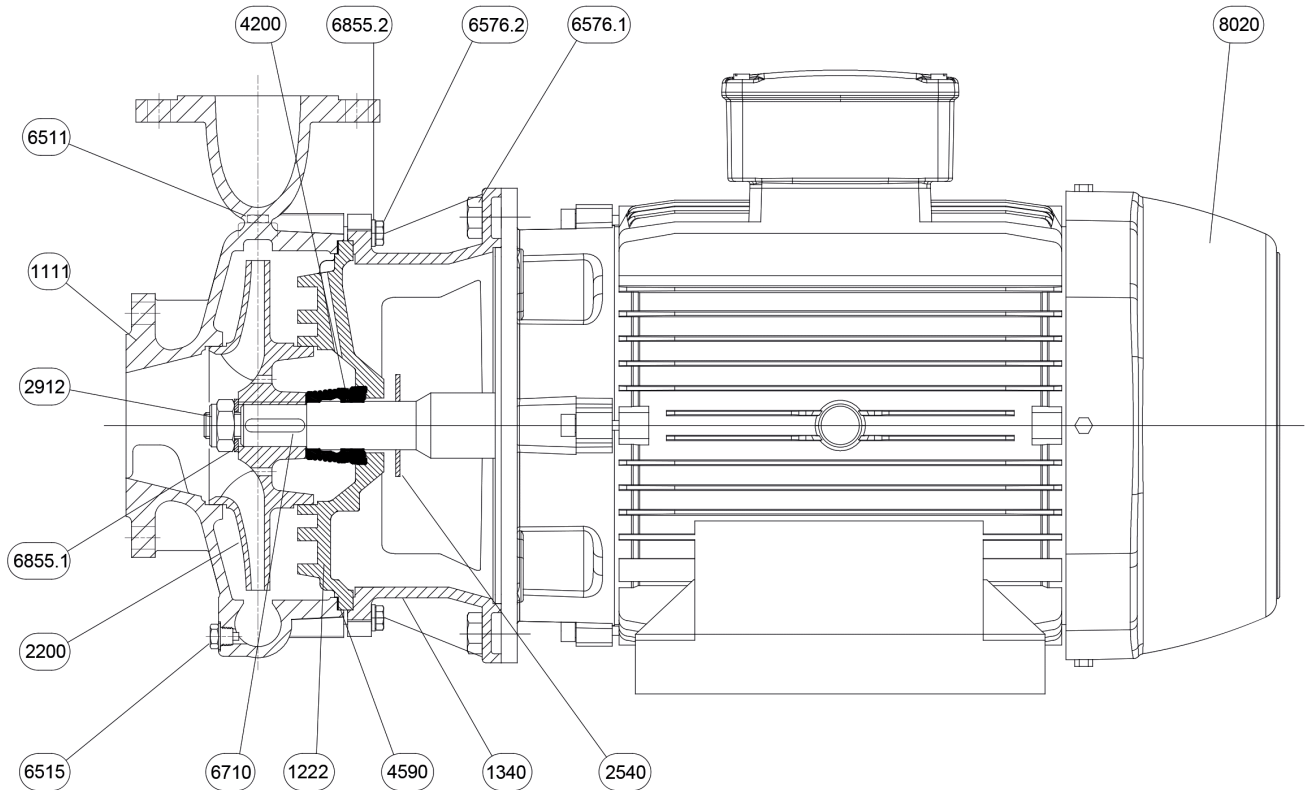

N°	PART NAME	MATERIAL	Q.TY
1111	Pump casing	EN-GJL-200	1
1222	Gland cover	EN-GJL-200	1
1340	Lantern	EN-GJL-200	1
2200	Impeller nut	EN-GJL-200	1
2540	Baffle	NB 70	1
2912	Impeller nut	6.8-ZN	1
4200	Mechanical seal	Sic/Sic/NBR/AISI 304	1
4590	Gasket	AF1600	1
6511	Refil plug	EN-GJMB-350-10	1
6515	Drain plug	EN-GJMB-350-10	1
6576.1	Hexagonal head screw	8.8-ZN	4
6576.2	Hexagonal head screw	8.8-ZN	8
6710	Key	C50	1
6855.1	Impeller washer	R40-ZN	1
6855.2	Washer	R40-ZN	8
8020	Motor		1

(2/2)

Construction

Pump name MMD 80-200/37 QQPFF

Customer	Date 2024-06-16	Company
Contact	Item no.	Issued by
Phone	Project	Phone
E-mail	Project ID Proiect redenumit 2024-06-16 15:45:44	E-mail

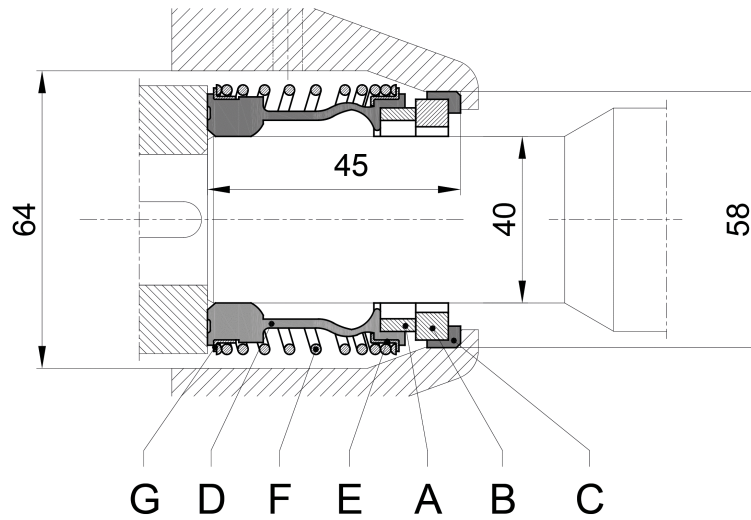

Ref.	Name	Material
A	Rotary seal ring	Carbon
B	Stationary seal ring	Silicon Carbide
C	Gasket	EPDM
D	Bellows	EPDM
E	Spring plate	AISI 304
F	Spring	AISI 304
G	Spring plate	AISI 304