

Technical data

Pump name OY6BHE 20-40/30

| | | | |
|----------|------------|---------------------------------------|-----------|
| Customer | Date | 2024-06-13 | Company |
| Contact | Item no. | | Issued by |
| Phone | Project | | Phone |
| E-mail | Project ID | Proiect redenumit 2024-06-13 07:43:07 | E-mail |

Requested data

| | | | | |
|---|---------------------------|----------------------------|--------------------|-------------|
| 1 | Pump type | SUBMERSIBLE DEEPWELL PUMPS | Fluid | Water |
| 2 | Number of pumps / Reserve | 1 / 0 | Liquid temperature | °C 20 |
| 3 | Flow | m³/h | Kin. viscosity | mm²/s 1.005 |
| 4 | Head | m | Vapour pressure | bar 0.0234 |
| 5 | Geodetic head | m | PH value | |
| 6 | Inlet pressure (pin) | bar 0 | Density | kg/m³ 998.3 |
| 7 | Available system NPSH | | Solids | Weight % 0 |
| 8 | Ambient temperature | °C 20 | | |

Pump

| | | | | |
|----|------------------------|-----------------------------------|-----------------------------------|--------------------|
| 9 | Pump name | OY6BHE 20-40/30 | Frequency | Hz 50 |
| 10 | Design | SUBMERSIBLE DEEPWELL PUMPS | Installation type | Ebara Motor Oil 6" |
| 11 | Manufacturer | EBARA | Impeller Diameter | Max. mm 0 |
| 12 | Speed | rpm 2850 | | Designed mm |
| 13 | No. of Stage | 40 | | Min. mm 0 |
| 14 | Connection | Suction side | Flow | Operating m³/h |
| 15 | Connection | Discharge side Rp 2" 1/2 | | Max- m³/h 27 |
| 16 | Max Working Pressure | bar 70 | | Min- m³/h 7.98 |
| 17 | Shut-off head | bar 47.10 | Head | Operating m |
| 18 | Total weight | kg See the table of "Dimensions". | | - (Qmax.) m 165.8 |
| 19 | Shaft power | kW | | - (Qmin.) m 437.0 |
| 20 | Max. fluid temperature | °C 40 | Max. Shaft Power at max. impeller | kW 23.70 |
| 21 | Required pump NPSH | m | Efficiency | % |

Materials

| | | | |
|----|------------------|----------------------|--|
| 22 | Impeller | EN 1.4301 (AISI 304) | |
| 23 | Discharge casing | EN 1.4301 (AISI 304) | |
| 24 | Shaft | EN 1.4057 (AISI 431) | |
| 25 | Diffuser | EN 1.4301 (AISI 304) | |
| 26 | | | |
| 27 | | | |

Motor

| | | | | |
|----|----------------------|--|------------------|-------|
| 28 | Manufacturer | EBARA MOTOR | Insulation class | IP 58 |
| 29 | Type | 6" 6BHE 20-40/30_380_Three Phase | Phases | 3~ |
| 30 | Specific design | Submersible oil filled type / 50 Hz / Pole pairs 1 | Frame size | 6" |
| 31 | Rated power | kW 30 | Weight | kg 90 |
| 32 | Number of poles | 2 | Electric voltage | V 380 |
| 33 | Speed | rpm 2840 | Electric current | A 63 |
| 34 | Degree of protection | F | | |
| 35 | | | | |

Remarks

Performance Curve

Pump Name

OY6BHE 20-40/30

| | | | |
|----------|------------|---------------------------------------|-----------|
| Customer | Date | 2024-06-13 | Company |
| Contact | Item no. | | Issued by |
| Phone | Project | | Phone |
| E-mail | Project ID | Project redenumit 2024-06-13 07:43:07 | E-mail |

Requested data

| | | | |
|---|---------------|------|--|
| 1 | Flow | m³/h | |
| 2 | Head | m | |
| 3 | Geodetic head | m | |

Pump

| | | | | |
|----------------------------|------|-----------------|-----|------|
| Operating flow | m³/h | Frequency | Hz | 50 |
| Operating head | m | Number of poles | | 2 |
| Impeller diameter designed | mm | Speed | rpm | 2850 |

Test standard: ISO 9906:2012 - Grade3B

Water; 20°C; 998.3kg/m³; 1mm²/s

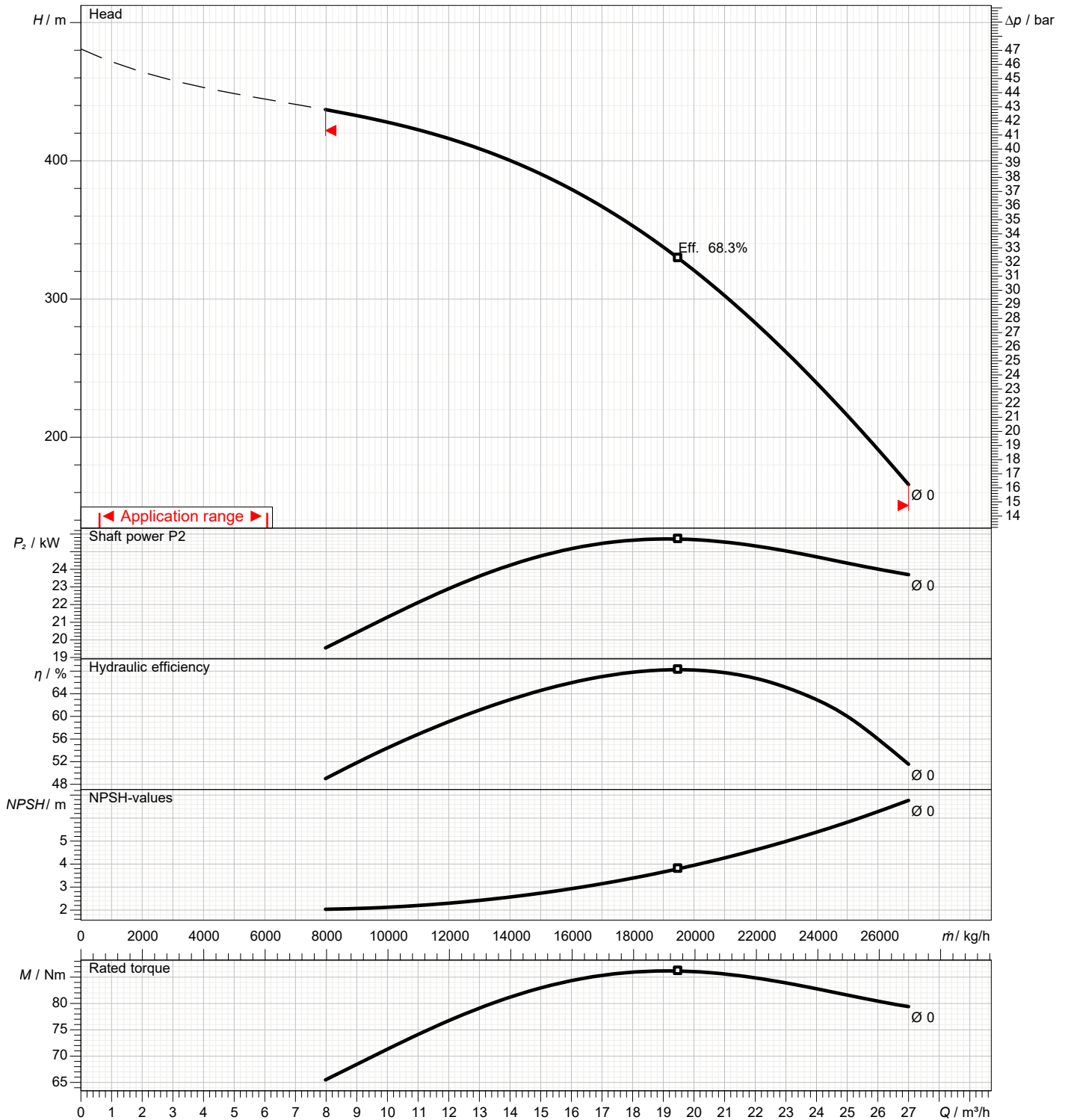

Dimensions

Pump name OY6BHE 20-40/30

| | | |
|----------|--|-----------|
| Customer | Date 2024-06-13 | Company |
| Contact | Item no. | Issued by |
| Phone | Project | Phone |
| E-mail | Project ID Proiect redenumit 2024-06-13 07:43:07 | E-mail |

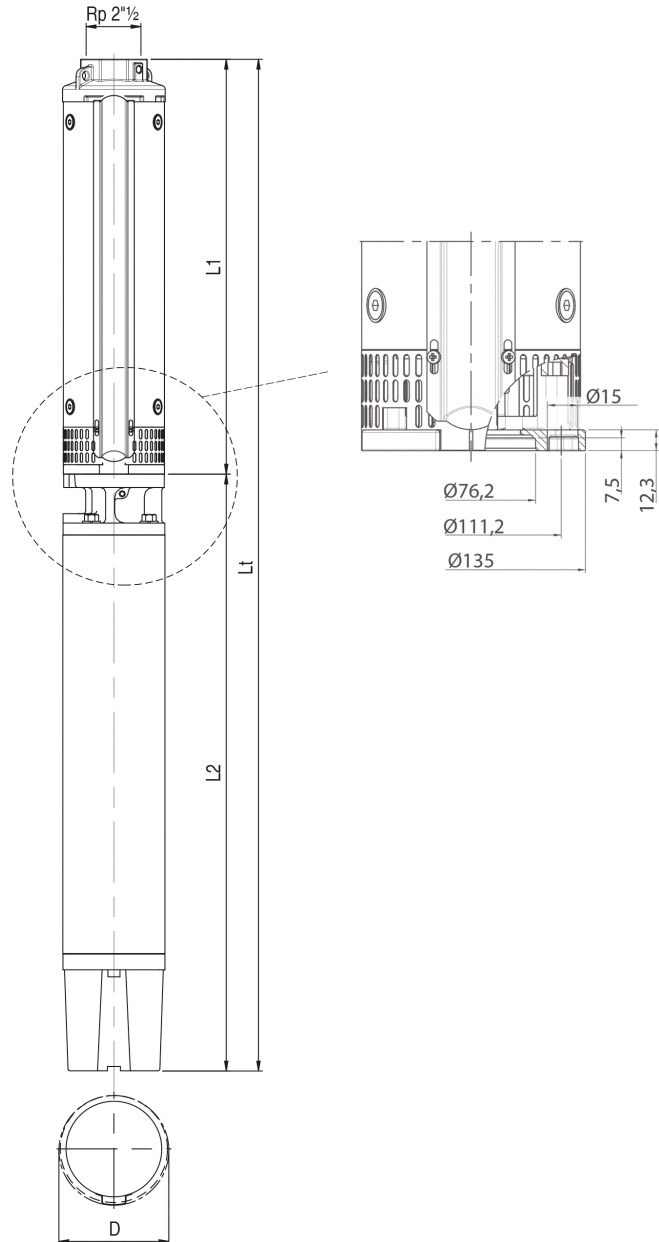

| Dimensions in | | mm | | | | | | |
|---------------|------------|----------|--|--|--|--|--|--|
| 1 | D 1 CABLE | 143 | | | | | | |
| 2 | D 2 CABLE | 144.5 | | | | | | |
| 3 | L1 | 1770 | | | | | | |
| 4 | L2 | 1030 | | | | | | |
| 5 | Lt | 2800 | | | | | | |
| 6 | Weight P&M | 214,5 kg | | | | | | |
| 7 | | | | | | | | |
| 8 | | | | | | | | |
| 9 | | | | | | | | |
| 10 | | | | | | | | |
| 11 | | | | | | | | |
| 12 | | | | | | | | |
| 13 | | | | | | | | |
| 14 | | | | | | | | |
| 15 | | | | | | | | |

(1/2)

Construction

Pump name OY6BHE 20-40/30

| | | |
|----------|--|-----------|
| Customer | Date 2024-06-13 | Company |
| Contact | Item no. | Issued by |
| Phone | Project | Phone |
| E-mail | Project ID Proiect redenumit 2024-06-13 07:43:07 | E-mail |

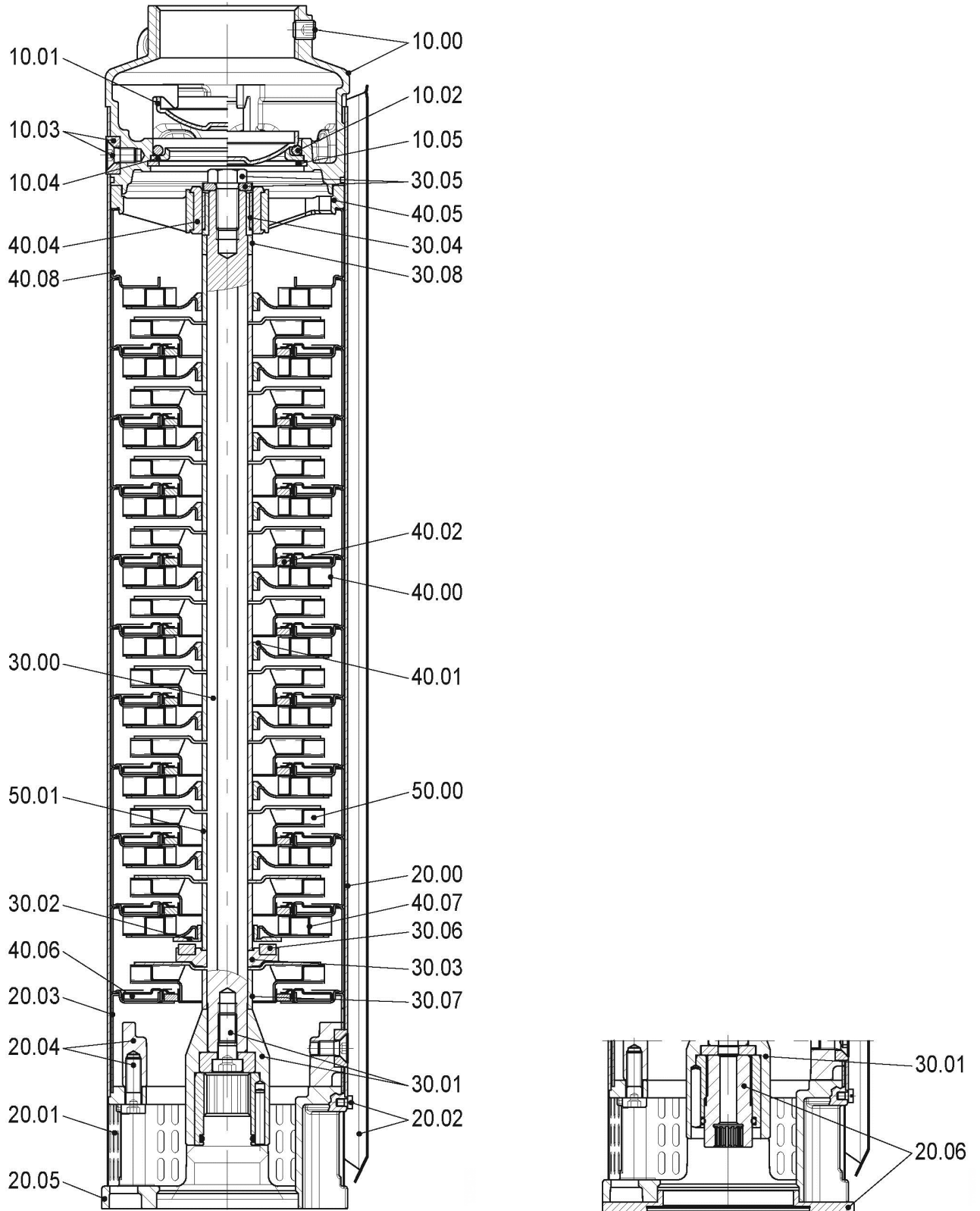

(2/2)**Construction**

Pump name OY6BHE 20-40/30

| | | |
|----------|--|-----------|
| Customer | Date 2024-06-13 | Company |
| Contact | Item no. | Issued by |
| Phone | Project | Phone |
| E-mail | Project ID Proiect redenumit 2024-06-13 07:43:07 | E-mail |

| N° | NAME | MATERIAL Standard version |
|-------|--------------------------------------|---|
| 10.00 | Discharge head and screw | EN 1.4301 (AISI 304) |
| 10.01 | Valve | EN 1.4401 (AISI 316) |
| 10.02 | O-ring | NBR |
| 10.03 | Screws and outer case locking nuts | EN 1.4401 (AISI 316) |
| 10.04 | Valve support | EN 1.4401 (AISI 316) |
| 10.05 | Seeger ring | EN 1.4401 (AISI 316) |
| 20.00 | Outer case | EN 1.4301 (AISI 304) |
| 20.01 | Suction strainer | EN 1.4401 (AISI 316) |
| 20.02 | Cable guard and screws | EN 1.4401 (AISI 316) |
| 20.03 | Initial spacer | EN 1.4301 (AISI 304) |
| 20.04 | Flange and bolts | EN 1.4301 (AISI 304) |
| 20.05 | Motor adapter | EN 1.4301 (AISI 304) |
| 30.00 | Pump shaft | EN 1.4057 (AISI 431) |
| 30.01 | Coupling | EN 1.4057 (AISI 431) + EN 1.4460 (AISI 329) |
| 30.02 | Upper up-thrust washer | EN 1.4401 (AISI 316) |
| 30.03 | Lower up-thrust washer | EN 1.4401 (AISI 316) |
| 30.04 | Upper journal sleeve | EN 1.4460 (AISI 329) with ceramic coating |
| 30.05 | Screw and washer | EN 1.4401 (AISI 316) |
| 30.06 | Up-thrust ring | PTFE + Graphite |
| 30.07 | Lower spacer | EN 1.4401 (AISI 316) |
| 30.08 | Upper spacer | EN 1.4401 (AISI 316) |
| 40.00 | Diffusers | EN 1.4301 (AISI 304) |
| 40.01 | Secondary bearing bush | NBR |
| 40.02 | Floating neck ring | PTFE |
| 40.04 | Bearing bush | NBR |
| 40.05 | Upper bearing guide | EN 1.4401 (AISI 316) |
| 40.06 | First diffuser | EN 1.4401 (AISI 316) |
| 40.07 | Diffuser with upper up-thrust washer | EN 1.4401 (AISI 316) |
| 40.08 | Last diffuser | EN 1.4401 (AISI 316) |
| 50.00 | Impeller | EN 1.4301 (AISI 304) |
| 50.01 | Impeller spacer | EN 1.4401 (AISI 316) |
| 50.05 | Wear ring | EN 1.4301 (AISI 304) |