

Technical data

Pump name

OY 4N4-23/3,06

Customer	Date	2024-07-02	Company
Contact	Item no.		Issued by
Phone	Project		Phone
E-mail	Project ID	Proiect redenumit 2024-07-02 22:34:28	E-mail

Requested data

1	Pump type		SUBMERSIBLE MULTISTAGE PUMPS	Fluid		Water
2	Number of pumps / Reserve		1 / 0	Liquid temperature	°C	20
3	Flow	m³/h		Kin. viscosity	mm²/s	1.005
4	Head	m		Vapour pressure	bar	0.0234
5	Geodetic head	m		PH value		
6	Inlet pressure (pin)	bar	0	Density	kg/m³	998.3
7	Available system NPSH			Solids	Weight %	0
8	Ambient temperature	°C	20			

Pump

9	Pump name		OY 4N4-23/3,06	Frequency	Hz	60
10	Design		SUBMERSIBLE MULTISTAGE PUMPS	Installation type		with EBARA MOTOR OIL - three phase
11	Manufacturer		EBARA	Impeller Diameter	Max. mm	76
12	Speed	rpm	3450		Designed mm	76
13	No. of Stage		23		Min. mm	76
14	Connection	Suction side		Flow	Operating m³/h	
15	Connection	Discharge side	UNI ISO 228		Max- m³/h	6.9
16	Max Working Pressure	bar			Min- m³/h	2.1
17	Shut-off head	bar	21.84	Head	Operating m	
18	Total weight	kg	See the table of "Dimensions".		- (Qmax.) m	54.0
19	Shaft power	kW	(Power / Stage)		- (Qmin.) m	203.2
20				Max. Shaft Power at max. impeller	kW	2.78 (Power / Stage)
21	Required pump NPSH	m		Efficiency	%	

Materials

22	Impeller		1xe6			
23	Casing		EN 1.4301 (AISI 304)			
24	Shaft		EN 1.4301 (AISI 304)			
25						
26						
27						

Motor

28	Manufacturer		EBARA MOTOR	Insulation class		F
29	Type		4N4-23/3,06_380_Three Phase	Phases		3~
30	Specific design		Submersible oil filled type / 60 Hz / Pole pairs 1	Frame size		
31	Rated power	kW	3	Weight	kg	13.1
32	Number of poles		2	Electric voltage	V	380
33	Speed	rpm	3430	Electric current	A	8.3
34	Degree of protection		IP 68			
35						

Remarks

Performance curve

Pump name

OY 4N4-23/3,06

Customer	Date	2024-07-02	Company
Contact	Item no.		Issued by
Phone	Project		Phone
E-mail	Project ID	Proiect redenumit 2024-07-02 22:34:28	E-mail

Requested data

1	Flow	m ³ /h	
2	Head	m	
3	Geodetic head	m	

Pump

Operating flow	m ³ /h		Frequency	Hz	60	
Operating head	m		Number of poles		2	
Impeller Diameter	Designed	mm	76	Speed	rpm	3450

Test standard: ISO 9906:2012 - Grade3B

Water; 20°C; 998.3kg/m³; 1mm²/s

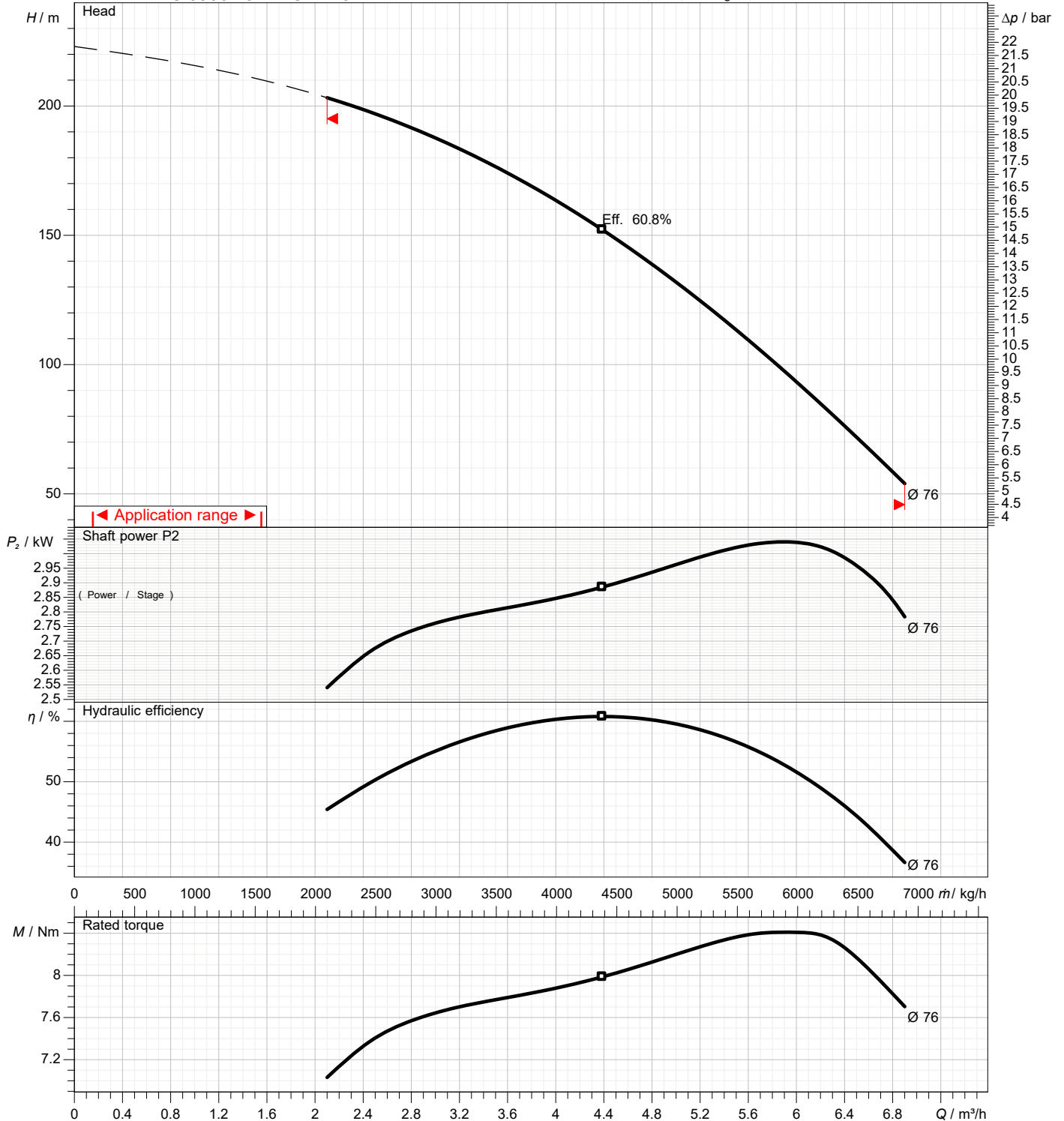

Dimensions

Pump name OY 4N4-23/3,06

Customer	Date 2024-07-02	Company
Contact	Item no.	Issued by
Phone	Project	Phone
E-mail	Project ID Proiect redenumit 2024-07-02 22:34:28	E-mail

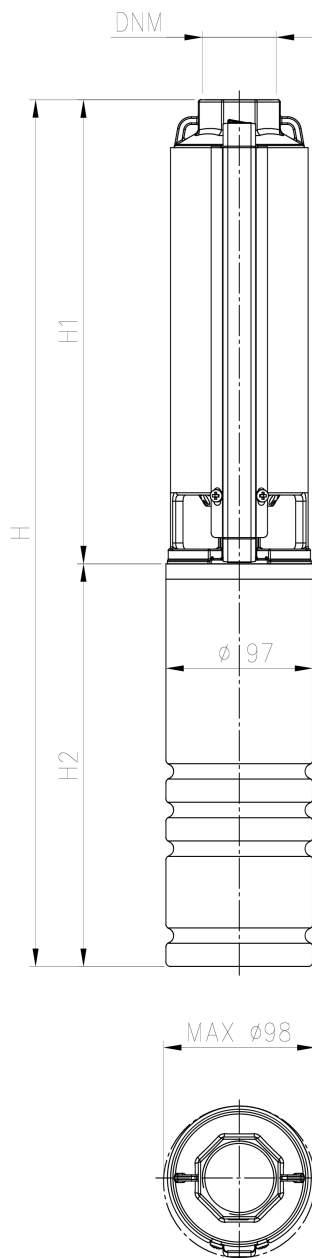

Dimensions in		mm						
1	DNM	G 1 1/4						
2	H	1181						
3	H1	637						
4	H2	544						
5	Weight P&M	18,1 kg						
6								
7								
8								
9								
10								
11								
12								
13								
14								
15								

(1/3)

Construction

Pump name OY 4N4-23/3,06

Customer	Date 2024-07-02	Company
Contact	Item no.	Issued by
Phone	Project	Phone
E-mail	Project ID Proiect redenumit 2024-07-02 22:34:28	E-mail

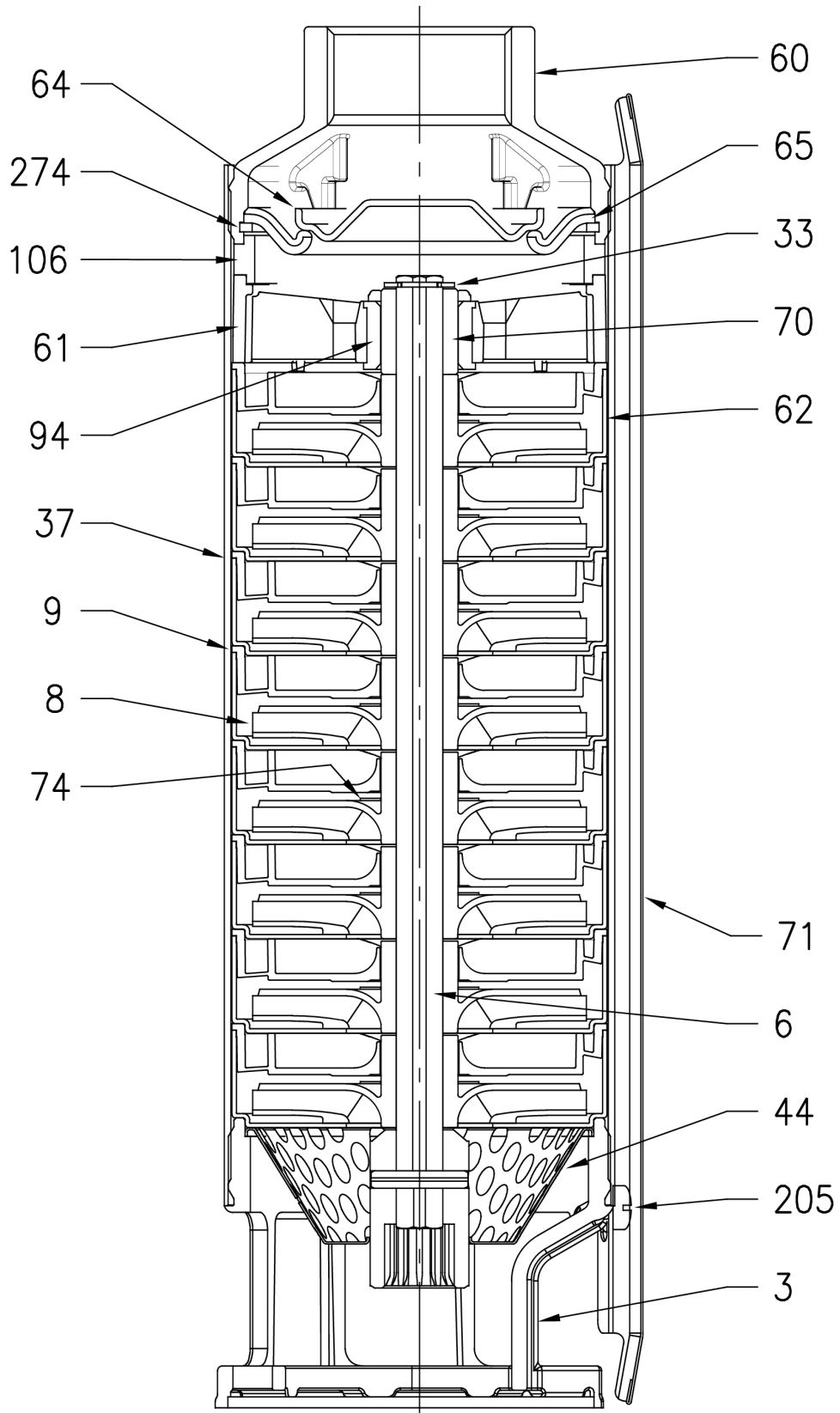

(2/3)

Construction

Pump name OY 4N4-23/3,06

Customer	Date	2024-07-02	Company
Contact	Item no.		Issued by
Phone	Project		Phone
E-mail	Project ID	Project redenumit 2024-07-02 22:34:28	E-mail

Pos.	PART.NAME	MATERIAL	Q.TY
3	Bracket	EN 1.4308 (ASTM CF8)	1
6	Pump shaft with coupling	EN 1.4301 (AISI 304)	1
8	Impeller	Ixel®	[*]
9	Diffuser	PPE+PS Glass fibre reinforced	[*]
33	Elastic Ring	EN 1.4301 (AISI 304)	1
37	Outer casing	EN 1.4301 (AISI 304)	[*]
44	Strainer	EN 1.4301 (AISI 304)	1
60	Discharge casing	EN 1.4308 (ASTM CF8)	1
61	Upper / Intermediate bracket	PPE+PS Glass fibre reinforced	[*]
62	Stage housing	EN 1.4301 (AISI 304)	[*]
64	Valve	EN 1.4301 (AISI 304)	1
65	Valve seat	EN 1.4301 (AISI 304) + EPDM Rubber	1
70	Shaft sleeve bearing	Alumina (Ceramic)	[*]
71	Cable guard	EN 1.4301 (AISI 304)	1
74	Thrust washer	EN 1.4301 (AISI 304)	[*]
94	Bearing	EPDM Rubber	[*]
106	Spacer	NORYL+GF20%	1
205	Screw (M4 x 6 UNI 7687)	EN 1.4301 (AISI 304)	2
274	Elastic Ring	EN 1.4310 (AISI 302)	1

[*] See **CONSTRUCTION 3**

(3/3)

Construction

Pump name OY 4N4-23/3,06

Customer	Date	2024-07-02	Company
Contact	Item no.		Issued by
Phone	Project		Phone
E-mail	Project ID	Project redenumit 2024-07-02 22:34:28	E-mail

Pump type	POS. 3A Join Ring	POS. 8 Impeller	POS. 9 Diffuser	POS. 37 Outer casing	POS. 61 Upper / Intermediate bracket	POS. 62 Stage housing	POS. 70 Shaft sleeve bearing	POS. 73 Thurst washer first impeller	POS. 74 Thurst washer	POS. 94 Bearing	POS. 105 Spacer
4N4 4	-	4	4	1	1	4	1	-	4	1	-
4N4 7	-	7	7	1	1	7	1	-	7	1	-
4N4 9	-	9	9	1	1	9	1	-	9	1	-
4N4 13	-	13	13	1	1	13	1	-	13	1	-
4N4 17	-	17	18	1	1	18	1	-	17	1	1+3
4N4 23	-	23	23	1	1	23	1	-	23	1	-
4N4 31	1	31	31	2	2	31	2	-	31	2	3