

# Technical Data

Pump Name

PRA 1.00 T

Customer	Date	2024-06-16	Company
Contact	Item no.		Issued by
Phone	Project		Phone
E-mail	Project ID	Proiect redenumit 2024-06-16 15:45:44	E-mail

## Requested data

1	Pump type	PERIPHERAL	Fluid	Water	
2	Number of pumps / Reserve	1 / 0	Liquid temperature	°C	20
3	Flow	m³/h	Kin. viscosity	mm²/s	1.005
4	Head	m	Vapour pressure	bar	0.0234
5	Geodetic head	m	PH value		
6	Inlet pressure (pin)	bar	Density	kg/m³	998.3
7	Available system NPSH		Solids	Weight %	0
8	Ambient temperature	°C	20		

## Pump

9	Pump Name	PRA 1.00 T	Frequency	Hz	50		
10	Design	PERIPHERAL	Installation type		STANDARD		
11	Manufacturer	EBARA	Impeller Diameter	Max.	mm	71	
12	Speed	rpm		2850	Designed	mm	71
13	No. of Stage	1		Min.	mm	71	
14	Connection	Suction side	UNI ISO 228	Flow	Operating	m³/h	
15	Connection	Discharge side	UNI ISO 228		Max-	m³/h	3
16	Max Working Pressure	bar	12		Min-	m³/h	0.3
17	Shut-off head	bar	6.95	Head	Operating	m	
18	Total weight	kg	See the table of "Dimensions".		- (Qmax.)	m	13.0
19	Shaft power	kW			- (Qmin.)	m	62.2
20				Max. Shaft Power at max. impeller	kW		
21	Required pump NPSH	m		Efficiency	%		

## Materials

22	Impeller	Brass		
23	Casing	Cast iron		
24	Shaft	Carbon steel - AISI 303 (Wet extension)		
25				
26				
27				

## Motor

28	Manufacturer	EPE Standard	Insulation class	F		
29	Type	TEFC_PRA 1.00 M_230_Single Phase	Phases	1~		
30	Specific design	IE2 / 50 Hz / Pole pairs 1	Frame size			
31	Rated power	kW	0.75	Weight	kg	
32	Number of poles	2	Electric voltage	V	230	
33	Speed	rpm	2850	Electric current	A	4.4
34	Degree of protection	IP 44				
35						

## Remarks

--

# Performance Curve

Pump Name

PRA 1.00 T

Customer	Date	2024-06-16	Company
Contact	Item no.		Issued by
Phone	Project		Phone
E-mail	Project ID	Project redenumit 2024-06-16 15:45:44	E-mail

## Requested data

1	Flow	m³/h	
2	Head	m	
3	Geodetic head	m	

## Pump

Operating flow	m³/h		Frequency	Hz	50
Operating head	m		Number of poles		2
Impeller diameter designed	mm	71	Speed	rpm	2850

Test standard: ISO 9906:2012 - Grade3B

Water; 20°C; 998.3kg/m³; 1mm²/s

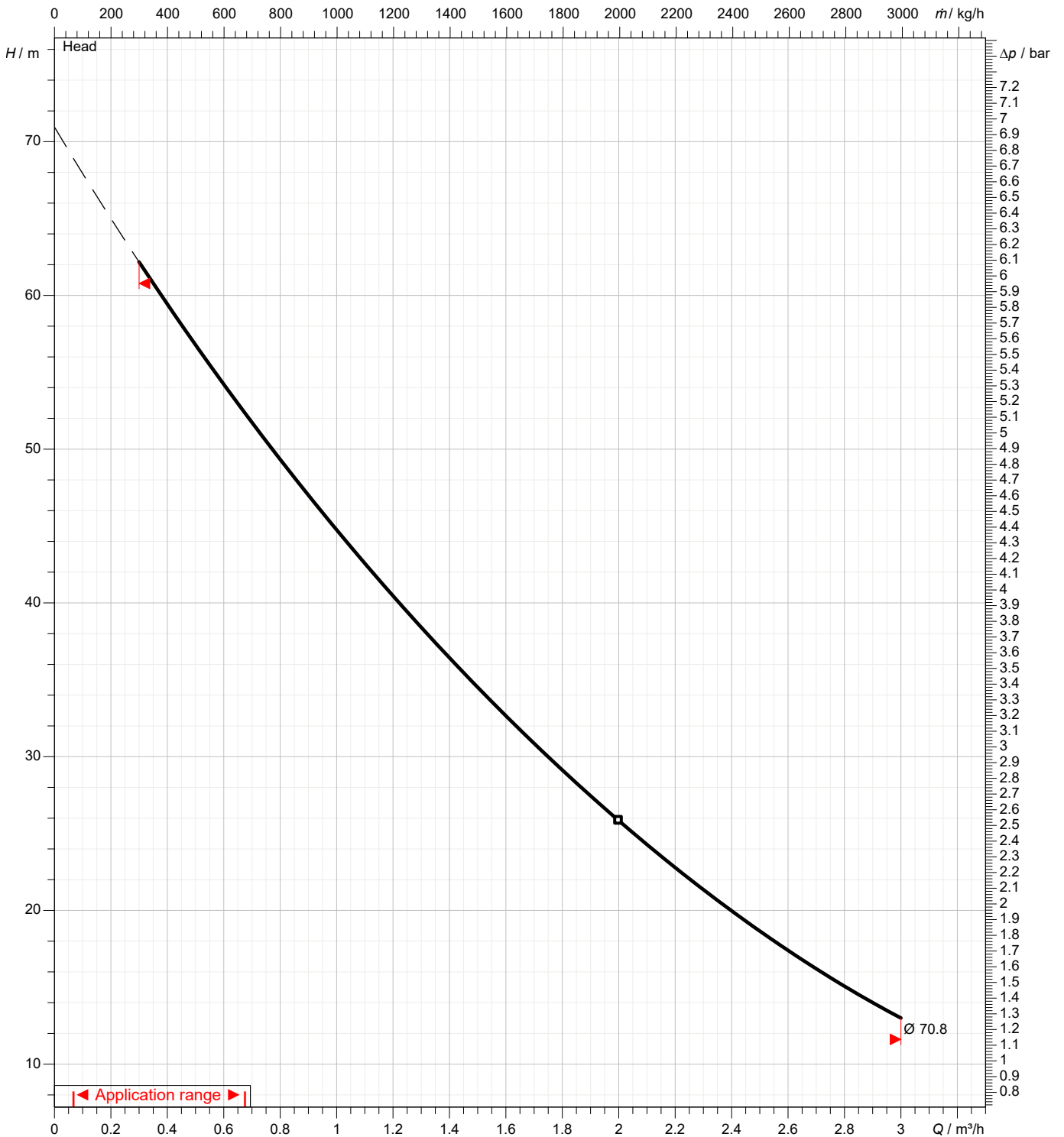

# Dimensions

Pump Name PRA 1.00 T

Customer	Date 2024-06-16	Company
Contact	Item no.	Issued by
Phone	Project	Phone
E-mail	Project ID Proiect redenumit 2024-06-16 15:45:44	E-mail

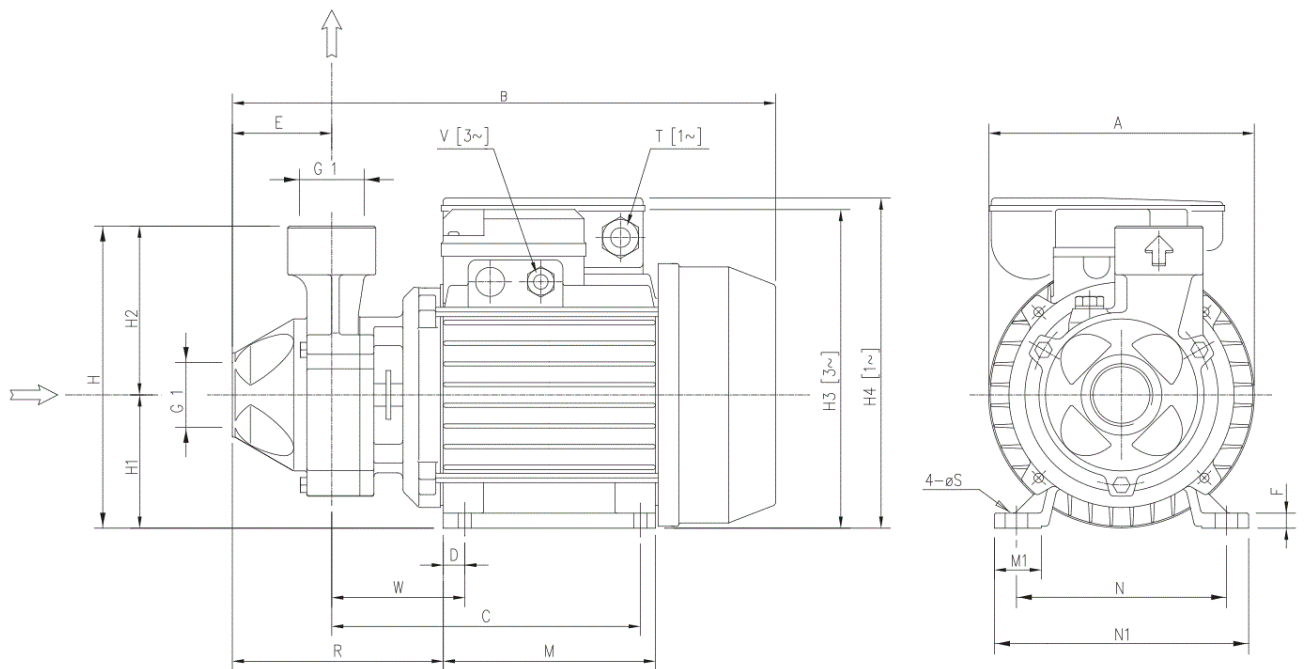

[1~] Single Phase  
[3~] Three Phase

Dimensions in		mm						
1	A	150	S	7				
2	B	291	V	M16x1.5				
3	C	159	W	69				
4	D	11	Weight PUMP	10.5 kg				
5	E	54						
6	F	9						
7	H	161						
8	H1	71						
9	H2	90						
10	H3	168						
11	M	112						
12	M1	25						
13	N	112						
14	N1	135						
15	R	122						

(1/3)

# Construction

Pump Name PRA 1.00 T

Customer	Date 2024-06-16	Company
Contact	Item no.	Issued by
Phone	Project	Phone
E-mail	Project ID Proiect redenumit 2024-06-16 15:45:44	E-mail

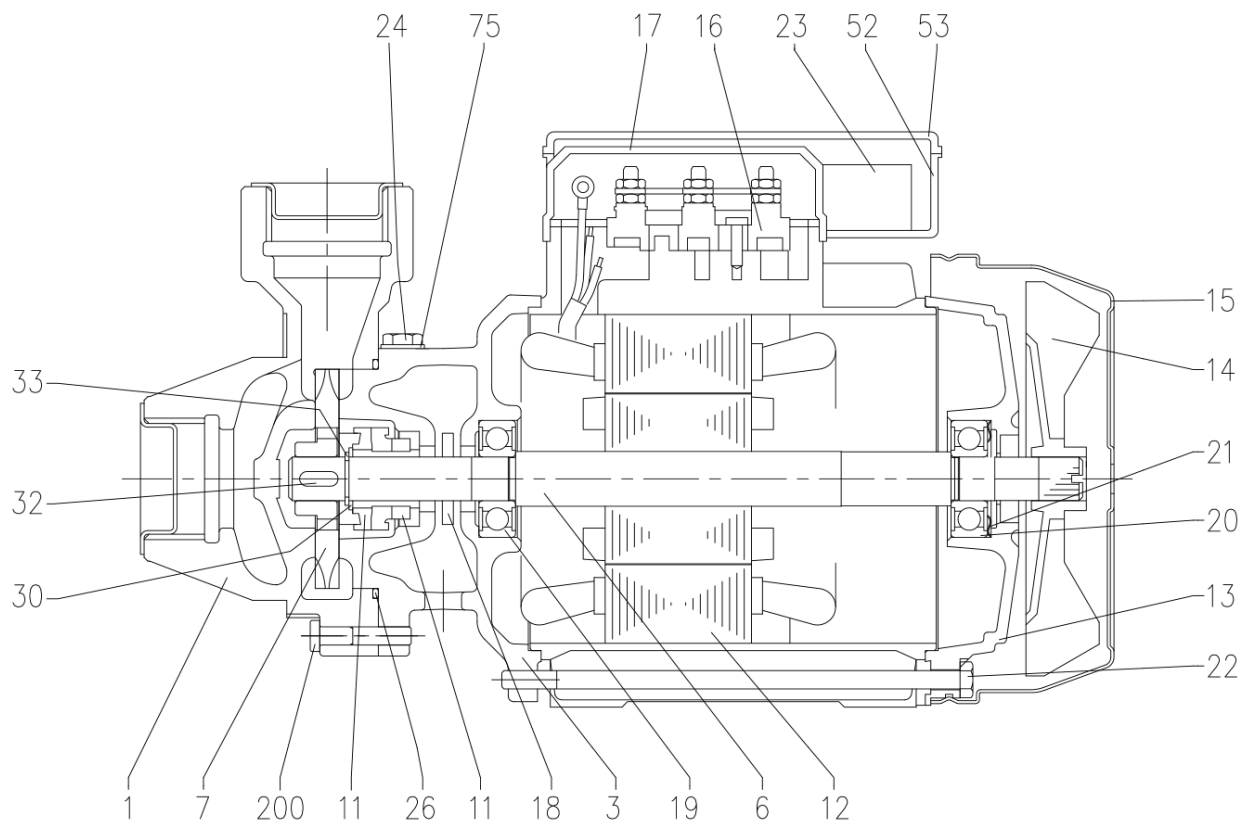

(2/3)

# Construction

Pump Name PRA 1.00 T

Customer	Date	2024-06-16	Company
Contact	Item no.		Issued by
Phone	Project		Phone
E-mail	Project ID	Project redenumit 2024-06-16 15:45:44	E-mail

N°	PART NAME	MATERIAL	DIMENSIONS	STANDARD	Q.TY
1	Casing	Cast iron			1
3	Motor bracket	Cast iron			1
6	Shaft with rotor	[1]		UNI 7846	1
7	Impeller	Brass			1
11	Mechanical seal	[2] Carbon/Ceramic/NBR	[2]		1
12	Motor frame with stator	-			1
13	Motor cover	Aluminium			1
14	Fan	PP			1
15	Fan cover	Fe P04 Galvanized			1
16	Terminal box	-			1
17	Terminal box cover	[3] Aluminium			1
18	Splash ring	NBR			1
19	Pump side ball bearing	-			1
20	Fan side ball bearing	-			1
21	Adjusting ring	Steel C70			1
22	Tie rod	Fe 42 Galvanized			4
23	Capacitor	[4] -			1
24	Priming plug	Brass	G 1/8"	UNI 338	1
26	O-Ring	NBR			1
30	Washer	AISI 304			1
32	Key	AISI 316			1
33	Seeger ring	AISI 304		UNI 7435	1
52	Capacitor box	[4] ABS class V-0			1
53	Capacitor box cover	[4] ABS class V-0			1
75	Washer	Aluminium			1
200	Screw	0.37 kW	M5X25	UNI 5938	3
		0.6-0.75 kW	M5X40	ISO 898-1	
		1.1-1.5 kW	M6X45		

- [1] Material:AVZ for version PRA 0.50  
AISI 303 (wet extension) for the other version
- [2] See **CONSTRUCTION 3**
- [3] Only for three phase
- [4] Only for single phase

(3/3)

# Construction

Pump Name PRA 1.00 T

Customer	Date 2024-06-16	Company
Contact	Item no.	Issued by
Phone	Project	Phone
E-mail	Project ID Proiect redenumit 2024-06-16 15:45:44	E-mail

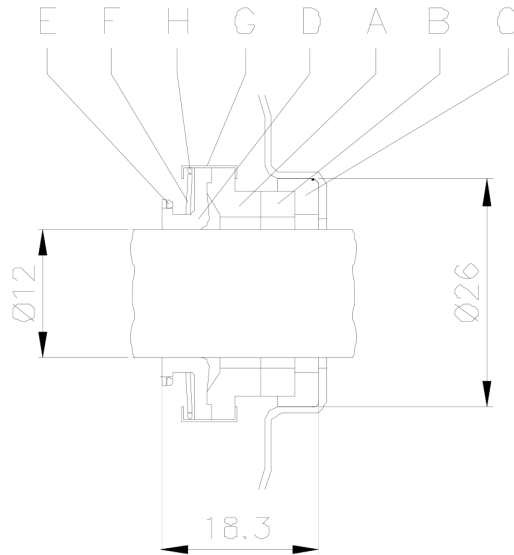

REF	PART NAME	MATERIAL
A	Rotary seal ring	Carbon graphite
B	Stationary seal ring	Ceramic
C	Gasket	NBR
D	Bellows	NBR
E	Ring	AISI 304
F	Self driving spring	AISI 304
G	Frame	AISI 304
H	Retainer ring	AISI 304