

Technical Data

Pump Name

RIGHT 100

Customer	Date	2024-06-16	Company
Contact	Item no.		Issued by
Phone	Project		Phone
E-mail	Project ID	Proiect redenumit 2024-06-16 15:45:44	E-mail

Requested data

1	Pump type		SUBMERSIBLE SEWAGE PUMPS	Fluid		Water
2	Number of pumps / Reserve		1 / 0	Liquid temperature	°C	20
3	Flow	m³/h		Kin. viscosity	mm²/s	1.005
4	Head	m		Vapour pressure	bar	0.0234
5	Geodetic head	m		PH value		
6	Inlet pressure (pin)	bar	0	Density	kg/m³	998.3
7	Available system NPSH			Solids	Weight %	0
8	Ambient temperature	°C	20			

Pump

9	Pump Name		RIGHT 100	Frequency	Hz	50
10	Design		SUBMERSIBLE SEWAGE PUMPS	Installation type		STANDARD
11	Manufacturer		EBARA	Impeller Diameter	Max. mm	100
12	Speed	rpm	2875		Designed mm	100
13	No. of Stage		1		Min. mm	100
14	Connection	Suction side	UNI ISO 228	Flow	Operating m³/h	
15	Connection	Discharge side	UNI ISO 228		Max- m³/h	18
16	Max Working Pressure	bar			Min- m³/h	2.4
17	Shut-off head	bar	1.03	Head	Operating m	
18	Total weight	kg	See the table of "Dimensions".		- (Qmax.) m	2.0
19	Shaft power	kW			- (Qmin.) m	9.5
20				Max. Shaft Power at max. impeller	kW	
21	Required pump NPSH	m		Efficiency	%	

Materials

22	Impeller		AISI 304		
23	Casing		AISI 304		
24	Shaft		AISI 303 (wet extension)		
25					
26					
27					

Motor

28	Manufacturer		EPE Standard	Insulation class		F
29	Type		RIGHT 100 M_230_Single Phase	Phases		1~
30	Specific design		Submersible dry type / 50 Hz / Pole pairs 1	Frame size		
31	Rated power	kW	0.75	Weight	kg	
32	Number of poles		2	Electric voltage	V	230
33	Speed	rpm	2875	Electric current	A	5.7
34	Degree of protection		IP X8			
35						

Remarks

Performance Curve

Pump Name

RIGHT 100

Customer	Date	2024-06-16	Company
Contact	Item no.		Issued by
Phone	Project		Phone
E-mail	Project ID	Proiect redenumit 2024-06-16 15:45:44	E-mail

Requested data

1	Flow	m³/h	
2	Head	m	
3	Geodetic head	m	

Pump

Operating flow	m³/h		Frequency	Hz	50
Operating head	m		Number of poles		2
Impeller diameter designed	mm	100	Speed	rpm	2875

Test standard: ISO 9906:2012 - Grade3B

Water; 20°C; 998.3kg/m³; 1mm²/s

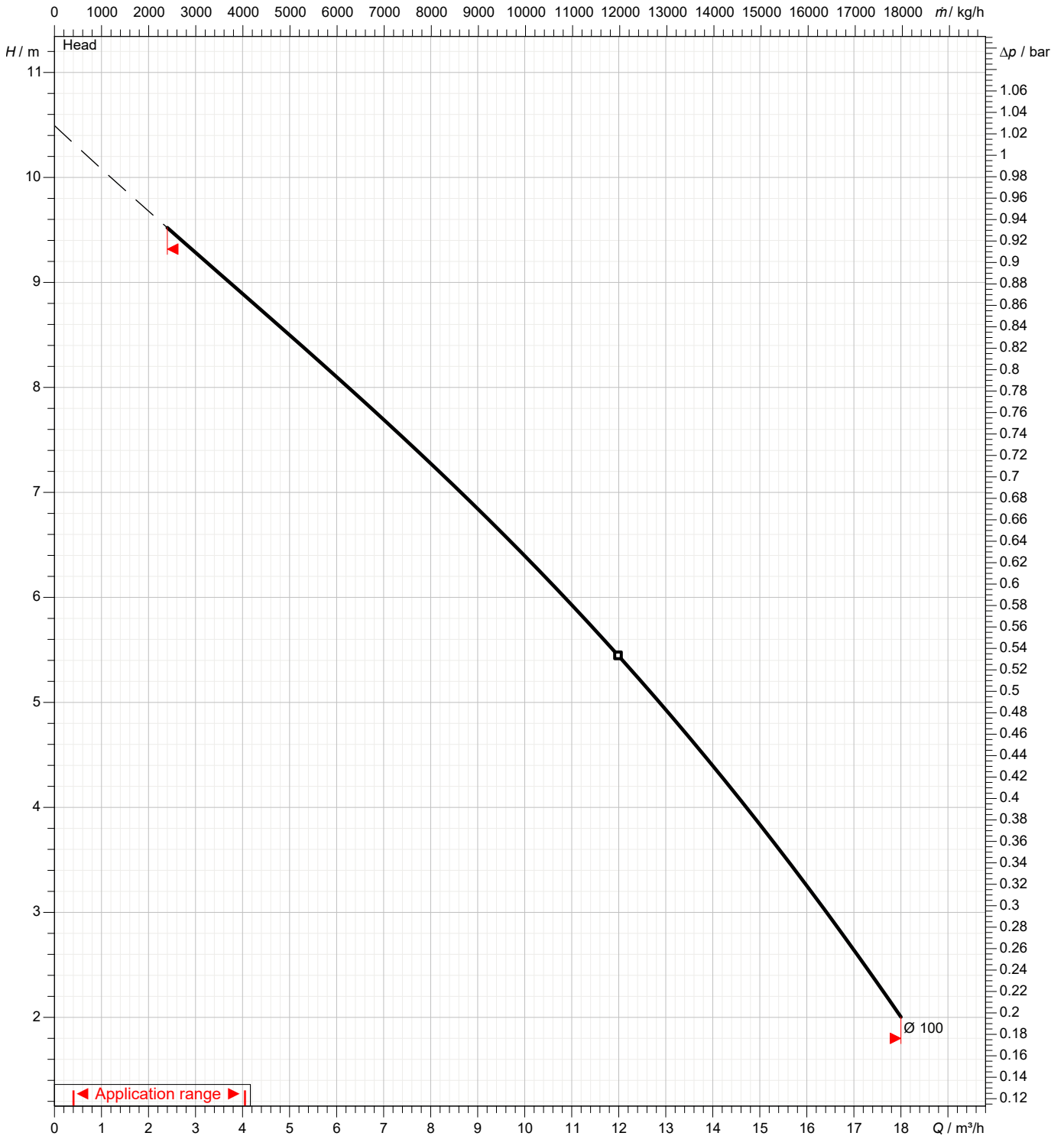

Dimensions

Pump Name RIGHT 100

Customer	Date 2024-06-16	Company
Contact	Item no.	Issued by
Phone	Project	Phone
E-mail	Project ID Proiect redenumit 2024-06-16 15:45:44	E-mail

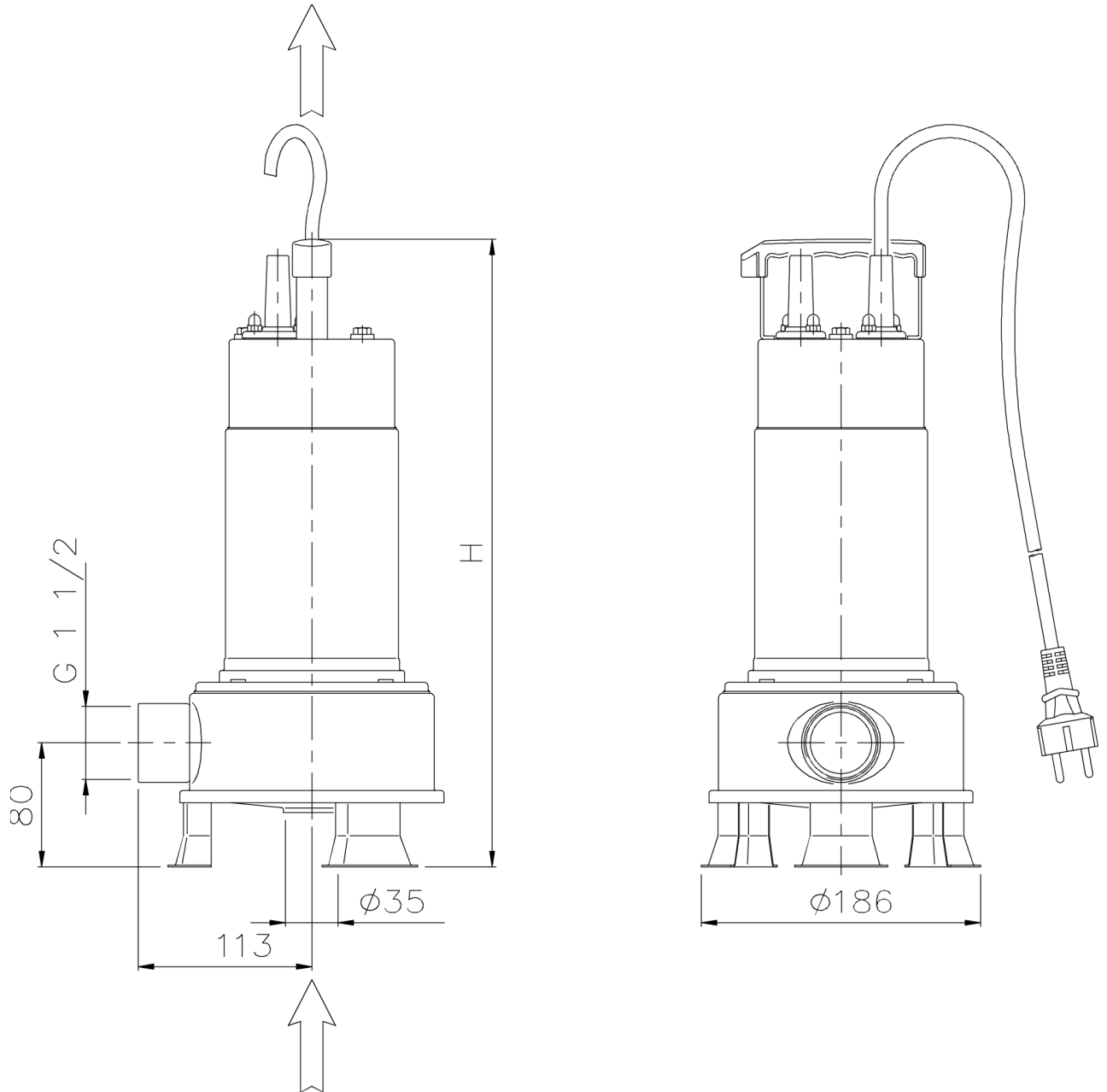

Dimensions in		mm						
1	H	430						
2	Weight PUMP	11,5 kg						
3								
4								
5								
6								
7								
8								
9								
10								
11								
12								
13								
14								
15								

Customer	Date 2024-06-16	Company
Contact	Item no.	Issued by
Phone	Project	Phone
E-mail	Project ID Proiect redenumit 2024-06-16 15:45:44	E-mail

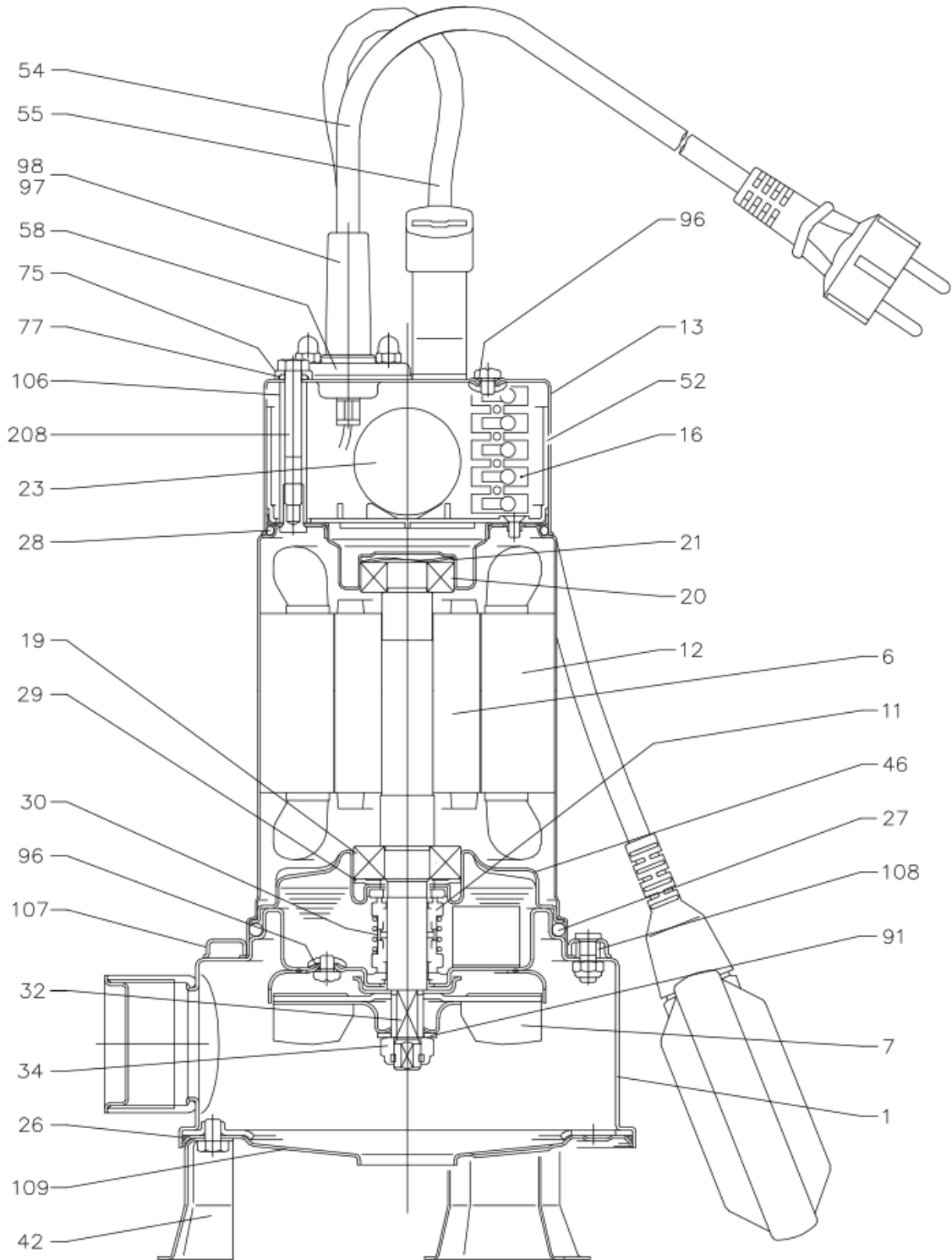

(2/3)

Construction

Pump Name RIGHT 100

Customer	Date	2024-06-16	Company
Contact	Item no.		Issued by
Phone	Project		Phone
E-mail	Project ID	Project redenumit 2024-06-16 15:45:44	E-mail

N°	PART NAME	MATERIAL	Q.TY
1	Casing	AISI 304	1
6	Shaft with rotor	AISI 303	1
7	Impeller	AISI 304	1
11	Mechanical seal [3]	Ceramic/Carbon/NBR	1
12	Motor frame with stator	-	1
13	Cover	AISI 304	1
16	Terminal	-	4
19	Lower ball bearing	-	1
20	Upper ball bearing	-	1
21	Adjusting washer	AISI 304	1
23	Capacitor [2]	-	1
26	"O" Ring	NBR	1
27	O Ring	NBR	1
28	O Ring	NBR	1
29	Washer	AISI 304	1
30	Mechanical seal spacer	Brass	1
32	Key	AISI 304	1
34	Nut	AISI 303	1
42	Foot	AISI 304	3
46	Lower bearing bracket	AISI 304	1
52	Capacitor box	PA 66 glass fibre reinforced class V-0	1
54	Submersible power cable	-	1
55	Float switch [1]	-	1
58	Cable gland	AISI 304	1
75	Washer	AISI 304	3
77	O Ring	NBR	3
91	Washer	AISI 304	1
96	O Ring	NBR	2
97	Cable connector	NBR	1
98	Cable connector [1]	NBR	1
106	Spacer	AISI 304	3
107	Stopper ring	AISI 304	1
108	Gasket	NBR	1
109	Suction cover	AISI 304	1
208	Screw	AISI 304	3

[1] Only for single phase version with float switch

[2] Only for single phase version

[3] See **CONSTRUCTION 3**

(3/3)

Construction

Pump Name RIGHT 100

Customer	Date 2024-06-16	Company
Contact	Item no.	Issued by
Phone	Project	Phone
E-mail	Project ID Proiect redenumit 2024-06-16 15:45:44	E-mail

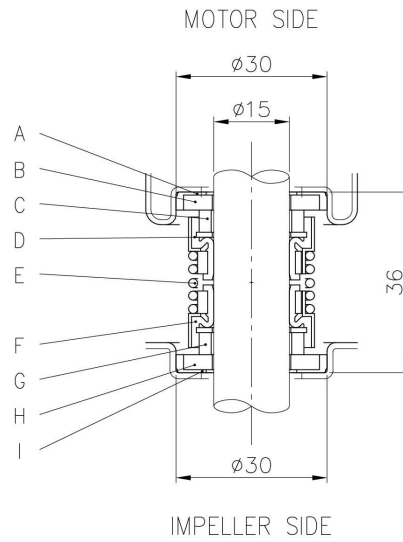

REF	PART NAME	MATERIAL
A	Rubber cup	NBR
B	Seat	Ceramic
C	Seal face	Carbon
D	Bellow	NBR
E	Spring	AISI 304
F	Bellow	NBR
G	Seal face	Silicon carbide
H	Seat	Silicon carbide
I	Rubber cup	NBR