

Customer

Technical data

Multi-pump system

SiFlux 21-IP-E 40/120-1,5/2-SC-16-T4

Project ID: Untitled project 2025-03-17 06:38:35.502

Project name
Installation location
Customer pos. No.

Date: 2025-03-17

Duty chart

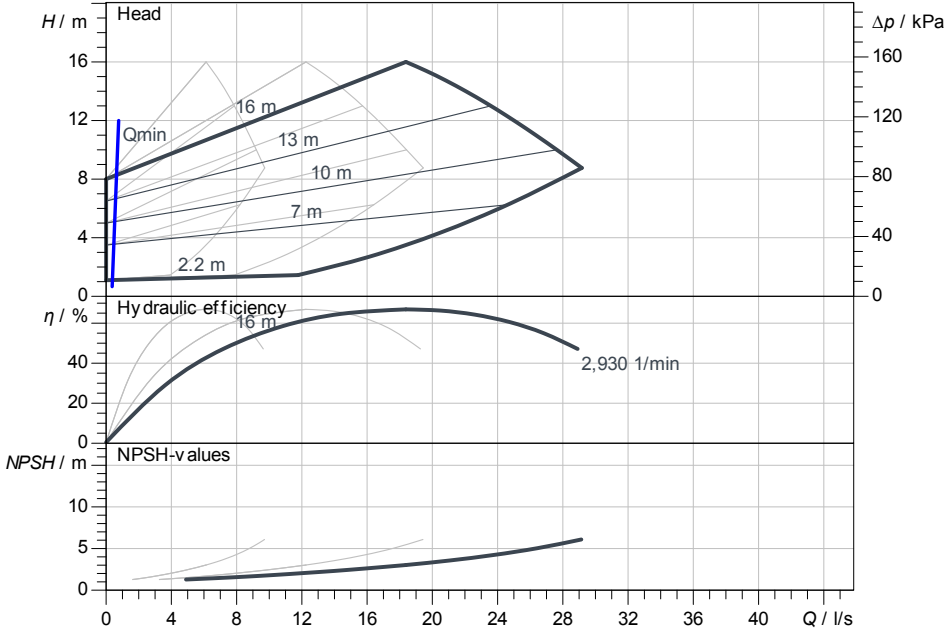

Requested data

Flow	
Head	
Media	Water 100 %
Fluid temperature	20.00 °C
Density	998.30 kg/m ³
Kin. viscosity	1.00 mm ² /s

Hydraulic data (Duty point)

Flow	
Head	
Power input P1	
NPSH	

Product data

Multi-pump system	
SiFlux 21-IP-E 40/120-1,5/2-SC-16-T4	
No. of pumps	3
Standby pump	No
Kind of operation	dp-v
Max. operating pressure	1,000 kPa
Fluid temperature	0 °C ... + 100 °C
Max. ambient temperature	40 °C

Motordata per Motor/Pump

Motor design	Standard motor
Efficiency class	IE4
Mains connection	3~ 400 V / 50 Hz
Permitted voltage tolerance	+/- 10 %
Max. speed	2,900 1/min
Rated power P2	1.50 kW
Power consumption	
Rated current	5.00 A
Degree of protection	IP55
Insulation class	F
Motor protection	

Fitting dimensions

Pipe connection on the suction side	DN 125, PN 16
Pipe connection (pressure side)	DN 125, PN 16

Materials

Pump housing	5.1301/EN-GJL-250
Impeller	PPE/PS-GF30
Shaft seal	AQ1EGG
Pipework material	1.0038

Information for order placements

Weight approx.	476 kg
Item number	4189216

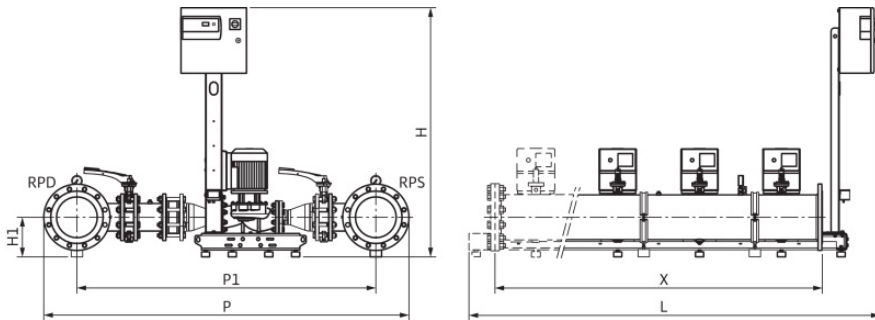

Dimensions

mm

DNd	DN 125, PN	P	1,580
DNs	DN 125, PN	P1	1,330
H	1,394	X	1,500
H1	209		
L	1,953		