

**Customer**

## Technical data

### High-pressure multistage centrifugal pump Helix V 1005-1/25/E/KS/400-50

Project ID                      Untitled project 2025-03-03 15:12:38.853

Project name  
Installation location  
Customer pos. No.

Date                      2025-03-03

#### Duty chart

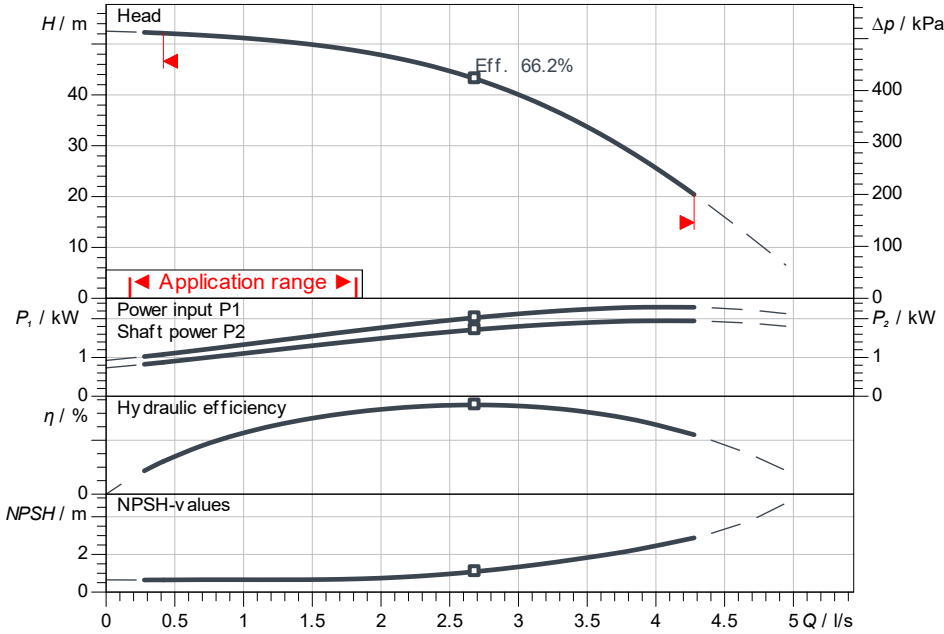

#### Requested data

Flow  
Head  
Media                      Water 100 %  
Fluid temperature                      20.00 °C  
Density                      998.30 kg/m<sup>3</sup>  
Kin. viscosity                      1.00 mm<sup>2</sup>/s

#### Hydraulic data (Duty point)

Flow  
Head  
Shaft power P2  
Hydraulic efficiency  
NPSH

#### Product data

High-pressure multistage centrifugal pump  
Helix V 1005-1/25/E/KS/400-50  
Max. operating pressure                      2,500 kPa  
Inlet pressure max.                      10 bar  
Fluid temperature                      -30 °C ... +120 °C  
Max. ambient temperature                      50 °C  
Minimum efficiency index (MEI)                      ≥ 0.7

#### Motordata per Motor/Pump

Motor efficiency level                      IE3  
Mains connection                      3~ 400 V / 50 Hz  
Permitted voltage tolerance                      + -10 %  
Max. speed                      2,900 1/min  
Rated power P2                      2.20 kW  
Rated current                      4.30 A  
Power factor                      0.87  
Service factor                      1.15  
Efficiency                      50% / 75% / 100%                      84.8/86.2/85.9%  
Degree of protection                      IP55  
Insulation class                      F  
Motor protection                      PTO

#### Fitting dimensions

Pipe connection on the suction side                      DN 40, PN 25  
Pipe connection (pressure side)                      DN 40, PN 25

#### Materials

Pump housing                      1.4301  
Impeller                      1.4307  
Shaft                      1.4301  
Shaft seal                      BQ7EGG  
Gasket material                      EPDM

#### Information for order placements

Weight approx.                      42 kg  
Item number                      4150545

ISO 9906: 2012 3B

#### Dimensions

H	834
H2	540
ØM	172
X	132
X	132

mm

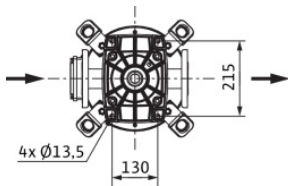

PN25

