

Customer

Technical data

High-pressure multistage centrifugal pump Helix FIRST V 3601-5/16/E/S/460-60

Project ID: Untitled project 2025-03-05 07:27:14.016

Project name
Installation location
Customer pos. No.

Date: 2025-03-05

Duty chart

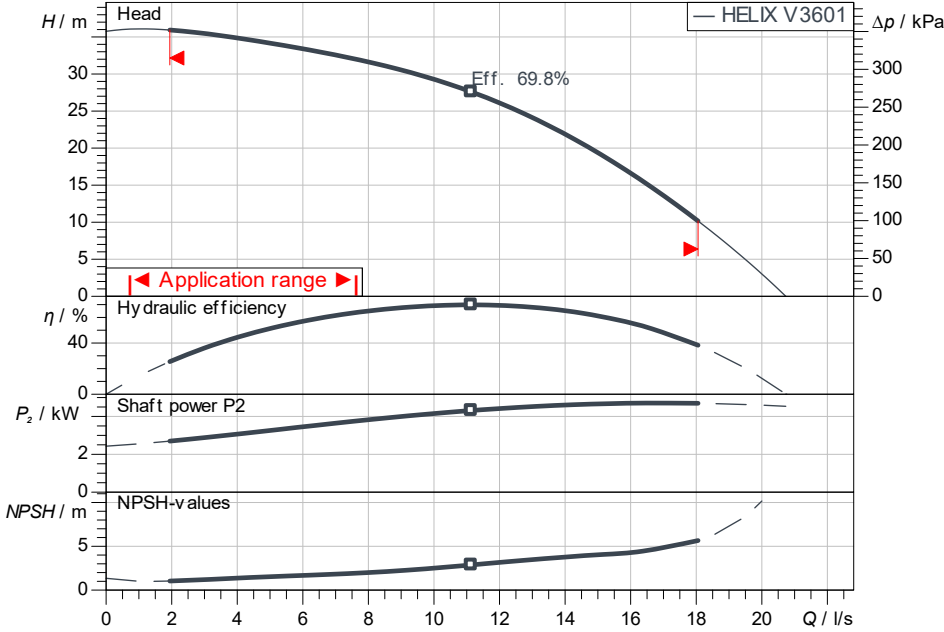

ISO 9906: 2012 3B

Dimensions

| | |
|----|-----|
| H | 755 |
| H2 | 419 |
| X | 163 |

mm

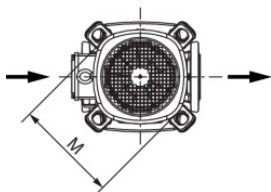
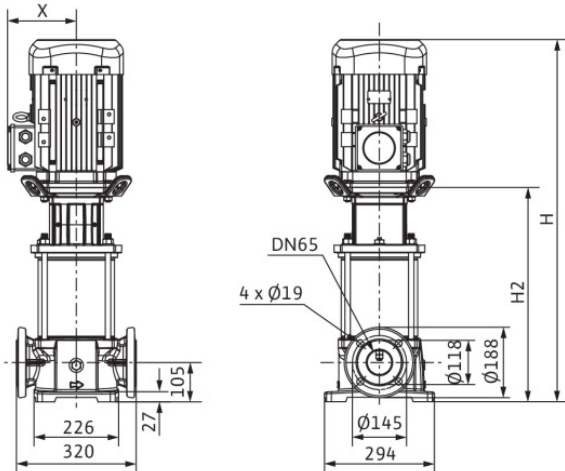
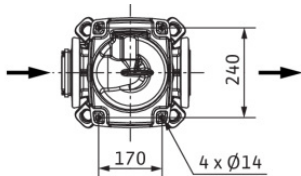

Requested data

| | |
|-------------------|--------------------------|
| Flow | |
| Head | |
| Media | Water 100 % |
| Fluid temperature | 20.00 °C |
| Density | 998.30 kg/m ³ |
| Kin. viscosity | 1.00 mm ² /s |

Hydraulic data (Duty point)

| | |
|----------------------|--|
| Flow | |
| Head | |
| Shaft power P2 | |
| Hydraulic efficiency | |
| NPSH | |

Product data

| | |
|---------------------------------------------------------------------------------|--------------------|
| High-pressure multistage centrifugal pump Helix FIRST V 3601-5/16/E/S/460-60 | |
| Max. operating pressure | 1,600 kPa |
| Inlet pressure max. | 10 bar |
| Fluid temperature | -20 °C ... +120 °C |
| Max. ambient temperature | 50 °C |
| Minimum efficiency index (MEI) | |

Motordata per Motor/Pump

| | |
|-----------------------------|------------------|
| Motor efficiency level | |
| Mains connection | 3~ 400 V / 60 Hz |
| Permitted voltage tolerance | + -10 % |
| Max. speed | 2,923 1/min |
| Rated power P2 | 5.50 kW |
| Rated current | 9.70 A |
| Power factor | 0.91 |
| Service factor | 1.15 |
| Efficiency | |
| 50% / 75% / 100% | 87.8/89.2/89.2% |
| Degree of protection | IP55 |
| Insulation class | |
| Motor protection | PTC |

Fitting dimensions

| | |
|-------------------------------------|--------------|
| Pipe connection on the suction side | DN 65, PN 16 |
| Pipe connection (pressure side) | DN 65, PN 16 |

Materials

| | |
|-----------------|-------------------|
| Pump housing | 5.1301/EN-GJL-250 |
| Impeller | 1.4307 |
| Shaft | 1.4057 |
| Shaft seal | BQ7EGG |
| Gasket material | EPDM |

Information for order placements

| | |
|----------------|---------|
| Weight approx. | 76 kg |
| Item number | 4200669 |