

Customer

Technical data

High-pressure multistage centrifugal pump Helix FIRST V 3605/1-5/25/E/KS/460-60

Project ID: Untitled project 2025-03-05 07:27:14.016

Project name
Installation location
Customer pos. No.

Date: 2025-03-05

Duty chart

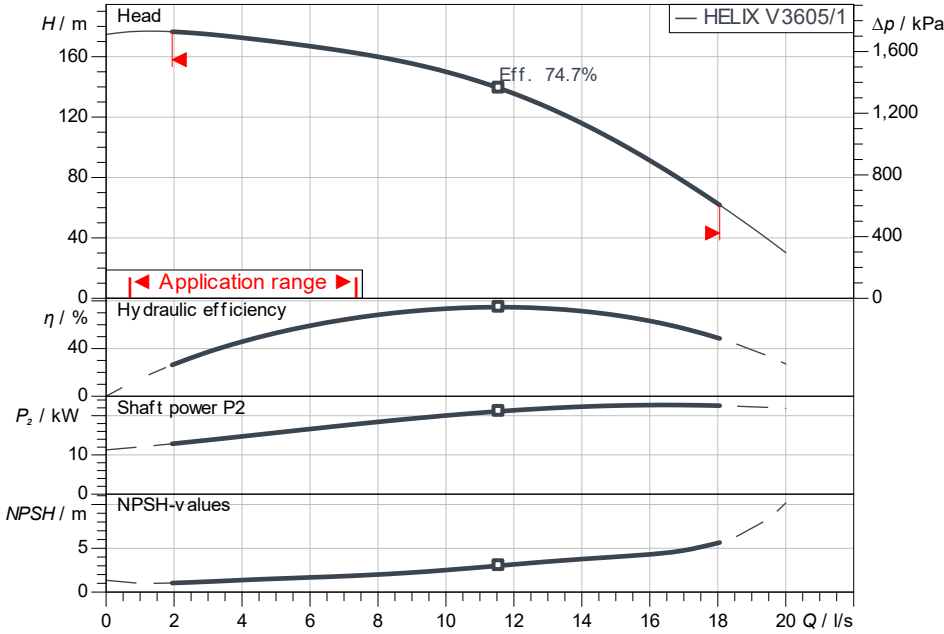

Requested data

Flow
Head
Media: Water 100 %
Fluid temperature: 20.00 °C
Density: 998.30 kg/m³
Kin. viscosity: 1.00 mm²/s

Hydraulic data (Duty point)

Flow
Head
Shaft power P₂
Hydraulic efficiency
NPSH

Product data

High-pressure multistage centrifugal pump
Helix FIRST V 3605/1-5/25/E/KS/460-60
Max. operating pressure: 2,500 kPa
Inlet pressure max.: 10 bar
Fluid temperature: -20 °C ... +120 °C
Max. ambient temperature: 50 °C
Minimum efficiency index (MEI)

Motordata per Motor/Pump

Motor efficiency level: IE3
Mains connection: 3~ 460 V / 60 Hz
Permitted voltage tolerance: +6 %
Max. speed: 3,560 1/min
Rated power P₂: 30.00 kW
Rated current: 45.80 A
Power factor: 0.9
Service factor: 1.15
Efficiency: 50% / 75% / 100% // %
Degree of protection: IP55
Insulation class: F
Motor protection: No

ISO 9906: 2012 3B

Dimensions

H	1,48
H2	885
ØM	347
X	255
X	255

mm

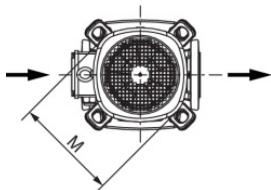
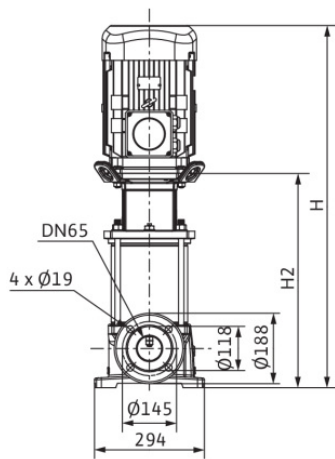
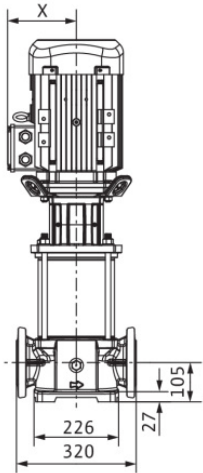
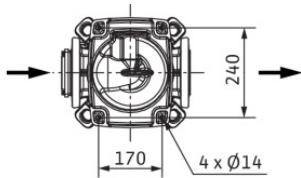

Fitting dimensions

Pipe connection on the suction side: DN 65, PN 25
Pipe connection (pressure side): DN 65, PN 25

Materials

Pump housing: 5.1301/EN-GJL-250
Impeller: 1.4307
Shaft: 1.4057
Shaft seal: BQ7EGG
Gasket material: EPDM

Information for order placements

Weight approx.: 251 kg
Item number: 4200680