

**Customer**

## Technical data

### Multi-pump system

#### SiFlux 21-IL-E 80/170-15/2-SC-16-T4

Project ID: Untitled project 2025-03-17 06:38:35.502

Project name  
Installation location  
Customer pos. No.

Date: 2025-03-17

### Duty chart

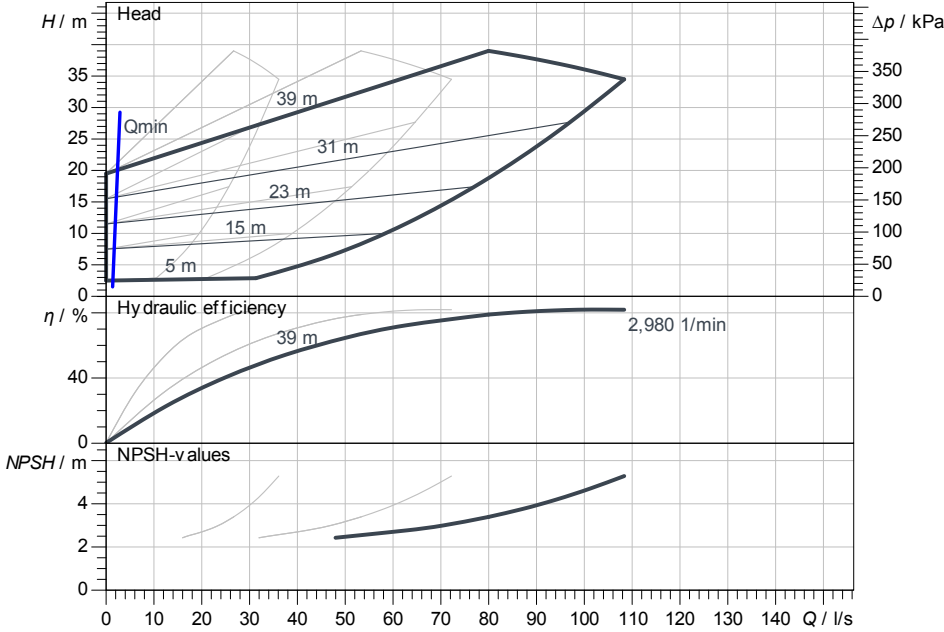

### Requested data

Flow	
Head	
Media	Water 100 %
Fluid temperature	20.00 °C
Density	998.30 kg/m <sup>3</sup>
Kin. viscosity	1.00 mm <sup>2</sup> /s

### Hydraulic data (Duty point)

Flow	
Head	
Power input P1	
NPSH	

### Product data

Multi-pump system	
SiFlux 21-IL-E 80/170-15/2-SC-16-T4	
No. of pumps	3
Standby pump	No
Kind of operation	dp-v
Max. operating pressure	1,600 kPa
Fluid temperature	0 °C ... + 100 °C
Max. ambient temperature	40 °C

### Motordata per Motor/Pump

Motor design	Standard motor
Efficiency class	IE4
Mains connection	3~ 400 V / 50 Hz
Permitted voltage tolerance	+/- 10 %
Max. speed	2,900 1/min
Rated power P2	15.00 kW
Power consumption	
Rated current	28.30 A
Degree of protection	IP55
Insulation class	F
Motor protection	

### Fitting dimensions

Pipe connection on the suction side	DN 250, PN 16
Pipe connection (pressure side)	DN 250, PN 16

### Materials

Pump housing	5.1301, EN-GJL-250 c
Impeller	EN-GJL-200
Shaft seal	AQ1EGG
Pipework material	1.0038

### Information for order placements

Weight approx.	1335 kg
Item number	4189236

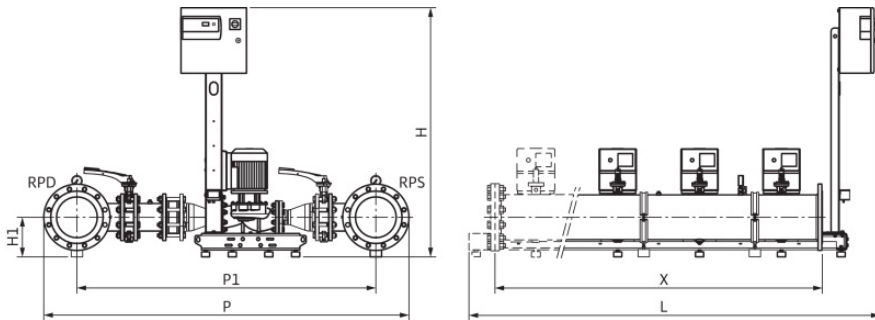

### Dimensions

	mm		
DNd	DN 250, PN	P	2,315
DNs	DN 250, PN	P1	1,910
H	1,730	X	1,500
H1	269		
L	1,965		