



Contact  
E-mail  
Phone

Customer

Contact  
E-mail  
Phone

## Technical data

### KS 15GG With motor F 12.1-2/9

Project ID                      Untitled project 2025-03-05 07:27:14.016  
Project name  
Installation location  
Customer pos. No.

Date    2025-03-05

#### Pump

Pump type	KS 15GG
Installation type	Transportable
Free passage	10 mm
Nominal speed	3480
Rated frequency	60 Hz
Impeller type	Multi-channel
Impeller construction	Open

#### Impeller Ø

max. possible	109 mm
min. possible	109 mm
standard	109
designed	109 mm

#### Suction port

Rated diameter	
Pressure rating	
Standard	

#### Discharge port

Rated diameter	G2
Pressure rating	PN10
Standard	EMU-D

#### Weights

Weight	max.
Weight of motor	18 kg
Weight of unit	max. 22.5 kg

#### Materials

Pump housing	EN-GJL-250
Impeller	EN-GJL-250
Motor housing	EN-GJL-250

#### Motor

Motor name	F 12.1-2/9
Number of poles	2
Rated power	1.5 kW
Rated speed	3420 1/min
Power input with rated power	2.1 kW
Rated voltage	115 ~3 V
Current input with rated power	12.5 A
Efficiency with rated power	70 %
cos phi with rated power	0.86
cos phi with starting	0
Rated frequency	60 Hz
Operation type wet	S1
Operation type dry	S1
Starting current, direct starting	64 A
Starting current, star-delta	21.3 A
Starting torque	9 Nm
Inertia moment	0.001 kg m <sup>2</sup>
Degree of protection	IP 68
Sel. explosion protection	
Ex-designation	
Ex-number	
Motor connection cable	4G1,5 H07RN
Max. fluid temperature	40 °C
Starts per hour max.	15

#### Duty point data

Volume flow	
Head	
Shaft power P <sub>2</sub>	
Hydr. efficiency η <sub>hyd.</sub>	
Power input P <sub>1</sub>	
Fluid	Water
Required pump NPSH	
Rotational speed	3,428 1/min
Total efficiency	$= \frac{P_2 * \text{Hydr. efficiency } \eta_{\text{hyd.}}}{P_1}$

#### Weights

Submersible contractor's pump as single stage block unit for stationary, vertical installation, for pumping muddy water which does not attack the pump materials neither chemically nor mechanically.

Service friendly design of the unit by separate pump and motor.

Pumping values to be guaranteed according to ISO 9906 Annex A

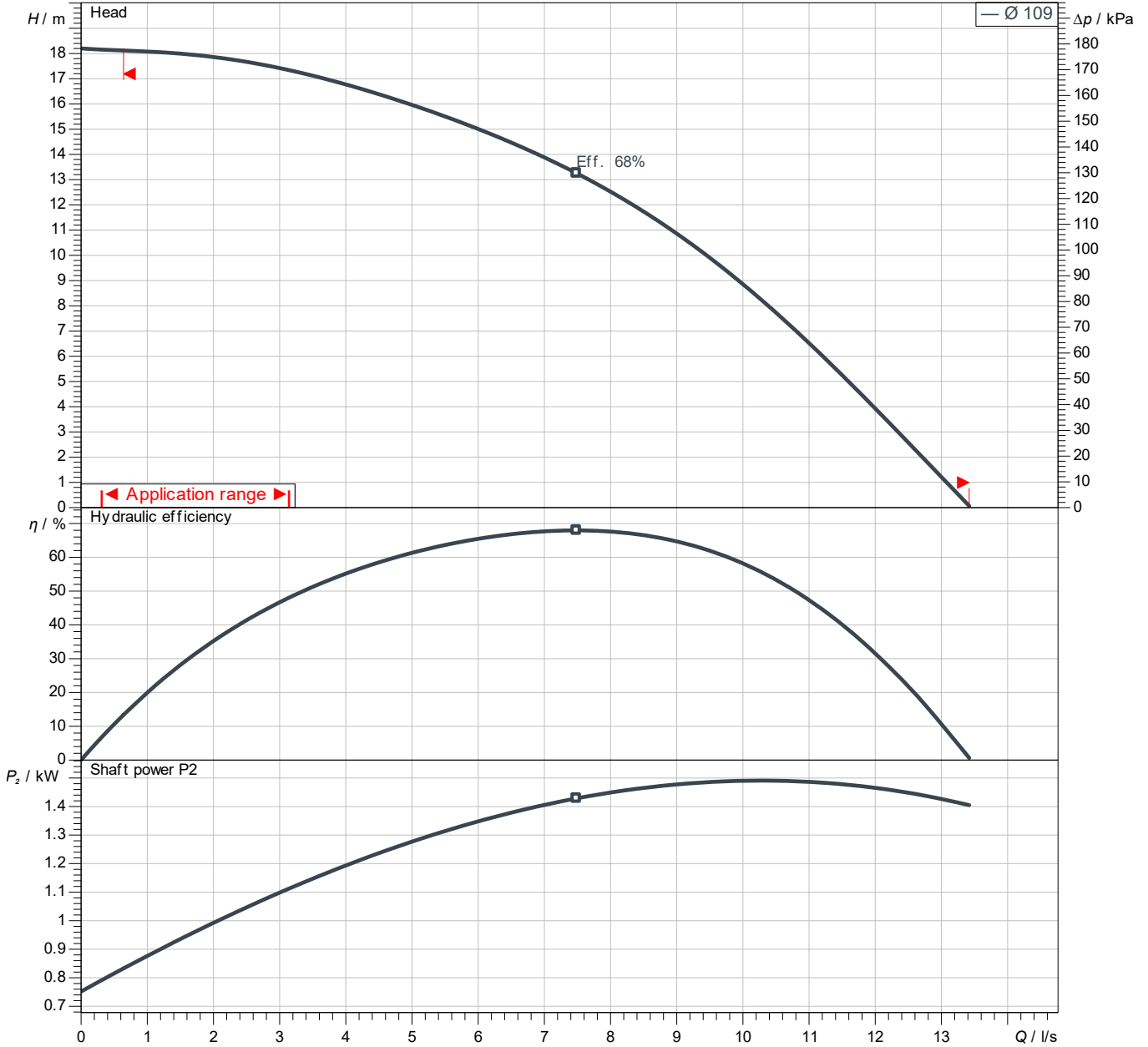

Power data referred to:                      Water; 20°C; 998.3kg/m<sup>3</sup>; 1.005mm<sup>2</sup>/s  
Tolerance as per ISO 9906 / Annex A.2

**Pump**

Impeller Ø	designed	109 mm
Nominal speed		3,420 1/min
Frequency		60 Hz
Impeller type		Multi-channel

**Motor**

Rated power	1.5 kW
Sel. explosion protection	

**Duty point data**

Volume flow	
Head	
Shaft power P <sub>2</sub>	
Hydr. efficiency η <sub>hyd</sub> .	
Power input P <sub>1</sub>	
Required pump NPSH	
Rotational speed	3428 1/min

Contact  
E-mail  
Phone

Customer

Contact  
E-mail  
Phone

## Dimensions

**KS 15GG**  
With motor  
**F 12.1-2/9**

Project ID                      Untitled project 2025-03-05 07:27:14.016  
Project name  
Installation location  
Customer pos. No.

Date    2025-03-05

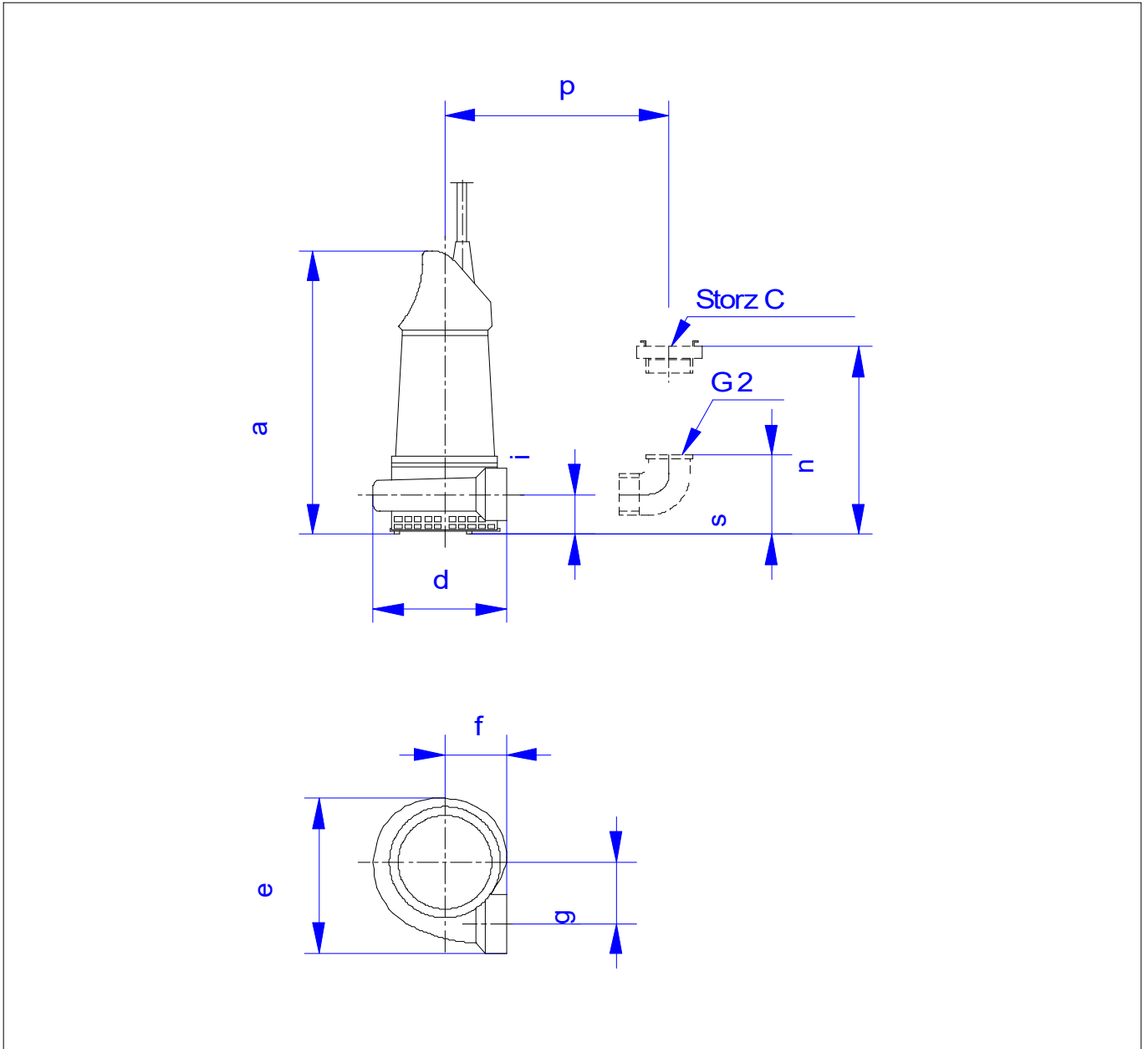

### Dimensions

Name	Value
a	415 mm
d	195 mm
e	227 mm
f	90 mm
g	90 mm
i	58 mm
n	135 mm
p	140 mm
s	116 mm

### Connections

Name	Value
Suction port	
Discharge port	G2 PN10