

Customer

Technical data

High-pressure multistage centrifugal pump Helix V 1010-1/25/E/KS/460-60

Project ID: Untitled project 2025-03-05 07:27:14.016

Project name
Installation location
Customer pos. No.

Date: 2025-03-05

Duty chart

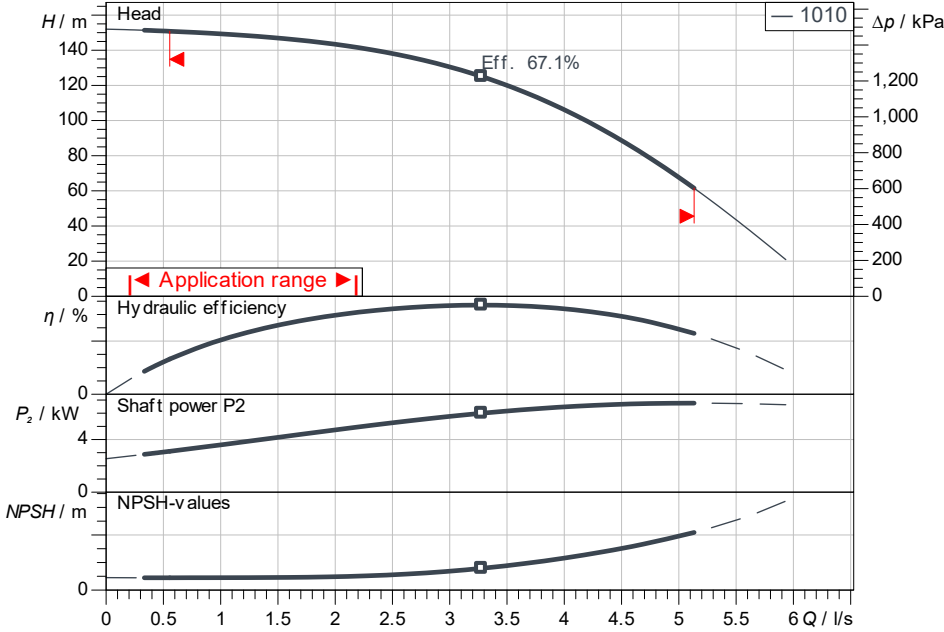

Requested data

Flow
Head
Media: Water 100 %
Fluid temperature: 20.00 °C
Density: 998.30 kg/m³
Kin. viscosity: 1.00 mm²/s

Hydraulic data (Duty point)

Flow
Head
Shaft power P₂
Hydraulic efficiency
NPSH

Product data

High-pressure multistage centrifugal pump
Helix V 1010-1/25/E/KS/460-60
Max. operating pressure: 2,500 kPa
Inlet pressure max.: 10 bar
Fluid temperature: -30 °C ... +120 °C
Max. ambient temperature: 50 °C
Minimum efficiency index (MEI)

Motordata per Motor/Pump

Motor efficiency level
Mains connection: 3~ 400 V / 60 Hz
Permitted voltage tolerance: +10 %
Max. speed: 2,923 1/min
Rated power P₂: 7.50 kW
Rated current: 13.80 A
Power factor: 0.87
Service factor: 1.15
Efficiency: 50% / 75% / 100% → 89.6/90.5/90.1%
Degree of protection: IP55
Insulation class
Motor protection: PTC

Fitting dimensions

Pipe connection on the suction side: DN 40, PN 25
Pipe connection (pressure side): DN 40, PN 25

Materials

Pump housing: 1.4301
Impeller: 1.4307
Shaft: 1.4301
Shaft seal: BQ7EGG
Gasket material: EPDM

Information for order placements

Weight approx.: 66 kg
Item number: 4192455

ISO 9906: 2012 3B

Dimensions

H: 1,24
H2: 857
X: 196

mm

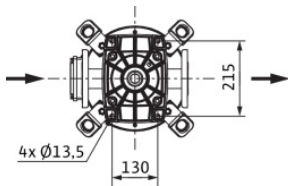

PN25

