

Customer

Technical data

High-pressure multistage centrifugal pump Helix V 1019-1/25/E/KS/400-50

Project ID Untitled project 2025-03-03 15:12:38.853

Project name
Installation location
Customer pos. No.

Date 2025-03-03

Duty chart

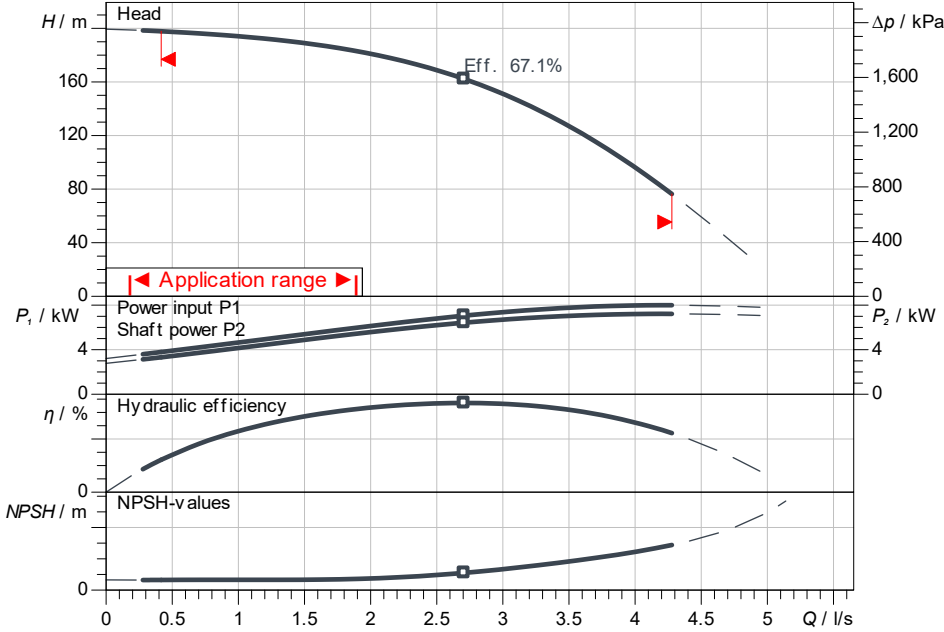

Requested data

Flow
Head
Media Water 100 %
Fluid temperature 20.00 °C
Density 998.30 kg/m³
Kin. viscosity 1.00 mm²/s

Hydraulic data (Duty point)

Flow
Head
Shaft power P2
Hydraulic efficiency
NPSH

Product data

High-pressure multistage centrifugal pump
Helix V 1019-1/25/E/KS/400-50
Max. operating pressure 2,500 kPa
Inlet pressure max. 10 bar
Fluid temperature -30 °C ... +120 °C
Max. ambient temperature 50 °C
Minimum efficiency index (MEI) ≥ 0.7

Motordata per Motor/Pump

Motor efficiency level IE3
Mains connection 3~ 400 V / 50 Hz
Permitted voltage tolerance + -10 %
Max. speed 2,900 1/min
Rated power P2 7.50 kW
Rated current 13.70 A
Power factor 0.88
Service factor 1.15
Efficiency 50% / 75% / 100% 89.8/90.5/90.1%
Degree of protection IP55
Insulation class F
Motor protection No

Fitting dimensions

Pipe connection on the suction side DN 40, PN 25
Pipe connection (pressure side) DN 40, PN 25

Materials

Pump housing 1.4301
Impeller 1.4307
Shaft 1.4301
Shaft seal BQ7EGG
Gasket material EPDM

Information for order placements

Weight approx. 75 kg
Item number 4150567

ISO 9906: 2012 3B

Dimensions

H 1,58
H2 1,23
ØM 225
X 191
X 160

mm

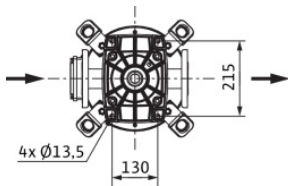

PN25

