

Customer

Technical data

Multi-pump system

SiFlux 31-IL-E 65/160-7,5/2-SC-16-T4

Project ID: Untitled project 2025-03-17 06:38:35.502

Project name
Installation location
Customer pos. No.

Date: 2025-03-17

Duty chart

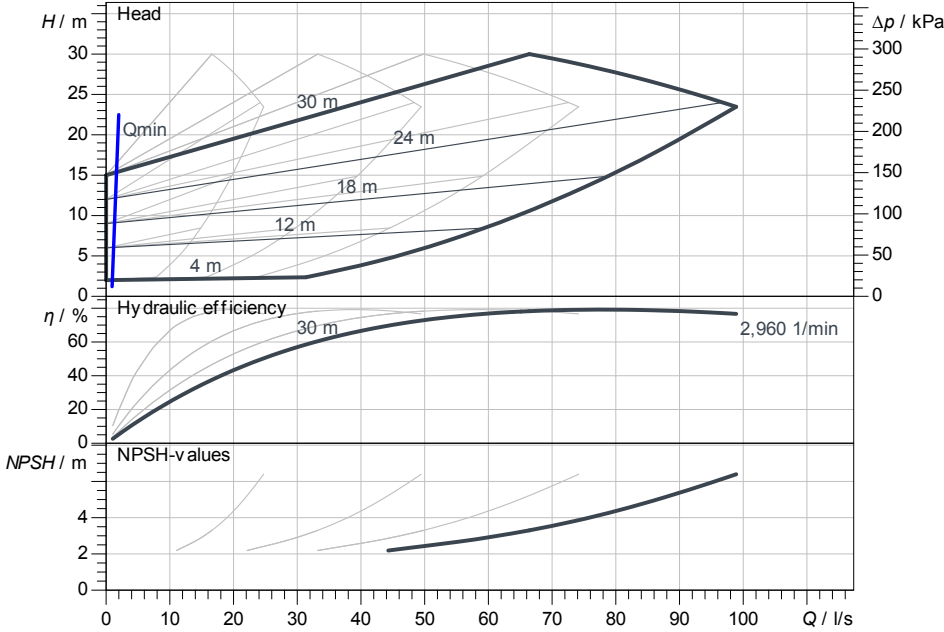

Requested data

Flow
Head
Media: Water 100 %
Fluid temperature: 20.00 °C
Density: 998.30 kg/m³
Kin. viscosity: 1.00 mm²/s

Hydraulic data (Duty point)

Flow
Head
Power input P1
NPSH

Product data

Multi-pump system
SiFlux 31-IL-E 65/160-7,5/2-SC-16-T4
No. of pumps: 4
Standby pump: No
Kind of operation: dp-v
Max. operating pressure: 1,600 kPa
Fluid temperature: 0 °C ... + 100 °C
Max. ambient temperature: 40 °C

Motordata per Motor/Pump

Motor design: Standard motor
Efficiency class: IE4
Mains connection: 3~ 400 V / 50 Hz
Permitted voltage tolerance: +-10 %
Max. speed: 2,900 1/min
Rated power P2: 7.50 kW
Power consumption
Rated current: 13.20 A
Degree of protection: IP55
Insulation class: F
Motor protection

Fitting dimensions

Pipe connection on the suction side: DN 250, PN 16
Pipe connection (pressure side): DN 250, PN 16

Materials

Pump housing: 5.1301, EN-GJL-250
Impeller: EN-GJL-200
Shaft seal: AQ1EGG
Pipework material: 1.0038

Information for order placements

Weight approx.: 1326 kg
Item number: 4189233

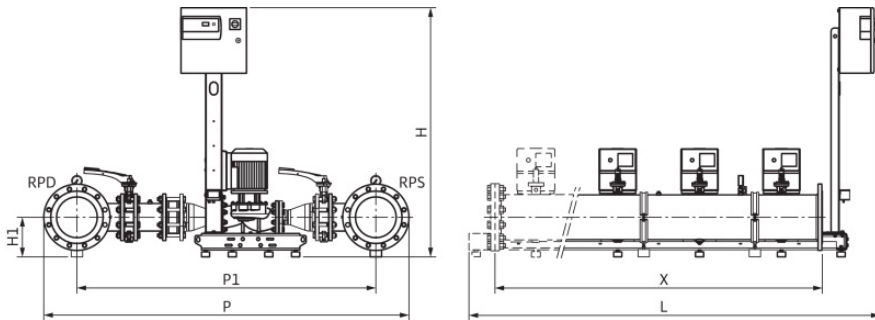

Dimensions

mm

DNd	DN 250, PN	P	2,259
DNs	DN 250, PN	P1	1,854
H	1,409	X	2,000
H1	259		
L	2,453		