



Contact
E-mail
Phone

Customer

Contact
E-mail
Phone

Technical data

FA 15.77RFZ

With motor
T 30-6/28K

Project ID Untitled project 2025-03-03 12:23:22.030
Project name
Installation location
Customer pos. No.

Date 2025-03-03

Pump

Pump type	FA 15.77RFZ
Installation type	Suspension device DN150S/2RK
Free passage	80 mm
Nominal speed	950 1/min
Rated frequency	50 Hz
Impeller type	Two-channel
Impeller construction	Closed

Impeller size

max. possible	410 mm
min. possible	310 mm
standard	410 mm
designed	410 mm

Suction port

Rated diameter	DN200
Pressure rating	PN10
Standard	EN1092-2-S

Discharge port

Rated diameter	DN150
Pressure rating	PN10
Standard	EN1092-2-D

Weights

Weight	max. 263 kg
Weight of motor	416 kg
Weight of unit	max. 679 kg

Materials

Pump housing	1.4581
Stationary wear ring	1.4462/1.4470
Impeller	1.4581
Mobile wear ring	1.4462/1.4470

Motor

Motor name	T 30-6/28K
Number of poles	6
Rated power	30 kW
Rated speed	970 1/min
Power input with rated power	33.7 kW
Rated voltage	380 ~3 V
Current input with rated power	62.5 A
Efficiency with rated power	89 %
cos phi with rated power	0.82
cos phi with starting	0
Rated frequency	50 Hz
Operation type wet	S1
Operation type dry	-
Starting current, direct starting	350 A
Starting current, star-delta	116.7 A
Starting torque	755 Nm
Inertia moment	0.356 kg m ²
Degree of protection	IP 68
Sel. explosion protection	
Ex-designation	
Ex-number	
Motor connection cable	4x10 + 2x1,5 NSSHÖ U
Max. fluid temperature	40 °C
Starts per hour max.	15

Duty point data

Volume flow	
Head	
Shaft power P ₂	
Hydr. efficiency η _{hyd.}	
Power input P ₁	
Fluid	Water
Required pump NPSH	
Rotational speed	973.7 1/min
Total efficiency	$= \frac{P_2 * \text{Hydr. efficiency } \eta_{\text{hyd.}}}{P_1}$



Contact
E-mail
Phone

Customer

Contact
E-mail
Phone

Performance curves

FA 15.77RFZ

With motor
T 30-6/28K

Project ID: Untitled project 2025-03-03 12:23:22.030
Project name
Installation location
Customer pos. No.

Date 2025-03-03

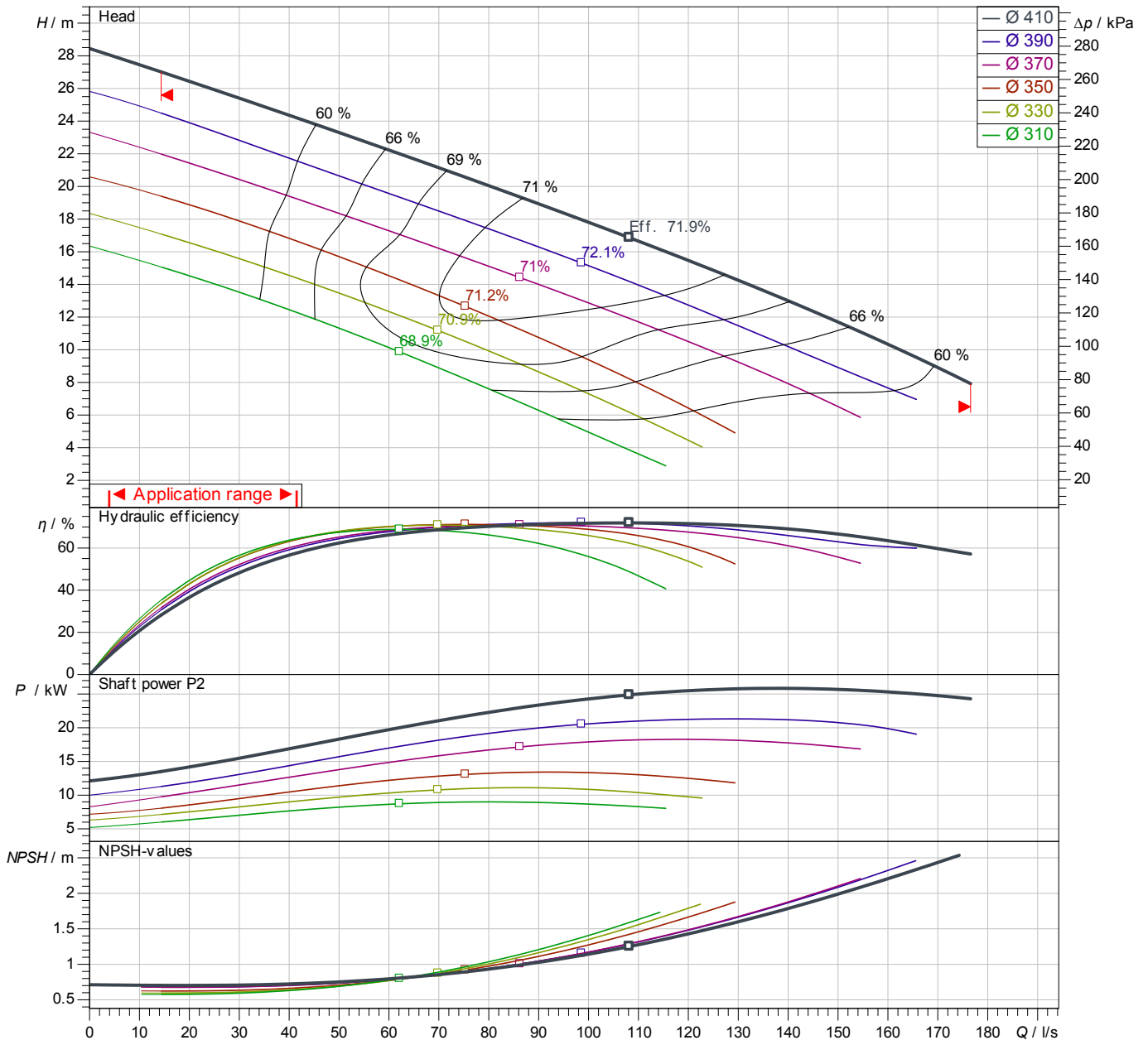

Power data referred to: Water; 20°C; 998.3kg/m³; 1.005mm²/s
Tolerance as per ISO 9906 / Annex A.2

Pump

Impeller Ø designed 410 mm
Nominal speed 970 1/min
Frequency 50 Hz
Impeller type Two-channel

Motor

Rated power 30 kW
Sel. explosion protection

Duty point data

Volume flow
Head
Shaft power P2
Hydr. efficiency η hyd.
Power input P1
Required pump NPSH
Rotational speed 974 1/min

Dimensions

FA 15.77RFZ

With motor T 30-6/28K

Project ID Untitled project 2025-03-03 12:23:22.030

Project name

Installation location

Customer pos. No.

Date 2025-03-03

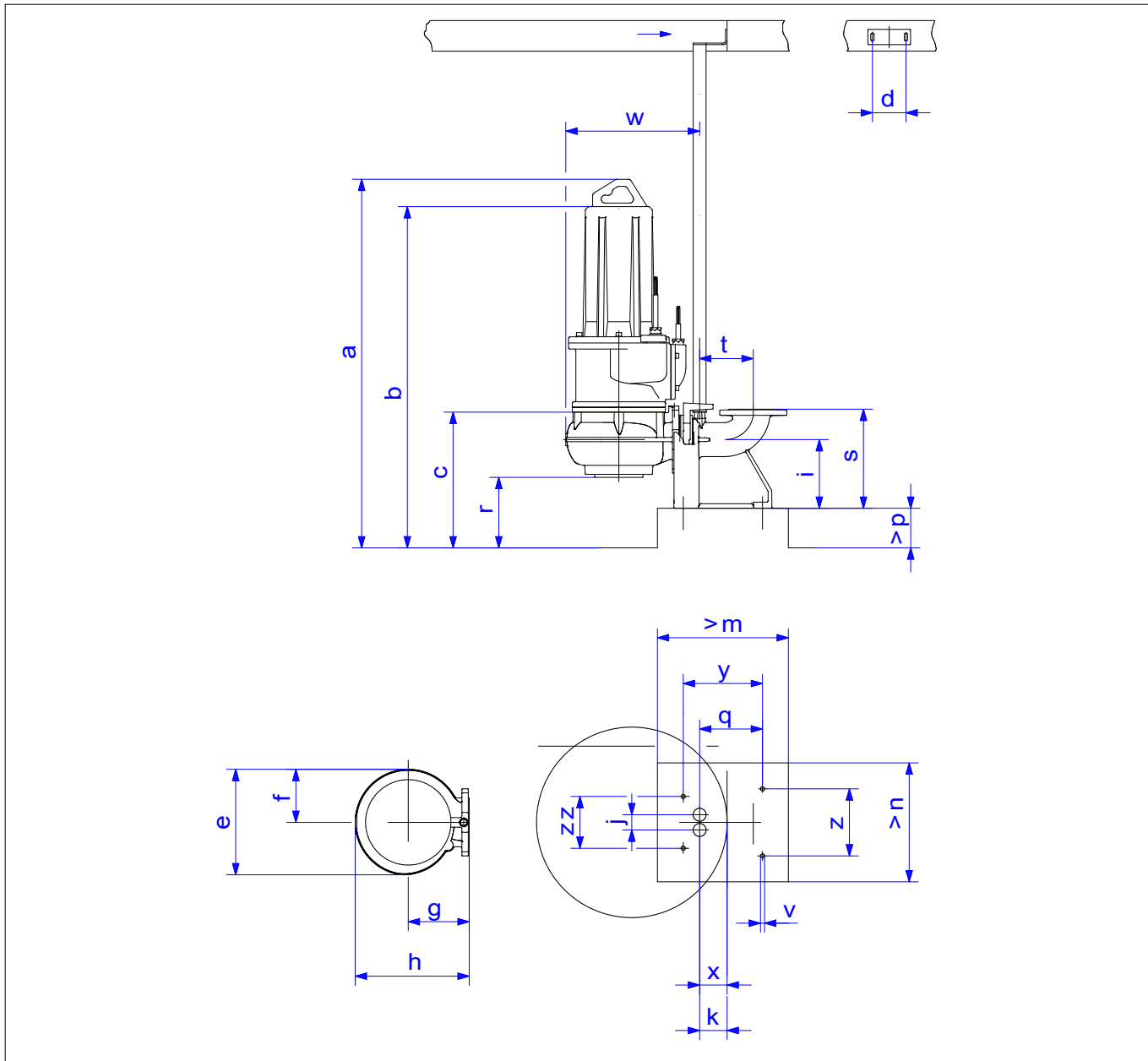

Dimensions

Name	Value	Name	Value
a	1,512 mm	p	70 mm
b = min. water level	1,258 mm	q	291 mm
c	490 mm	r	200 mm
d	230 mm	s	540 mm
e	620.7 mm	t	241 mm
f	326.3 mm	v	19 mm
g	450 mm	w	850.3 mm
h	761.3 mm	x	120 mm
i	320 mm	y	420 mm
j	140 mm	z	280 mm

Connections

Suction port	DN200 PN10
Discharge port	DN150 PN10
Suspension device	DN150S/2RK