



Contact
E-mail
Phone

Customer

Contact
E-mail
Phone

Technical data

KS 14GG With motor F 12.1-2/6

Project ID Untitled project 2025-03-30 11:56:43.919
Project name
Installation location
Customer pos. No.

Date 2025-03-30

Pump

Pump type	KS 14GG
Installation type	Transportable
Free passage	10 mm
Nominal speed	2900
Rated frequency	50 Hz
Impeller type	Multi-channel
Impeller construction	Open

Impeller Ø

max. possible	103 mm
min. possible	103 mm
standard	103
designed	103 mm

Suction port

Rated diameter	
Pressure rating	
Standard	

Discharge port

Rated diameter	G2
Pressure rating	PN10
Standard	EMU-D

Weights

Weight	max.
Weight of motor	11 kg
Weight of unit	max. 19 kg

Materials

Pump housing	EN-GJL-250
Impeller	EN-GJL-250
Motor housing	EN-GJL-250

Motor

Motor name	F 12.1-2/6
Number of poles	2
Rated power	0.75 kW
Rated speed	2850 1/min
Power input with rated power	1.1 kW
Rated voltage	400 ~3 V
Current input with rated power	1.9 A
Efficiency with rated power	68 %
cos phi with rated power	0.85
cos phi with starting	
Rated frequency	50 Hz
Operation type wet	S1
Operation type dry	S1
Starting current, direct starting	9 A
Starting current, star-delta	3 A
Starting torque	5 Nm
Inertia moment	0.0007 kg m ²
Degree of protection	IP 68
Sel. explosion protection	
Ex-designation	
Ex-number	
Motor connection cable	4G1,5 H07RN
Max. fluid temperature	40 °C
Starts per hour max.	15

Duty point data

Volume flow	
Head	
Shaft power P ₂	
Hydr. efficiency η _{hyd.}	
Power input P ₁	
Fluid	Water
Required pump NPSH	
Rotational speed	2,857 1/min
Total efficiency	$= \frac{P_2 * \text{Hydr. efficiency } \eta_{\text{hyd.}}}{P_1}$

Weights

Submersible contractor's pump as single stage block unit for stationary, vertical installation, for pumping muddy water which does not attack the pump materials neither chemically nor mechanically.

Service friendly design of the unit by separate pump and motor.

Pumping values to be guaranteed according to ISO 9906 Annex A

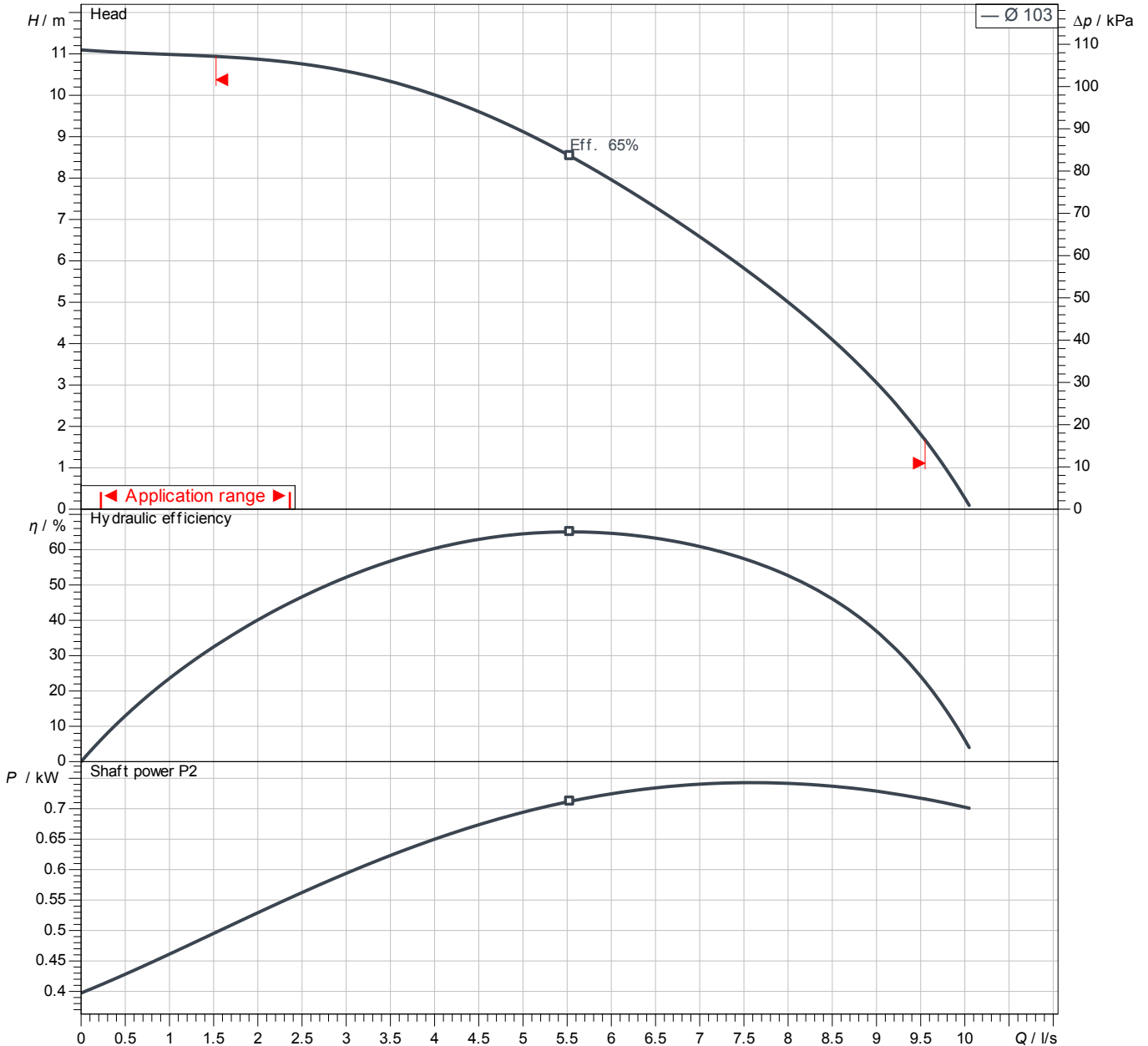

Power data referred to: Water; 20°C; 998.3kg/m³; 1.005mm²/s
Tolerance as per ISO 9906 / Annex A.2

Pump

Impeller Ø	designed	103 mm
Nominal speed		2,850 1/min
Frequency		50 Hz
Impeller type		Multi-channel

Motor

Rated power	0.75 kW
Sel. explosion protection	

Duty point data

Volume flow	
Head	
Shaft power P2	
Hydr. efficiency η hyd.	
Power input P1	
Required pump NPSH	
Rotational speed	2857 1/min

Dimensions

KS 14GG
With motor
F 12.1-2/6

Project ID Untitled project 2025-03-30 11:56:43.919
Project name
Installation location
Customer pos. No.

Date 2025-03-30

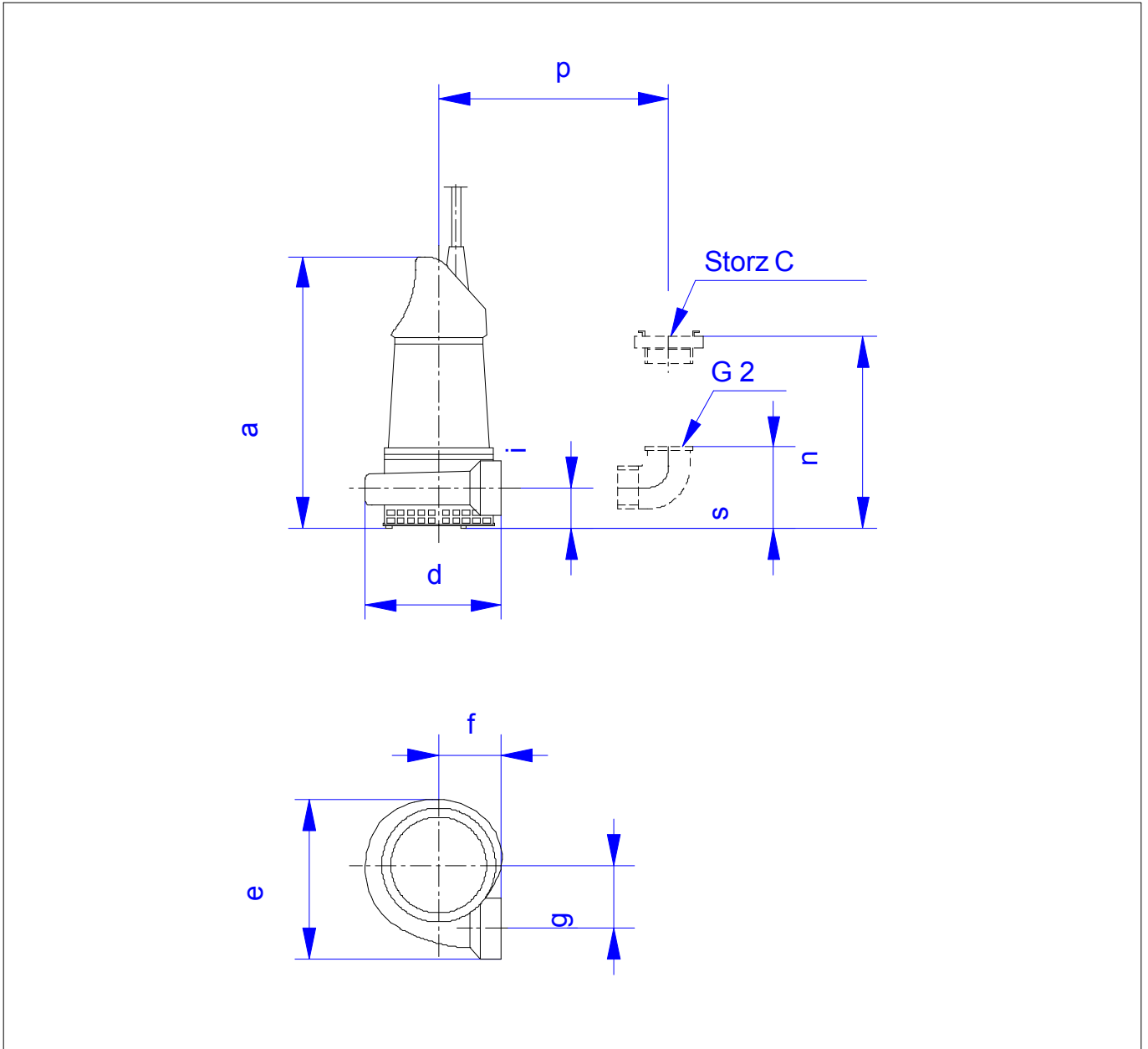

Dimensions

Name	Value	Name	Value
a	388 mm		
d	195 mm		
e	227 mm		
f	90 mm		
g	90 mm		
i	58 mm		
n	135 mm		
p	140 mm		
s	116 mm		

Connections

Suction port	
Discharge port	G2 PN10