

ESHS 32-250/75/P25VSSA

Technical data

Company name
Contact
Phone number
e-mail address

Operating data					
1	Pumpe type	Single head pump		Fluid	Water, pure
2	No. of pumps	1		Operating temperature t A	°C 4
3	Nominal flow	m ³ /h	0	Max / Min Operating Temperature mech. Seal	°C 120 / -10
4	Nominal head	m	0	pH-value at t A	7
5	Static head	m	0	Density at t A	kg/m ³ 1000
6	Inlet pressure	kPa	0	Kin. viscosity at t A	mm ² /s 1.569
7	Environmental temperature	°C	20	Vapor pressure at t A	kPa 100
8	Available system NPSH	m	0	Altitude	0

Pump data					
9	Lubrication	Standard, Grease lubrication [Std]			
10	Execution				
11	Design	Horizontal		Impeller Ø	Max. mm 244
12	Operating speed	2900 rpm	Stages 1		designed mm 223
13	Suction nozzle	DN 50 /	PN 16 / EN1092-1		Min. mm 203
14	Discharge nozzle	DN 32 /	PN 16 / EN1092-1	Flow	Nominal m ³ /h
15	Max. casing pressure	kPa	1200		Max- m ³ /h 26.9
16	Max. working pressure	kPa	652.2	Min- m ³ /h 7.9	
17	Impeller type	Radial impeller		Head	Nominal m
18	Head H(Q=0)	m	66		at Qmax m 48.8
19	Max. shaft power	kW	7.1	Shaft power kW	at Qmin m 65.2
20	Pump weight	kg		Efficiency %	
21	Total weight	kg	91.0	NPSH 3%	m

Materials					
22		Pump		Shaft Seal	
23	Pump body	Stainless steel / AISI 316L		Single mechanical seal, without shaft sleeve	
24	Impeller	Stainless steel / AISI 316L		Uniten 3K	VBVGG
25	SEAL HOUSING	Stainless steel / AISI 316L		Mechanical seal diameter 22 mm	
26	Wear ring	Stainless steel / AISI 316L		1. Rotating ring	Ceramic
27	Counterwear ring	Stainless steel / AISI 316L		2. Stationary ring	Carbon graphite resin impregnated
28	Rigid shaft coupling	Stainless steel / AISI 316L		3. Secondary seal	Fluorine rubber (FKM)
29	Impeller locknut and washer	Stainless steel / AISI 316		4. Springs	CrNiMo - Steel
30	Tab	Stainless steel / AISI 316L		5. Others	CrNiMo - Steel
31	Fill/drain plugs	Stainless steel / AISI 316		Gaskets of the pump	Fluorine rubber (FKM)
32					
33					
34					
35					
36					
37					
38					
39					
40					
41					

Motor data					
Electrical and dimensional data refer to IE3 motor					
42	Manufacturer	Lowara PLM			
43	Specific design	IE3 3ph Flange Motor - Premium Efficiency			
44	Type	PLM 132 B5 7,5 kW			
45	Rated power	7.5 kW	Rated current	14.1 A	
46	Nominal speed	2920 rpm	Rated voltage	400 V	
47	Frame size	132	Service factor	1	
48	Weight	kg 56.0	Degree of protection	IP55	

Remarks					
49					
50					
50					
52					

ESHS 32-250/75/P25VSSA

Performance curve

Company name
Contact
Phone number
e-mail address

	Ø mm	Pump capacity			Pump head		Shaft power P2			Frequency	Hz	
		Min. m³/h	Max. m³/h	η Max. m³/h	H(Q=0) m	η Max. m	P2(Q=0) kW	Max. kW	η Max. kW	Operating speed	rpm	
actual	223	7.86	26.9	24.1	66.5	52.7		7.11	6.83	Nominal flow	m³/h	0
Min.	0	/	/	21.7	53.7	42.6		/	4.97	Nominal head	m	0
Max.	244	/	/	27.6	83.3	65.1		/	9.64	Inlet pressure	kPa	0
										Static head	m	0

Power datas referred to:

hydr. Performance acceptance acc. To EN ISO 9906 Class Grade 3B

Water, pure [100%] ; 4°C; 1000kg/m³; 1.57mm²/s

MEI: N.A - according to Ecodesign Directive 2009/125/EC and Regulation (EU) No.547/2012

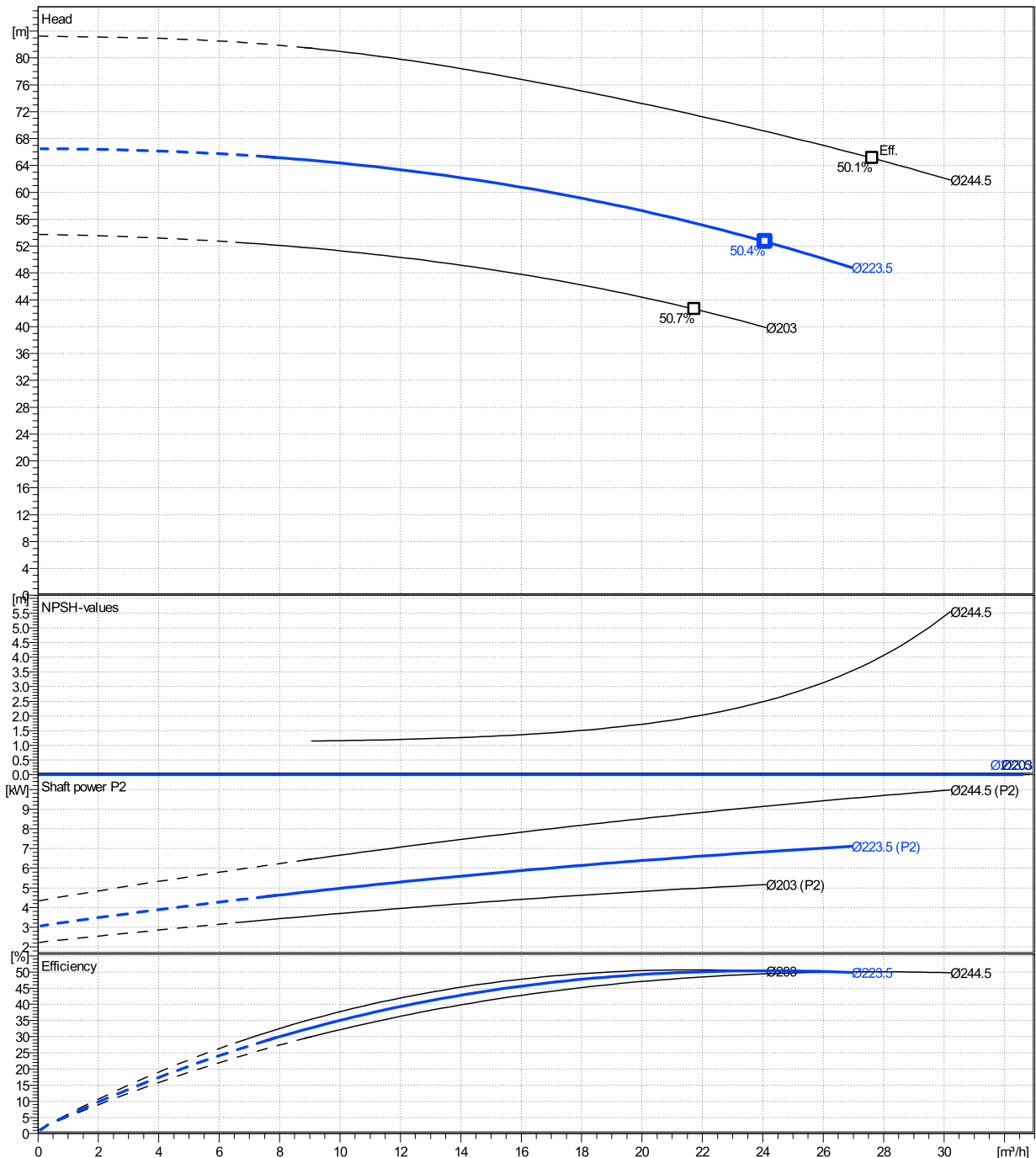

ESHS 32-250/75/P25VSSA

Dimensions

Company name
Contact
Phone number
e-mail address

Rigid coupling

PLM 132 B5 7,5 kW

Electrical and dimensional data refer to IE3 motor

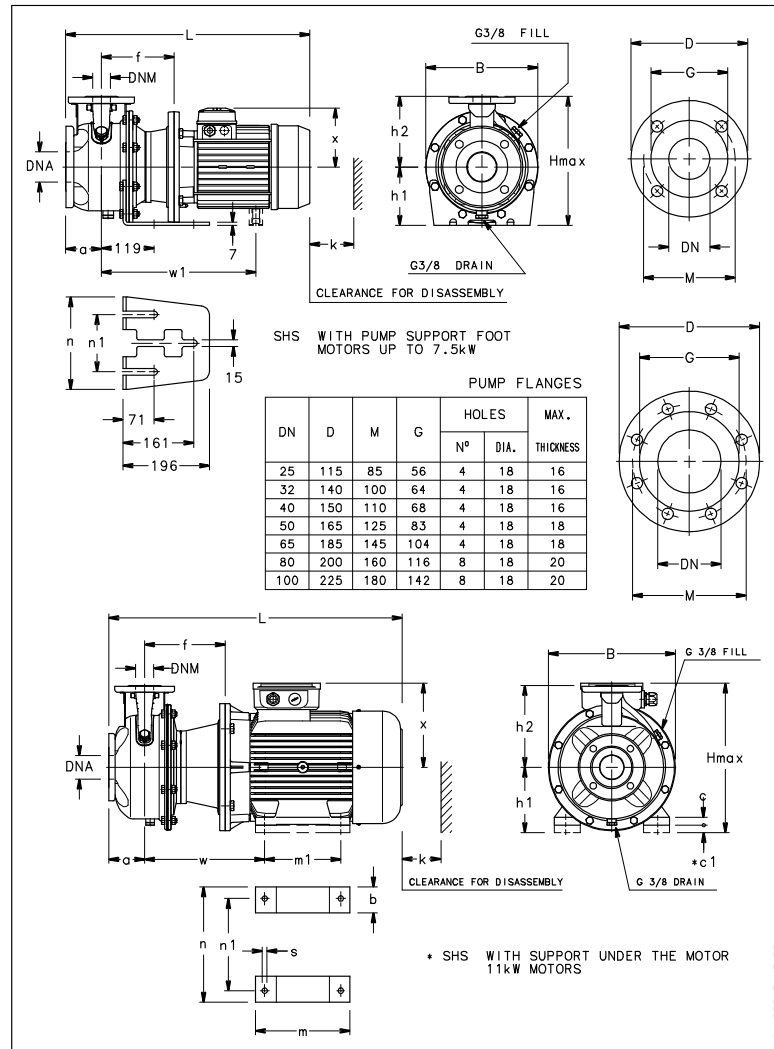

Dimensions		[mm]	
a	100		
B	345		
DNA	50		
DNM	32		
f	192		
h1	180		
h2	225		
Hmax	405		
k	98		
L	659		
n	265		
n1	130		
w1	397		
x	191		

Weight	
Total weight	91 kg

Connections			
Suction nozzle		Discharge nozzle	
DN 50		DN 32	
PN 16		PN 16	
EN1092-1		EN1092-1	
D	165	D	140
Dia. Holes	18	Dia. Holes	18
DN	50	DN	32
G	83	G	64
M	125	M	100
Max thickness	16	Max thickness	16

Dimensions and weight without obligation

Project Xylect-20117698
Block ESHS 32-250/110/P25VSSA

Created by
Created on 12/18/2024

Last update 12/18/2024