

# ESHS 40-250/110/P25VSSA

## Technical data

Company name  
Contact  
Phone number  
e-mail address

Operating data						
1	Pumpe type	Single head pump		Fluid	Water, pure	
2	No. of pumps	1		Operating temperature t A	°C	4
3	Nominal flow	m³/h	0	Max / Min Operating Temperature mech. Seal	°C	120 / -10
4	Nominal head	m	0	pH-value at t A		7
5	Static head	m	0	Density at t A	kg/m³	1000
6	Inlet pressure	kPa	0	Kin. viscosity at t A	mm²/s	1.569
7	Environmental temperature	°C	20	Vapor pressure at t A	kPa	100
8	Available system NPSH	m	0	Altitude		0

Pump data						
9	Lubrication	Standard, Grease lubrication [Std]				
10	Execution					
11	Design	Horizontal				Impeller Ø
12	Operating speed	2900 rpm	Stages	1		
13	Suction nozzle	DN 65 /	PN 16 /	EN1092-1		
14	Discharge nozzle	DN 40 /	PN 16 /	EN1092-1		Flow
15	Max. casing pressure	kPa	1200			
16	Max. working pressure	kPa	732.3			Head
17	Impeller type	Radial impeller				
18	Head H(Q=0)	m	75			
19	Max. shaft power	kW	11			Shaft power
20	Pump weight	kg				Efficiency
21	Total weight	kg	129.0			NPSH 3%

Materials						
22		Pump			Shaft Seal	
23	Pump body	Stainless steel / AISI 316L			Single mechanical seal, without shaft sleeve	
24	Impeller	Stainless steel / AISI 316L			Uniten 3K	VBVGG
25	SEAL HOUSING	Stainless steel / AISI 316L			Mechanical seal diameter	
26	Wear ring	Stainless steel / AISI 316L			1. Rotating ring	Ceramic
27	Counterwear ring	Stainless steel / AISI 316L			2. Stationary ring	Carbon graphite resin impregnated
28	Rigid shaft coupling	Stainless steel / AISI 316L			3. Secondary seal	Fluorine rubber (FKM)
29	Impeller locknut and washer	Stainless steel / AISI 316			4. Springs	CrNiMo - Steel
30	Tab	Stainless steel / AISI 316L			5. Others	CrNiMo - Steel
31	Fill/drain plugs	Stainless steel / AISI 316			Gaskets of the pump	Fluorine rubber (FKM)
32						
33						
34						
35						
36						
37						
38						
39						
40						
41						

Motor data					
Electrical and dimensional data refer to IE3 motor					
42	Manufacturer	Lowara PLM			
43	Specific design	IE3 3ph Flange Motor - Premium Efficiency			
44	Type	PLM 160 B35 11 kW			
45	Rated power	11 kW	Rated current	20.2 A	
46	Nominal speed	2935 rpm	Rated voltage	400 V	
47	Frame size	160	Service factor	1	
48	Weight	kg 83.2	Degree of protection	IP55	

Remarks					
49					
50					
50					
52					

# ESHS 40-250/110/P25VSSA

## Performance curve

Company name  
Contact  
Phone number  
e-mail address

	Ø mm	Pump capacity			Pump head		Shaft power P2			Frequency	Hz	
		Operating range Min. m³/h	Max. m³/h	η Max. m³/h	H(Q=0) m	η Max. m	P2(Q=0) kW	Max. kW	η Max. kW	Operating speed	rpm	
actual	233	18	46	39.3	74.6	58.3		11	10.7	Nominal flow	m³/h	0
Min.	0	/	/	36.1	64.9	51.4		/	8.56	Nominal head	m	0
Max.	251	/	/	43.2	89.8	70.2		/	14.3	Inlet pressure	kPa	0
										Static head	m	0

**Power datas referred to:**

hydr. Performance acceptance acc. To EN ISO 9906 Class Grade 3B

Water, pure [100%] ; 4°C; 1000kg/m³; 1.57mm²/s

MEI: N.A - according to Ecodesign Directive 2009/125/EC and Regulation (EU) No.547/2012

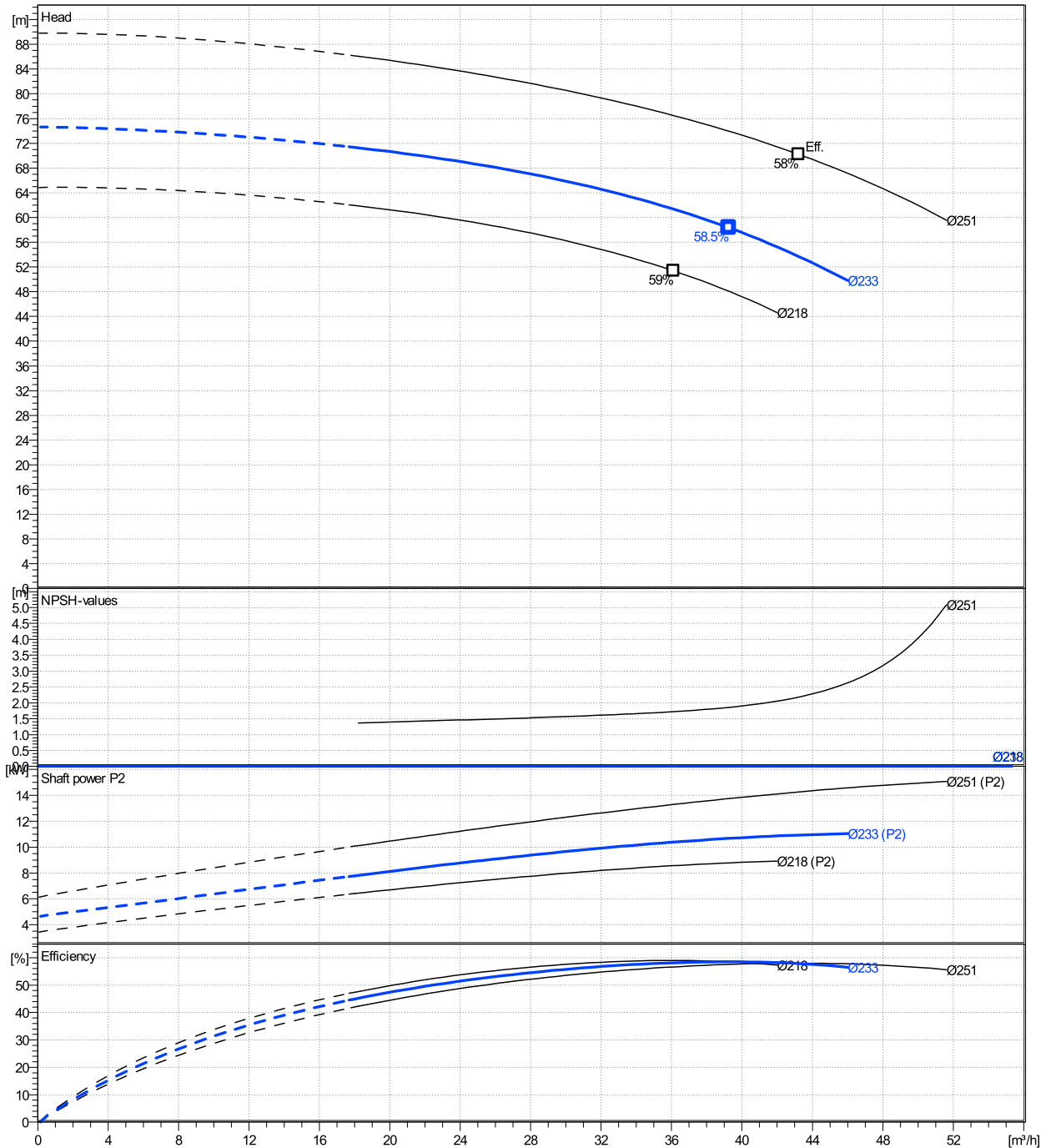

# ESHS 40-250/110/P25VSSA

## Dimensions

Company name  
Contact  
Phone number  
e-mail address

Rigid coupling

PLM 160 B35 11 kW

Electrical and dimensional data refer to IE3 motor

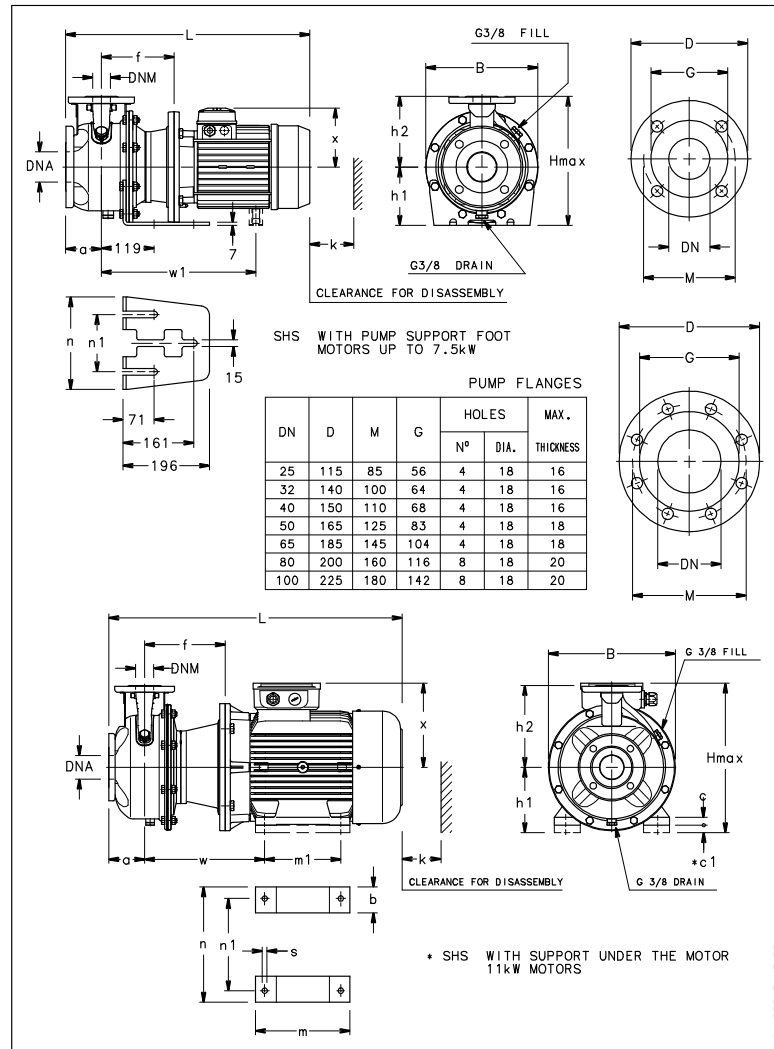

Dimensions		[ mm ]	
a	100		
B	350		
b	49		
c	5		
DNA	65		
DNM	40		
f	222		
h1	180		
h2	225		
Hmax	420		
k	107		
L	816		
m	304		
m1	210		
n	304		
n1	254		
s	15		
w	330		
x	240		

Weight	
Total weight	129 kg

Connections			
<b>Suction nozzle</b>		<b>Discharge nozzle</b>	
DN 65		DN 40	
PN 16		PN 16	
EN1092-1		EN1092-1	
D	185	D	150
Dia. Holes	18	Dia. Holes	18
DN	65	DN	40
G	104	G	68
M	145	M	110
Max thickness	16	Max thickness	16

### Dimensions and weight without obligation

Project Xlect-20117698  
Block ESHS 40-250/150/P25VSSA

Created by  
Created on 12/18/2024

Last update 12/18/2024