

# NSCS 100-315/185/L45VCC4

## Technical data

Company name  
Contact  
Phone number  
e-mail address

Operating data				
1	Pumpe type	Single head pump	Fluid	Water, pure
2	No. of pumps	1	Operating temperature t A	°C 4
3	Nominal flow	m³/h 0	Max / Min Operating Temperature mech. Seal	°C 120 / -25
4	Nominal head	m 0	pH-value at t A	7
5	Static head	m 0	Density at t A	kg/m³ 1000
6	Inlet pressure	kPa 0	Kin. viscosity at t A	mm²/s 1.569
7	Environmental temperature	°C 20	Vapor pressure at t A	kPa 100
8	Available system NPSH	m 0	Altitude	0

Pump data				
9	Lubrication	32		
10	Execution	Standard Design (Type B)		
11	Design	Horizontal		
12	Operating speed	1480 rpm	Stages	1
13	Suction nozzle	DN125 / PN10/16 / EN1092-2	Impeller Ø	Max. mm 334
14	Discharge nozzle	DN100 / PN10/16 / EN1092-2		designed mm 298
15	Max. casing pressure	kPa	Flow	Min. mm 260
16	Max. working pressure	kPa 308.8		Nominal m³/h
17	Impeller type	Radial impeller		Max- m³/h 235
18	Head H(Q=0)	m 31	Head	Min- m³/h 22.5
19	Max. shaft power	kW 18		Nominal m
20	Pump weight	kg	at Qmax m 18.8	at Qmin m 31.3
21	Total weight	kg 252.8	Shaft power kW	Efficiency %
			NPSH 3%	m

Materials				
Pump		Shaft Seal		
22			Single mechanical seal, without shaft sleeve	
23	Volute Casing	Cast Iron, EN 1561 - GJL-250, ASTM Class 35		
24	Impeller	Cast Iron, EN 1561 - GJL-200, ASTM Class 30		eMG12 - Ø38mm BQ7EGG-WA
25	Casing Cover	Cast Iron, EN 1561 - GJL-250, ASTM Class 35		Mechanical seal diameter 38 mm
26	Shaft	Stainless steel, 1.4057, AISI 431		1. Rotating ring Carbon graphite resin impregnated
27	Wear ring	Stainless steel, 1.4301, AISI 304		2. Stationary ring SiC, silicon carbide, sintered press.less
28	Impeller lock nut and washer	A4 (1.4401)		3. Secondary seal Ethylene propylene rubber (EPDM)
29	Impeller key	Stainless steel, 1.4571, AISI 316Ti		4. Springs CrNiMo - Steel
30	Fill and drain plugs	Galvanized carbon steel, EN 10277-3, AISI 1213 / 1215		5. Others EPDM - WRAS
31	Bearing bracket	Cast Iron, EN 1561 - GJL-250, ASTM Class 35		Gaskets of the pump Ethylene propylene rubber (EPDM)
32				
33				
34				
35				
36				
37				
38				
39				
40				
41				

Motor data				
Electrical and dimensional data refer to IE3 motor				
42	Manufacturer	Lowara		
43	Specific design	IE3 3ph Flange Motor - Premium Efficiency		
44	Type	3MAS 180 M B35 18,5 kW		
45	Rated power	18.5 kW	Rated current	36 A
46	Nominal speed	1475 rpm	Rated voltage	400 V
47	Frame size	180 M	Service factor	1
48	Weight	kg 141.8	Degree of protection	IP55

Remarks				
49				
50				
50				
52				

Project	Xylect-20303810	Created by		Last update	12/6/2024
Block	NSCS 100-315/300/L45VCC4	Created on	12/6/2024		

# NSCS 100-315/185/L45VCC4

## Performance curve

Company name  
Contact  
Phone number  
e-mail address

	Ø mm	Pump capacity			Pump head		Shaft power P2			Frequency	Hz	50
		Operating range Min. m <sup>3</sup> /h	Max. m <sup>3</sup> /h	η Max. m <sup>3</sup> /h	H(Q=0) m	η Max. m	P2(Q=0) kW	Max. kW	η Max. kW	Operating speed	rpm	1480
actual	298	22.5	235	173	31.5	26.5	18	15.7	Nominal flow	m <sup>3</sup> /h	0	
Min.	0	/	/	148	23.7	19.4	/	9.96	Nominal head	m	0	
Max.	334	/	/	190	40	34.4	/	22.1	Inlet pressure	kPa	0	
									Static head	m	0	

**Power datas referred to:**

hydr. Performance acceptance acc. To EN ISO 9906 Class Grade 3B

Water, pure [100%] ; 4°C; 1000kg/m<sup>3</sup>; 1.57mm<sup>2</sup>/s

MEI: 0,69 - according to Ecodesign Directive 2009/125/EC and Regulation (EU) No.547/2012

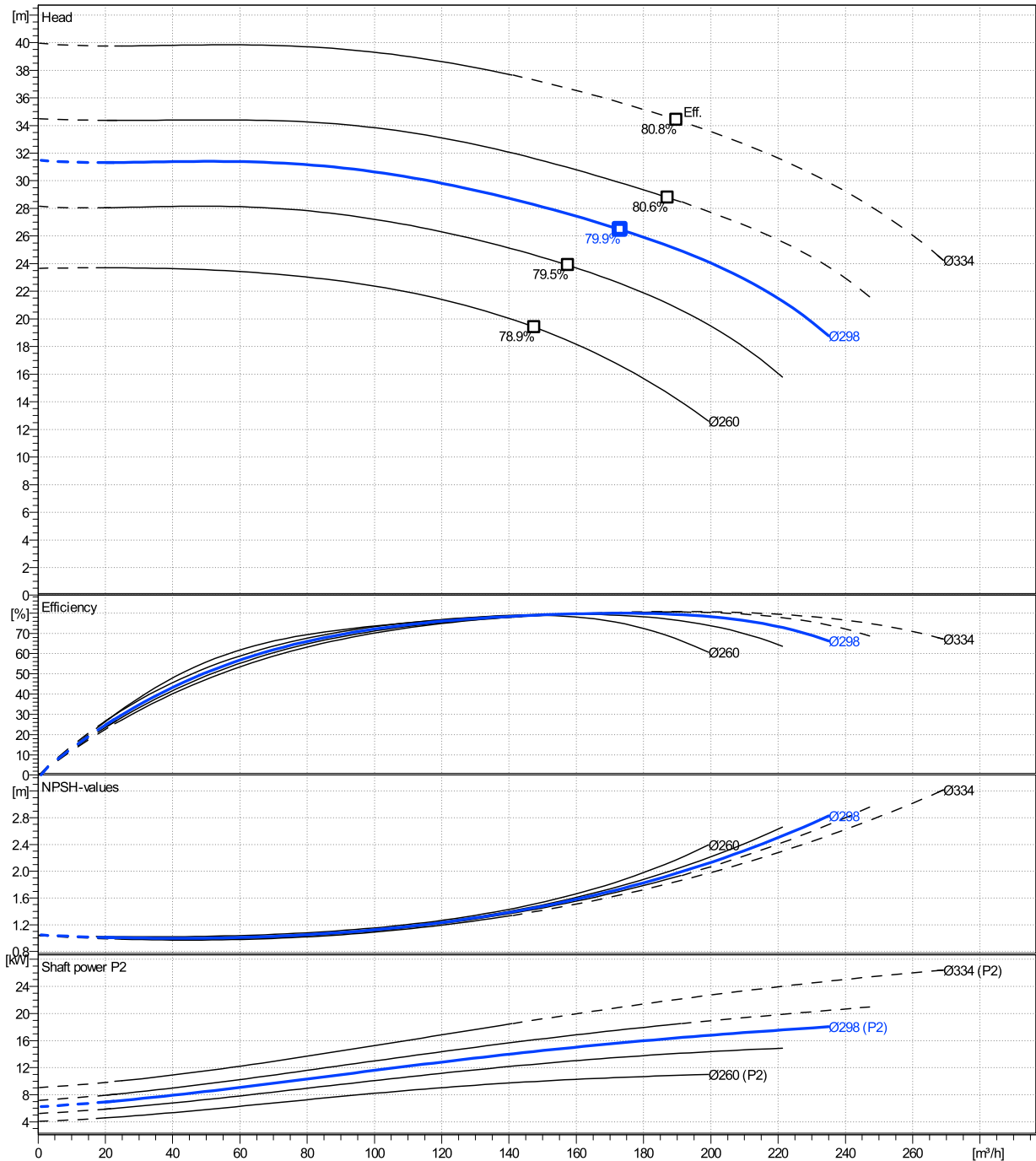

# NSCS 100-315/185/L45VCC4

## Dimensions

Company name  
Contact  
Phone number  
e-mail address

Blockpump  
Standard Design (Type B)  
3MAS 180 M B35 18,5 kW

Electrical and dimensional data refer to IE3 motor

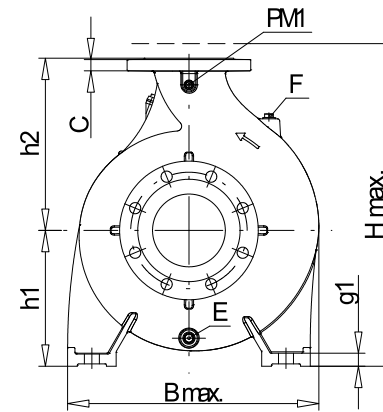

PM1...Pressure gauge connector  
E...Drain  
F...Filling



Value C, D may vary from Standard

Dimensions [ mm ]			
a	140	L	971
A	279	m1	160
AA	64	m2	120
AB	364	n1	400
AD	264	n2	315
B	241	P	350
b	80	PM1	1/4"
BB	286	s1	19
Bmax	481	Trim	0
CTO	0	Type	B
DNd	100	Volumen	0.26388
DNs	125	w	361
E	3/8"	x	140
f	240		
F	3/8"		
g1	26		
H	180		
h1	250		
h2	315		
h3	0		
HA	22		
Hmax	565		
hs	70		
K	15		

Weight	
Total weight	252.8 kg

Connections			
Suction nozzle		Discharge nozzle	
DN125		DN100	
PN10/16		PN10/16	
EN1092-2		EN1092-2	
C	26	C	24
D	255	D	230
d1	184	d1	157
K	210	K	180
L	19	L	19
z	8	z	8

### Dimensions and weight without obligation

Project	Xylect-20303810	Created by		Last update	12/6/2024
Block	NSCS 100-315/300/L45VCC4	Created on	12/6/2024		