

NSCS 150-315/300/L45VCC4

Technical data

Company name
Contact
Phone number
e-mail address

Operating data						
1	Pumpe type	Single head pump		Fluid	Water, pure	
2	No. of pumps	1		Operating temperature t A	°C	4
3	Nominal flow	m ³ /h	0	Max / Min Operating Temperature mech. Seal	°C	120 / -25
4	Nominal head	m	0	pH-value at t A		7
5	Static head	m	0	Density at t A	kg/m ³	1000
6	Inlet pressure	kPa	0	Kin. viscosity at t A	mm ² /s	1.569
7	Environmental temperature	°C	20	Vapor pressure at t A	kPa	100
8	Available system NPSH	m	0	Altitude		0

Pump data						
9	Lubrication	42				
10	Execution	Standard Design (Type B)				
11	Design	Horizontal				
12	Operating speed	1480 rpm	Stages	1		
13	Suction nozzle	DN200	/	PN16	/ EN1092-2	
14	Discharge nozzle	DN150	/	PN10/16	/ EN1092-2	
15	Max. casing pressure	kPa				
16	Max. working pressure	kPa	271.4			
17	Impeller type	Radial impeller				
18	Head H(Q=0)	m	28			
19	Max. shaft power	kW	29.9			
20	Pump weight	kg				
21	Total weight	kg	372.5			

	Impeller Ø	Max.	mm	330
		designed	mm	291
		Min.	mm	291
		Nominal	m ³ /h	
	Flow	Max-	m ³ /h	542
		Min-	m ³ /h	75
		Nominal	m	
	Head	at Qmax	m	13.1
		at Qmin	m	27.7
		Shaft power	kW	
		Efficiency	%	
		NPSH 3%	m	

Materials						
	Pump			Shaft Seal		
23	Volute Casing	Cast Iron, EN 1561 - GJL-250, ASTM Class 35			Single mechanical seal, without shaft sleeve	
24	Impeller	Cast Iron, EN 1561 - GJL-200, ASTM Class 30			eMG12 - Ø48mm	BQ7EGG-WA
25	Casing Cover	Cast Iron, EN 1561 - GJL-250, ASTM Class 35			Mechanical seal diameter	48 mm
26	Shaft	Stainless steel, 1.4057, AISI 431			1. Rotating ring	Carbon graphite resin impregnated
27	Wear ring	Stainless steel, 1.4301, AISI 304			2. Stationary ring	SiC, silicon carbide, sintered press.less
28	Impeller lock nut and washer	A4 (1.4401)			3. Secondary seal	Ethylene propylene rubber (EPDM)
29	Impeller key	Stainless steel, 1.4571, AISI 316Ti			4. Springs	CrNiMo - Steel
30	Fill and drain plugs	Galvanized carbon steel, EN 10277-3, AISI 1213 / 1215			5. Others	EPDM - WRAS
31	Bearing bracket	Cast Iron, EN 1561 - GJL-250, ASTM Class 35			Gaskets of the pump	Ethylene propylene rubber (EPDM)
32						
33						
34						
35						
36						
37						
38						
39						
40						
41						

Motor data					
Electrical and dimensional data refer to IE3 motor					
42	Manufacturer	Lowara			
43	Specific design	IE3 3ph Flange Motor - Premium Efficiency			
44	Type	3MAS 200 L B35 30 kW			
45	Rated power	30 kW	Rated current	53.3 A	
46	Nominal speed	1475 rpm	Rated voltage	400 V	
47	Frame size	200 L	Service factor	1	
48	Weight	kg 209.5	Degree of protection	IP55	

Remarks					
49					
50					
50					
52					

Project	Xylect-20303810	Created by		Last update	12/6/2024
Block	NSCS 150-315/450/L45VCC4	Created on	12/6/2024		

NSCS 150-315/300/L45VCC4

Performance curve

Company name
Contact
Phone number
e-mail address

	Ø mm	Pump capacity			Pump head		Shaft power P2			Frequency	Hz	50
		Operating range Min. m³/h	Max. m³/h	η Max. m³/h	H(Q=0) m	η Max. m	P2(Q=0) kW	Max. kW	η Max. kW	Operating speed	rpm	1480
actual	291	75	542	370	27.7	23.5		29.9	28.2	Nominal flow	m³/h	0
Min.	0	/	/	370	27.7	23.5		/	28.2	Nominal head	m	0
Max.	330	/	/	429	36.4	30.3		/	41.2	Inlet pressure	kPa	0
										Static head	m	0

Power datas referred to:

hydr. Performance acceptance acc. To EN ISO 9906 Class Grade 3B

Water, pure [100%] ; 4°C; 1000kg/m³; 1.57mm²/s

MEI: 0,58 - according to Ecodesign Directive 2009/125/EC and Regulation (EU) No.547/2012

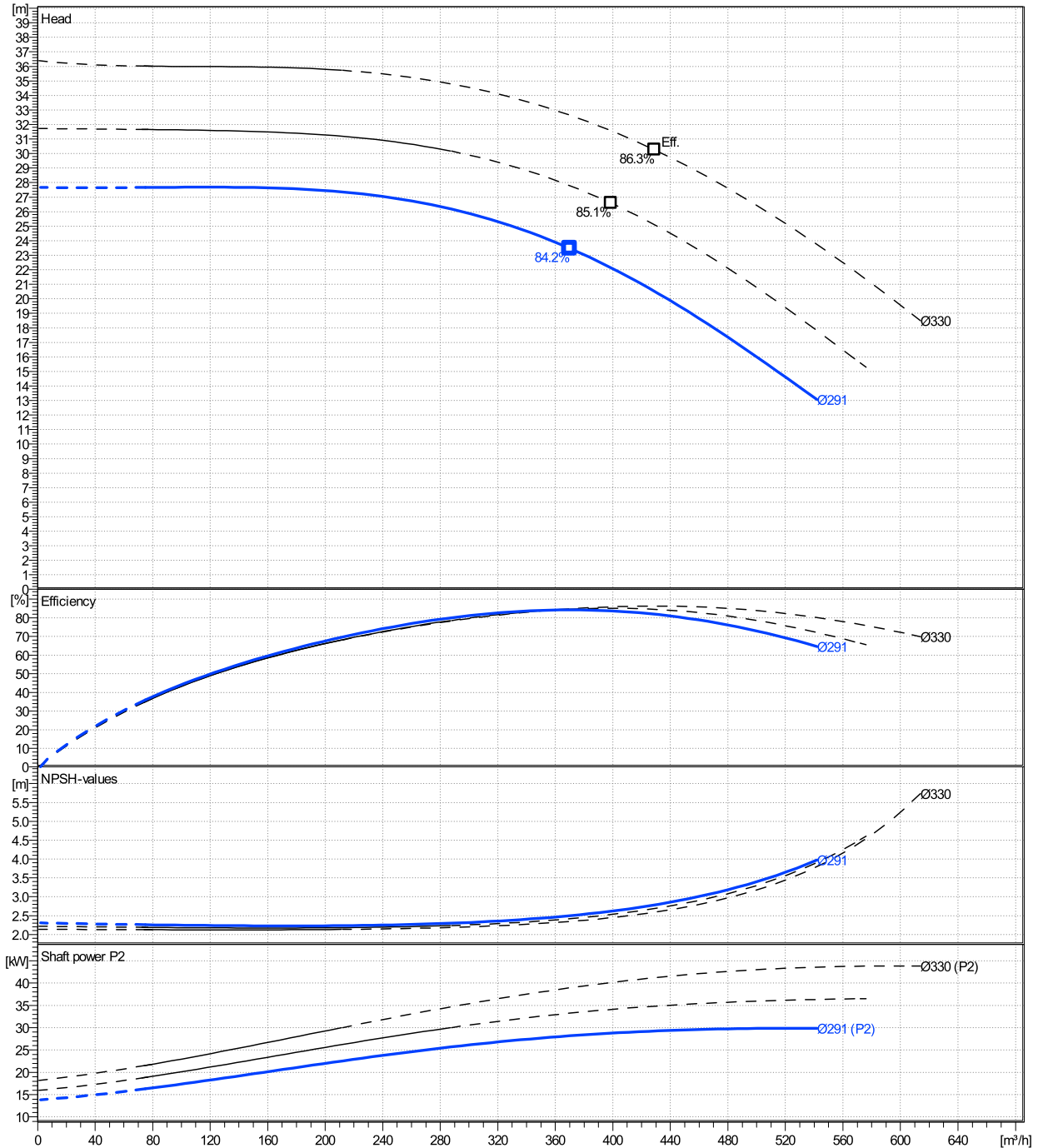

NSCS 150-315/300/L45VCC4

Dimensions

Company name
Contact
Phone number
e-mail address

Blockpump
Standard Design (Type B)
3MAS 200 L B35 30 kW

Electrical and dimensional data refer to IE3 motor

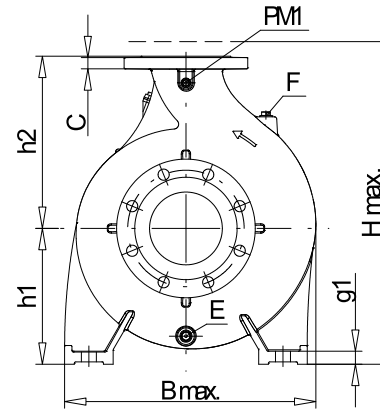
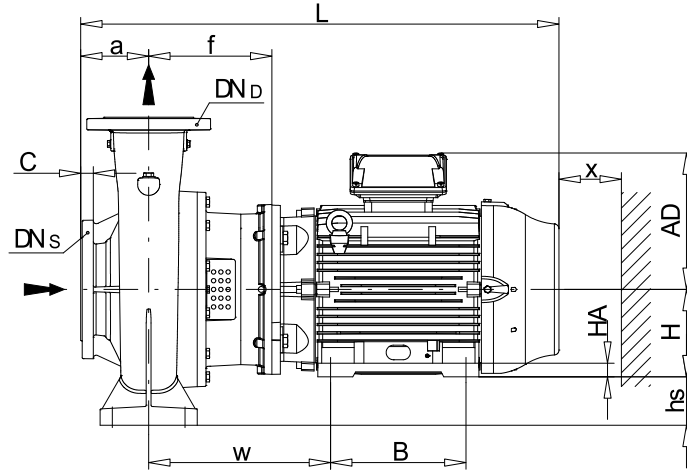

PM1...Pressure gauge connector
E...Drain
F...Filling



Value C, D may vary from Standard

Dimensions [mm]			
a	160	L	1085
A	318	m1	200
AA	69	m2	150
AB	408	n1	550
AD	300	n2	450
b	100	P	400
B	305	PM1	1/4"
BB	355	s1	23
Bmax	586	Trim	0
CTO	0	Type	B
DNd	150	Volumen	0.43235
DNs	200	w	387
E	3/8"	x	140
f	254		
F	3/8"		
g1	26		
H	200		
h1	280		
h2	400		
h3	0		
HA	27		
Hmax	680		
hs	80		
K	19		

Weight	
Total weight	372.5 kg

Connections			
Suction nozzle		Discharge nozzle	
DN200		DN150	
PN16		PN10/16	
EN1092-2		EN1092-2	
C	30	C	26
D	345	D	285
d1	266	d1	211
K	295	K	240
L	23	L	23
z	12	z	8

Dimensions and weight without obligation

Project	Xylect-20303810	Created by		Last update	12/6/2024
Block	NSCS 150-315/450/L45VCC4	Created on	12/6/2024		