

NSCS 200-250/110/L65VDC4

Technical data

Company name
Contact
Phone number
e-mail address

Operating data					
1	Pumpe type	Single head pump		Fluid	Water, pure
2	No. of pumps	1		Operating temperature t A	°C 4
3	Nominal flow	m³/h	0	Max / Min Operating Temperature mech. Seal	°C 120 / -25
4	Nominal head	m	0	pH-value at t A	7
5	Static head	m	0	Density at t A	kg/m³ 1000
6	Inlet pressure	kPa	0	Kin. viscosity at t A	mm²/s 1.569
7	Environmental temperature	°C	20	Vapor pressure at t A	kPa 100
8	Available system NPSH	m	0	Altitude	0

Pump data					
9	Lubrication	42			
10	Execution	Standard Design (Type B)			
11	Design	Horizontal			
12	Operating speed	975 rpm	Stages	1	
13	Suction nozzle	DN250	/	PN16	/ EN1092-2
14	Discharge nozzle	DN200	/	PN16	/ EN1092-2
15	Max. casing pressure	kPa			
16	Max. working pressure	kPa	99.8		
17	Impeller type	Radial impeller			
18	Head H(Q=0)	m	10		
19	Max. shaft power	kW	8.5		
20	Pump weight	kg			
21	Total weight	kg	313.0		

	Impeller Ø	Max.	mm	271
		designed	mm	271
		Min.	mm	234
		Nominal	m³/h	
	Flow	Max-	m³/h	570
		Min-	m³/h	80
		Nominal	m	
	Head	at Qmax	m	3
		at Qmin	m	9.8
		Shaft power	kW	
		Efficiency	%	
		NPSH 3%	m	

Materials					
	Pump			Shaft Seal	
22				Single mechanical seal, without shaft sleeve	
23	Volute Casing	Ductile Iron, EN-GJS-400-15, ASTM A536 40-60-18			
24	Impeller	Cast Iron, EN 1561 - GJL-200, ASTM Class 30			eMG12 - Ø48mm
25	Casing Cover	Ductile Iron, EN-GJS-400-15, ASTM A536 40-60-18			BQ7EGG-WA
26	Shaft	Stainless steel, 1.4057, AISI 431			Mechanical seal diameter
27	Wear ring	Stainless steel, 1.4301, AISI 304			48 mm
28	Impeller lock nut and washer	A4 (1.4401)			1. Rotating ring
29	Impeller key	Stainless steel, 1.4571, AISI 316Ti			Carbon graphite resin impregnated
30	Fill and drain plugs	Galvanized carbon steel, EN 10277-3, AISI 1213 / 1215			2. Stationary ring
31	Bearing bracket	Cast Iron, EN 1561 - GJL-250, ASTM Class 35			SiC, silicon carbide, sintered press. less
32					3. Secondary seal
33					Ethylene propylene rubber (EPDM)
34					4. Springs
35					CrNiMo - Steel
36					5. Others
37					EPDM - WRAS
38					Gaskets of the pump
39					Ethylene propylene rubber (EPDM)
40					
41					

Motor data					
Electrical and dimensional data refer to IE3 motor					
42	Manufacturer	Lowara			
43	Specific design	IE3 3ph Flange Motor - Premium Efficiency			
44	Type	3MAS 160 L B35 11 kW			
45	Rated power	11 kW	Rated current	23 A	
46	Nominal speed	975 rpm	Rated voltage	400 V	
47	Frame size	160 L	Service factor	1	
48	Weight	kg 108.0	Degree of protection	IP55	

Remarks					
49					
50					
50					
52					

NSCS 200-250/110/L65VDC4

Performance curve

Company name
Contact
Phone number
e-mail address

	Ø mm	Pump capacity			Pump head		Shaft power P2			Frequency	Hz	
		Operating range Min. m³/h	Max. m³/h	η Max. m³/h	H(Q=0) m	η Max. m	P2(Q=0) kW	Max. kW	η Max. kW	Operating speed	rpm	
actual	271	80	570	380	10.2	6.9		8.47	8.43	Nominal flow	m³/h	0
Min.	0	/	/	336	7.2	4.71		/	5.5	Nominal head	m	0
Max.	271	/	/	380	10.2	6.9		/	8.43	Inlet pressure	kPa	0
										Static head	m	0

Power datas referred to:

hydr. Performance acceptance acc. To EN ISO 9906 Class Grade 2B

Water, pure [100%] ; 4°C; 1000kg/m³; 1.57mm²/s

MEI: >=0,70 - according to Ecodesign Directive 2009/125/EC and Regulation (EU) No.547/2012

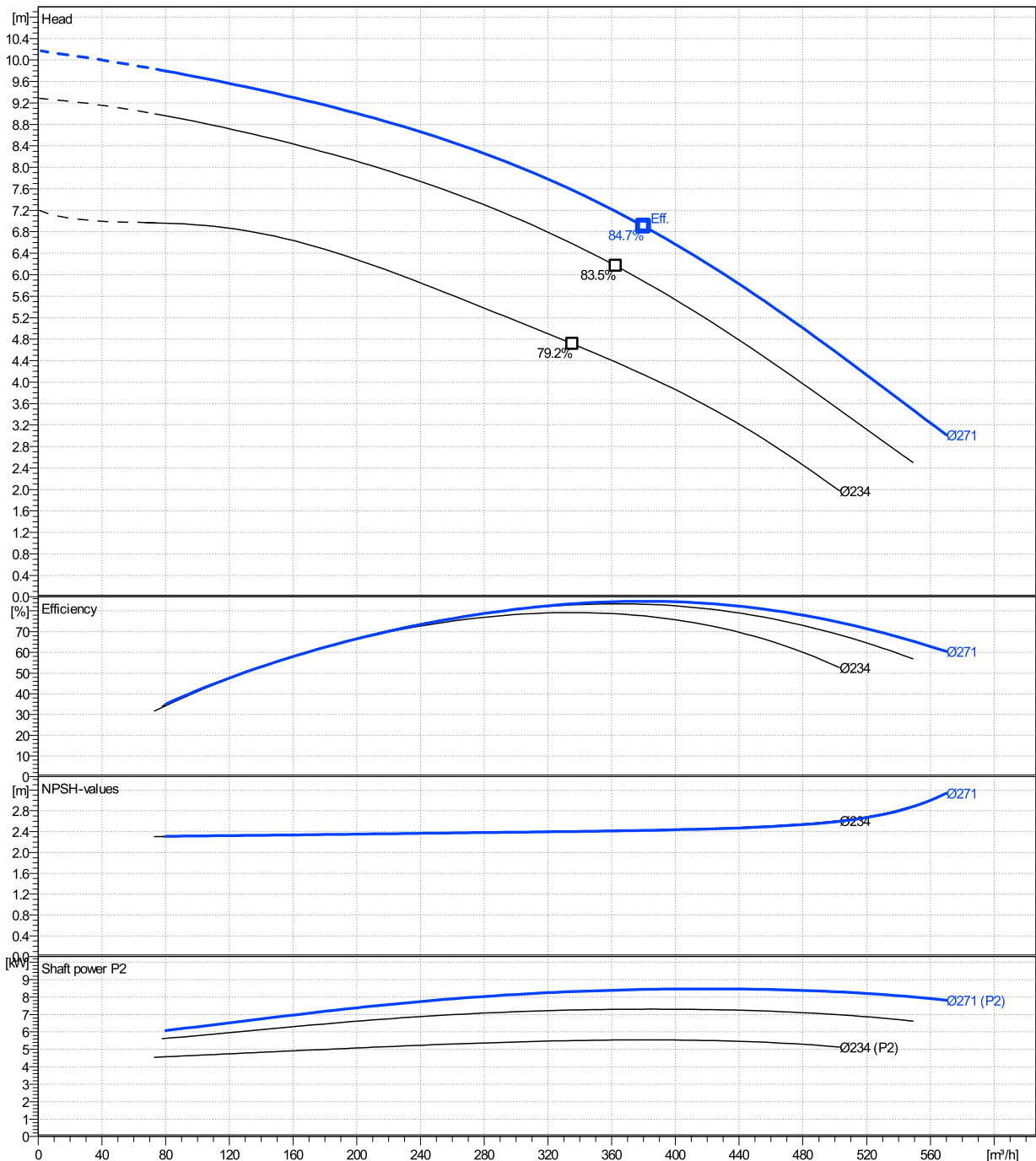

NSCS 200-250/110/L65VDC4

Dimensions

Company name
Contact
Phone number
e-mail address

Blockpump
Standard Design (Type B)
3MAS 160 L B35 11 kW

Electrical and dimensional data refer to IE3 motor

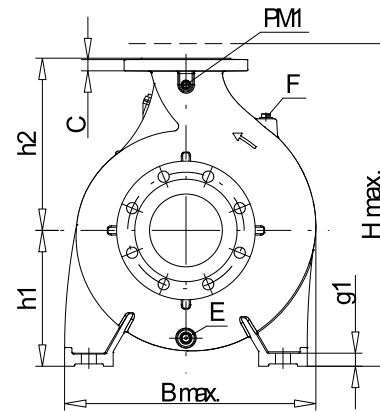

PM1...Pressure gauge connector
E...Drain
F...Filling



Value C, D may vary from Standard

Dimensions [mm]			
a	180	L	979
A	254	m1	200
AA	62	m2	150
AB	332	n1	550
AD	252	n2	450
b	100	P	350
B	254	PM1	1/2"
BB	299	s1	23
Bmax	655	Trim	0
CTO	0	Type	B
DNd	200	Volumen	0.53223
DNs	250	w	362
E	1/2"	x	200
F	-		
f	254		
g1	26		
H	160		
h1	355		
h2	475		
h3	0		
HA	22		
Hmax	830		
hs	195		
K	15		

Weight	
Total weight	313 kg

Connections			
Suction nozzle		Discharge nozzle	
DN250		DN200	
PN16		PN16	
EN1092-2		EN1092-2	
C	32	C	30
D	405	D	345
d1	319	d1	266
K	355	K	295
L	28	L	23
z	12	z	12

Dimensions and weight without obligation

Project	Xylect-20255621	Created by		Created on	11/26/2024	Last update	11/26/2024
Block	NSCS 200-250/300/L45VDC4						