

NSCS 200-250/220/L45VDC4

Technical data

Company name
Contact
Phone number
e-mail address

Operating data					
1	Pumpe type	Single head pump	Fluid	Water, pure	
2	No. of pumps	1	Operating temperature t A	°C	4
3	Nominal flow	m ³ /h 0	Max / Min Operating Temperature mech. Seal	°C	120 / -25
4	Nominal head	m 0	pH-value at t A		7
5	Static head	m 0	Density at t A	kg/m ³	1000
6	Inlet pressure	kPa 0	Kin. viscosity at t A	mm ² /s	1.569
7	Environmental temperature	°C 20	Vapor pressure at t A	kPa	100
8	Available system NPSH	m 0	Altitude		0

Pump data					
9	Lubrication	42			
10	Execution	Standard Design (Type B)			
11	Design	Horizontal			
12	Operating speed	1480 rpm	Stages	1	
13	Suction nozzle	DN250 / PN16 / EN1092-2	Impeller Ø	Max.	mm 271
14	Discharge nozzle	DN200 / PN16 / EN1092-2		designed	mm 245
15	Max. casing pressure	kPa	Flow	Min.	mm 228
16	Max. working pressure	kPa 183.5		Nominal	m ³ /h
17	Impeller type	Radial impeller		Max-	m ³ /h 740
18	Head H(Q=0)	m 19	Head	Min-	m ³ /h 142
19	Max. shaft power	kW 22.1		Nominal	m
20	Pump weight	kg	Shaft power	at Qmax	m 6.6
21	Total weight	kg 360.9	Efficiency	at Qmin	m 18.1
			NPSH 3%		

Materials					
Pump			Shaft Seal		
22				Single mechanical seal, without shaft sleeve	
23	Volute Casing	Ductile Iron, EN-GJS-400-15, ASTM A536 40-60-18		eMG12 - Ø48mm	
24	Impeller	Cast Iron, EN 1561 - GJL-200, ASTM Class 30		BQ7EGG-WA	
25	Casing Cover	Ductile Iron, EN-GJS-400-15, ASTM A536 40-60-18		Mechanical seal diameter	
26	Shaft	Stainless steel, 1.4057, AISI 431		48 mm	
27	Wear ring	Stainless steel, 1.4301, AISI 304		1. Rotating ring	
28	Impeller lock nut and washer	A4 (1.4401)		Carbon graphite resin impregnated	
29	Impeller key	Stainless steel, 1.4571, AISI 316Ti		2. Stationary ring	
30	Fill and drain plugs	Galvanized carbon steel, EN 10277-3, AISI 1213 / 1215		SiC, silicon carbide, sintered press.less	
31	Bearing bracket	Cast Iron, EN 1561 - GJL-250, ASTM Class 35		3. Secondary seal	
32				Ethylene propylene rubber (EPDM)	
33				4. Springs	
34				CrNiMo - Steel	
35				5. Others	
36				EPDM - WRAS	
37				Gaskets of the pump	
38				Ethylene propylene rubber (EPDM)	
39					
40					
41					

Motor data					
Electrical and dimensional data refer to IE3 motor					
42	Manufacturer	Lowara			
43	Specific design	IE3 3ph Flange Motor - Premium Efficiency			
44	Type	3MAS 180 L B35 22 kW			
45	Rated power	22 kW	Rated current	42.2 A	
46	Nominal speed	1470 rpm	Rated voltage	400 V	
47	Frame size	180 L	Service factor	1	
48	Weight	kg 155.9	Degree of protection	IP55	

Remarks					
49					
50					
50					
52					

Project	Xylect-20255621	Created by		Last update	11/26/2024
Block	NSCS 200-250/300/L45VDC4	Created on	11/26/2024		

NSCS 200-250/220/L45VDC4

Performance curve

Company name
Contact
Phone number
e-mail address

	Ø mm	Pump capacity			Pump head		Shaft power P2			Frequency	
		Operating range Min. m³/h	Max. m³/h	η Max. m³/h	H(Q=0) m	η Max. m	P2(Q=0) kW	Max. kW	η Max. kW	Hz	
	245	142	740	531	18.7	12.4	22.1	22		50	1480
actual	245	142	740	531	18.7	12.4	22.1	22		50	1480
Min.	0	/	/	512	15.7	10.1	/	18.1			0
Max.	271	/	/	572	22.7	15.7	/	28.8			0

Power datas referred to:

hydr. Performance acceptance acc. To EN ISO 9906 Class Grade 2B

Water, pure [100%] ; 4°C; 1000kg/m³; 1.57mm²/s

MEI: >=0,70 - according to Ecodesign Directive 2009/125/EC and Regulation (EU) No.547/2012

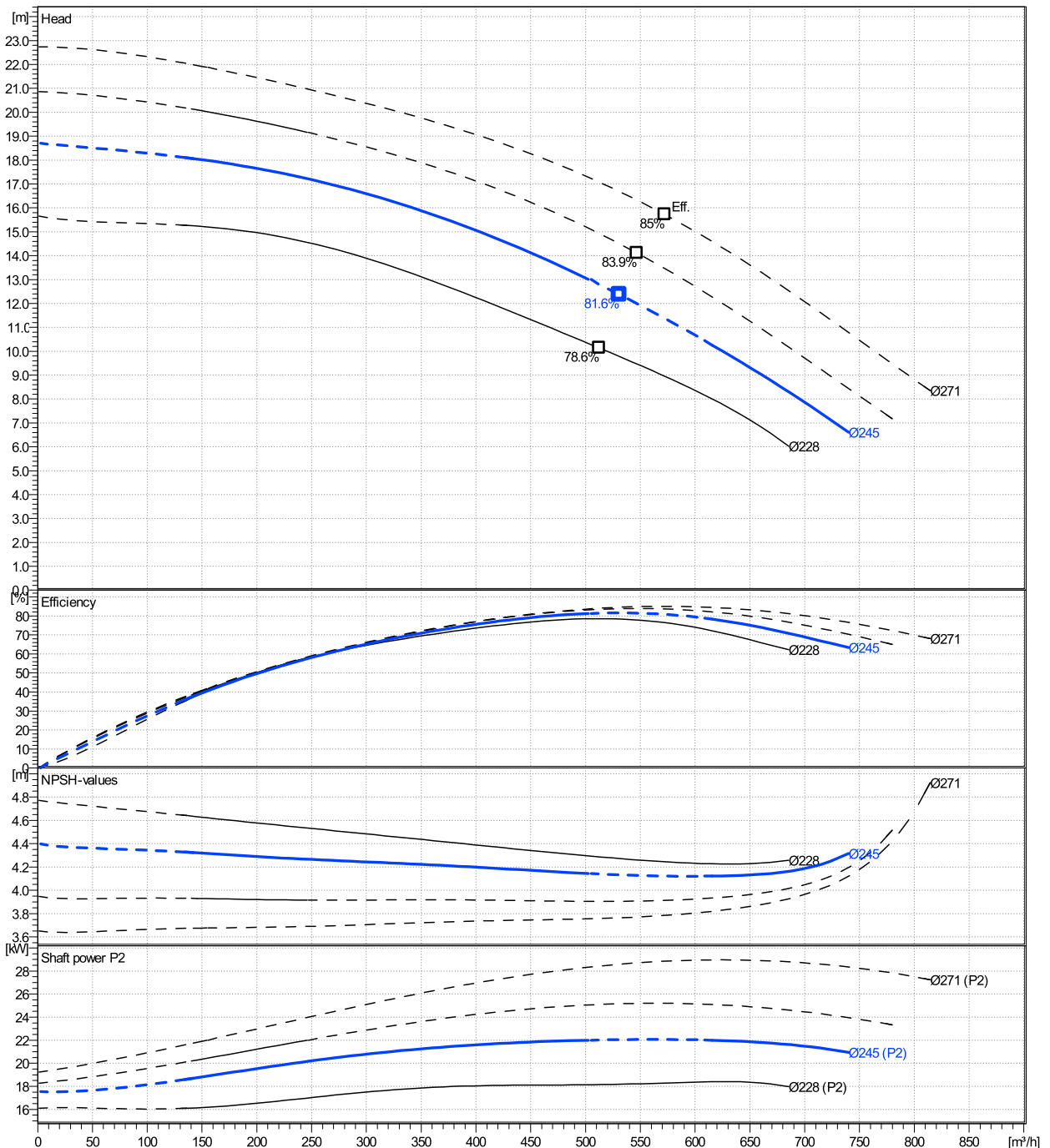

NSCS 200-250/220/L45VDC4

Dimensions

Company name
Contact
Phone number
e-mail address

Blockpump
Standard Design (Type B)
3MAS 180 L B35 22 kW

Electrical and dimensional data refer to IE3 motor

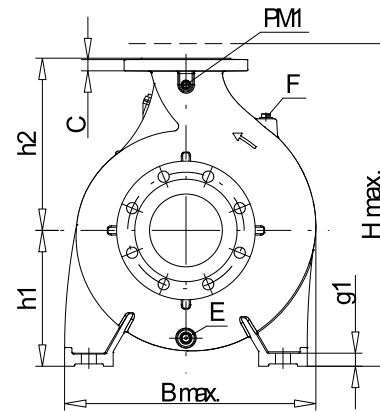

PM1...Pressure gauge connector
E...Drain
F...Filling



Value C, D may vary from Standard

Dimensions [mm]			
a	180	L	1025
A	279	m1	200
AA	64	m2	150
AB	364	n1	550
AD	264	n2	450
b	100	P	350
B	279	PM1	1/2"
BB	324	s1	23
Bmax	655	Trim	0
CTO	0	Type	B
DNd	200	Volumen	0.55724
DNs	250	w	375
E	1/2"	x	200
F	-		
f	254		
g1	26		
H	180		
h1	355		
h2	475		
h3	0		
HA	22		
Hmax	830		
hs	175		
K	15		

Weight	
Total weight	360.9 kg

Connections			
Suction nozzle		Discharge nozzle	
DN250		DN200	
PN16		PN16	
EN1092-2		EN1092-2	
C	32	C	30
D	405	D	345
d1	319	d1	266
K	355	K	295
L	28	L	23
z	12	z	12

Dimensions and weight without obligation

Project	Xylect-20255621	Created by		Created on	11/26/2024	Last update	11/26/2024
Block	NSCS 200-250/300/L45VDC4						