

NSCS 200-315/185/L65VDC4

Technical data

Company name
Contact
Phone number
e-mail address

Operating data				
1	Pumpe type	Single head pump	Fluid	Water, pure
2	No. of pumps	1	Operating temperature t A	°C 4
3	Nominal flow	m³/h 0	Max / Min Operating Temperature mech. Seal	°C 120 / -25
4	Nominal head	m 0	pH-value at t A	7
5	Static head	m 0	Density at t A	kg/m³ 1000
6	Inlet pressure	kPa 0	Kin. viscosity at t A	mm²/s 1.569
7	Environmental temperature	°C 20	Vapor pressure at t A	kPa 100
8	Available system NPSH	m 0	Altitude	0

Pump data				
9	Lubrication	42		
10	Execution	Standard Design (Type B)		
11	Design	Horizontal		
12	Operating speed	980 rpm	Stages	1
13	Suction nozzle	DN250 / PN16 / EN1092-2	Impeller Ø	Max. mm 333
14	Discharge nozzle	DN200 / PN16 / EN1092-2		designed mm 333
15	Max. casing pressure	kPa	Flow	Min. mm 260
16	Max. working pressure	kPa 154.6		Nominal m³/h
17	Impeller type	Radial impeller		Max- m³/h 620
18	Head H(Q=0)	m 16	Head	Min- m³/h 80
19	Max. shaft power	kW 16.4		Nominal m
20	Pump weight	kg	at Qmax m 5.9	at Qmin m 15.4
21	Total weight	kg 386.8	Shaft power kW	Efficiency %
			NPSH 3%	m

Materials				
Pump		Shaft Seal		
22			Single mechanical seal, without shaft sleeve	
23	Volute Casing	Ductile Iron, EN-GJS-400-15, ASTM A536 40-60-18		
24	Impeller	Cast Iron, EN 1561 - GJL-200, ASTM Class 30		eMG12 - Ø48mm BQ7EGG-WA
25	Casing Cover	Ductile Iron, EN-GJS-400-15, ASTM A536 40-60-18		Mechanical seal diameter 48 mm
26	Shaft	Stainless steel, 1.4057, AISI 431		1. Rotating ring Carbon graphite resin impregnated
27	Wear ring	Stainless steel, 1.4301, AISI 304		2. Stationary ring SiC, silicon carbide, sintered press.less
28	Impeller lock nut and washer	A4 (1.4401)		3. Secondary seal Ethylene propylene rubber (EPDM)
29	Impeller key	Stainless steel, 1.4571, AISI 316Ti		4. Springs CrNiMo - Steel
30	Fill and drain plugs	Galvanized carbon steel, EN 10277-3, AISI 1213 / 1215		5. Others EPDM - WRAS
31	Bearing bracket	Cast Iron, EN 1561 - GJL-250, ASTM Class 35		Gaskets of the pump Ethylene propylene rubber (EPDM)
32				
33				
34				
35				
36				
37				
38				
39				
40				
41				

Motor data				
Electrical and dimensional data refer to IE3 motor				
42	Manufacturer	Lowara		
43	Specific design	IE3 3ph Flange Motor - Premium Efficiency		
44	Type	3MAS 200 L B35 18,5 kW		
45	Rated power	18.5 kW	Rated current	37.1 A
46	Nominal speed	980 rpm	Rated voltage	400 V
47	Frame size	200 L	Service factor	1
48	Weight	kg 180.8	Degree of protection	IP55

Remarks				
49				
50				
50				
52				

Project	Xylect-20303810	Created by		Last update	12/6/2024
Block	NSCS 200-315/750/L45VDC4 E4	Created on	12/6/2024		

NSCS 200-315/185/L65VDC4

Performance curve

Company name
Contact
Phone number
e-mail address

	Ø mm	Pump capacity			Pump head		Shaft power P2			Frequency	Hz	
		Operating range Min. m³/h	Max. m³/h	η Max. m³/h	H(Q=0) m	η Max. m	P2(Q=0) kW	Max. kW	η Max. kW	Operating speed	rpm	
actual	333	80	620	420	15.8	12.3		16.4	16.3	Nominal flow	m³/h	0
Min.	0	/	/	326	9.22	7.04		/	7.69	Nominal head	m	0
Max.	333	/	/	420	15.8	12.3		/	16.3	Inlet pressure	kPa	0
										Static head	m	0

Power datas referred to:

hydr. Performance acceptance acc. To EN ISO 9906 Class Grade 2B

Water, pure [100%] ; 4°C; 1000kg/m³; 1.57mm²/s

MEI: 0,56 - according to Ecodesign Directive 2009/125/EC and Regulation (EU) No.547/2012

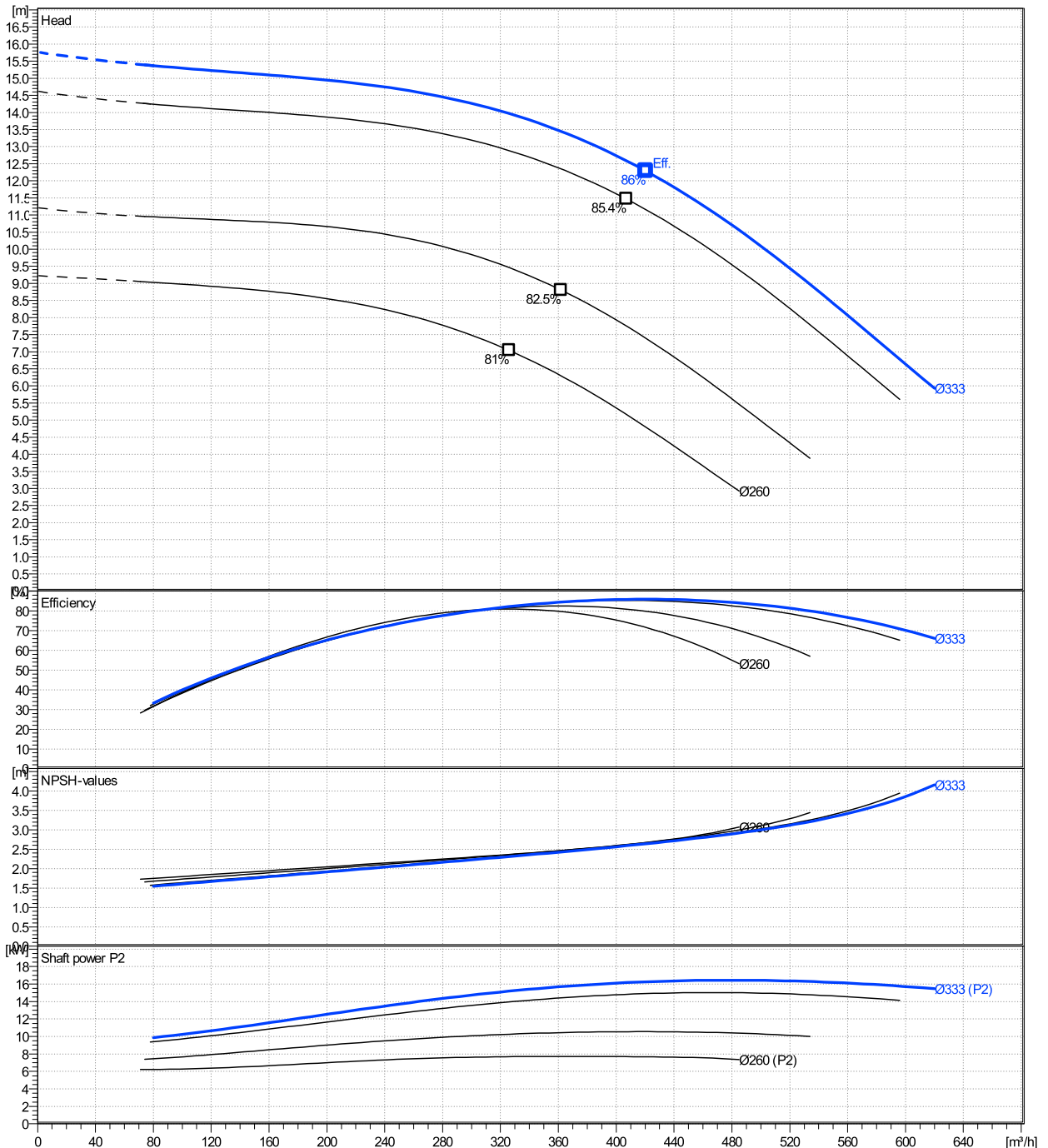

NSCS 200-315/185/L65VDC4

Dimensions

Company name
Contact
Phone number
e-mail address

Blockpump
Standard Design (Type B)
3MAS 200 L B35 18,5 kW

Electrical and dimensional data refer to IE3 motor

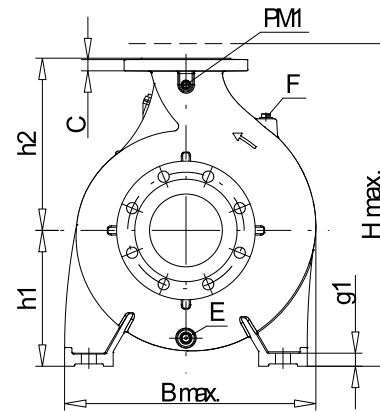

PM1...Pressure gauge connector
E...Drain
F...Filling



Value C, D may vary from Standard

Dimensions [mm]			
a	180	L	1105
A	318	m1	200
AA	69	m2	150
AB	408	n1	550
AD	300	n2	450
b	100	P	400
B	305	PM1	1/2"
BB	355	s1	23
Bmax	645	Trim	0
CTO	0	Type	B
DNd	200	Volumen	0.57374
DNs	250	w	387
E	1/2"	x	200
F	-		
f	254		
g1	26		
H	200		
h1	355		
h2	450		
h3	0		
HA	27		
Hmax	805		
hs	155		
K	19		

Weight

Total weight 386.8 kg

Connections

Suction nozzle		Discharge nozzle	
DN250		DN200	
PN16		PN16	
EN1092-2		EN1092-2	
C	32	C	30
D	405	D	345
d1	319	d1	266
K	355	K	295
L	28	L	23
z	12	z	12

Dimensions and weight without obligation

Project Xylect-20303810
Block NSCS 200-315/750/L45VDC4 E4

Created by
Created on 12/6/2024

Last update 12/6/2024