

# NSCS 65-315/150/P45VCC4

## Technical data

Company name  
Contact  
Phone number  
e-mail address

Operating data					
1	Pumpe type	Single head pump	Fluid	Water, pure	
2	No. of pumps	1	Operating temperature t A	°C	4
3	Nominal flow	m³/h 0	Max / Min Operating Temperature mech. Seal	°C	120 / -25
4	Nominal head	m 0	pH-value at t A		7
5	Static head	m 0	Density at t A	kg/m³	1000
6	Inlet pressure	kPa 0	Kin. viscosity at t A	mm²/s	1.569
7	Environmental temperature	°C 20	Vapor pressure at t A	kPa	100
8	Available system NPSH	m 0	Altitude		0

Pump data					
9	Lubrication	32			
10	Execution	Standard Design (Type B)			
11	Design	Horizontal			
12	Operating speed	1465 rpm	Stages	1	
13	Suction nozzle	DN80 /	PN10/16 /	EN1092-2	
14	Discharge nozzle	DN65 /	PN10/16 /	EN1092-2	
15	Max. casing pressure	kPa		Impeller Ø	Max. mm 334
16	Max. working pressure	kPa	380.3		designed mm 334
17	Impeller type	Radial impeller			Min. mm 260
18	Head H(Q=0)	m	39	Flow	Nominal m³/h
19	Max. shaft power	kW	12.4		Max- m³/h 130
20	Pump weight	kg			Min- m³/h 14
21	Total weight	kg	221.0	Head	Nominal m
					at Qmax m 20
					at Qmin m 38.8
				Shaft power	kW
				Efficiency	%
				NPSH 3%	m

Materials					
Pump			Shaft Seal		
22					
23	Volute Casing	Cast Iron, EN 1561 - GJL-250, ASTM Class 35		Single mechanical seal, without shaft sleeve	
24	Impeller	Cast Iron, EN 1561 - GJL-200, ASTM Class 30		eMG12 - Ø38mm	BQ7EGG-WA
25	Casing Cover	Cast Iron, EN 1561 - GJL-250, ASTM Class 35		Mechanical seal diameter	38 mm
26	Shaft	Stainless steel, 1.4057, AISI 431		1. Rotating ring	Carbon graphite resin impregnated
27	Wear ring	Stainless steel, 1.4301, AISI 304		2. Stationary ring	SiC, silicon carbide, sintered press.less
28	Impeller lock nut and washer	A4 (1.4401)		3. Secondary seal	Ethylene propylene rubber (EPDM)
29	Impeller key	Stainless steel, 1.4571, AISI 316Ti		4. Springs	CrNiMo - Steel
30	Fill and drain plugs	Galvanized carbon steel, EN 10277-3, AISI 1213 / 1215		5. Others	EPDM - WRAS
31	Bearing bracket	Cast Iron, EN 1561 - GJL-250, ASTM Class 35		Gaskets of the pump	Ethylene propylene rubber (EPDM)
32					
33					
34					
35					
36					
37					
38					
39					
40					
41					

Motor data					
Electrical and dimensional data refer to IE3 motor					
42	Manufacturer	Lowara			
43	Specific design	IE3 3ph Flange Motor - Premium Efficiency			
44	Type	PLM 160 B35 15 kW			
45	Rated power	15 kW	Rated current	30.7 A	
46	Nominal speed	1465 rpm	Rated voltage	400 V	
47	Frame size	160	Service factor	1	
48	Weight	kg 129.0	Degree of protection	IP55	

Remarks					
49					
50					
50					
52					

# NSCS 65-315/150/P45VCC4

## Performance curve

Company name  
Contact  
Phone number  
e-mail address

	Ø mm	Pump capacity			Pump head		Shaft power P2			Frequency		
		Operating range Min. m³/h	Max. m³/h	η Max. m³/h	H(Q=0) m	η Max. m	P2(Q=0) kW	Max. kW	η Max. kW	Hz		
actual	334	14	130	81.8	38.8	32.7	12.4	10.1	50	Operating speed	rpm	1465
Min.	0	/	/	61.2	22.7	18.7	/	4.57		Nominal flow	m³/h	0
Max.	334	/	/	81.8	38.8	32.7	/	10.1		Nominal head	m	0
										Inlet pressure	kPa	0
										Static head	m	0

**Power datas referred to:**

hydr. Performance acceptance acc. To EN ISO 9906 Class Grade 3B

Water, pure [100%] ; 4°C; 1000kg/m³; 1.57mm²/s

MEI: >=0,70 - according to Ecodesign Directive 2009/125/EC and Regulation (EU) No.547/2012

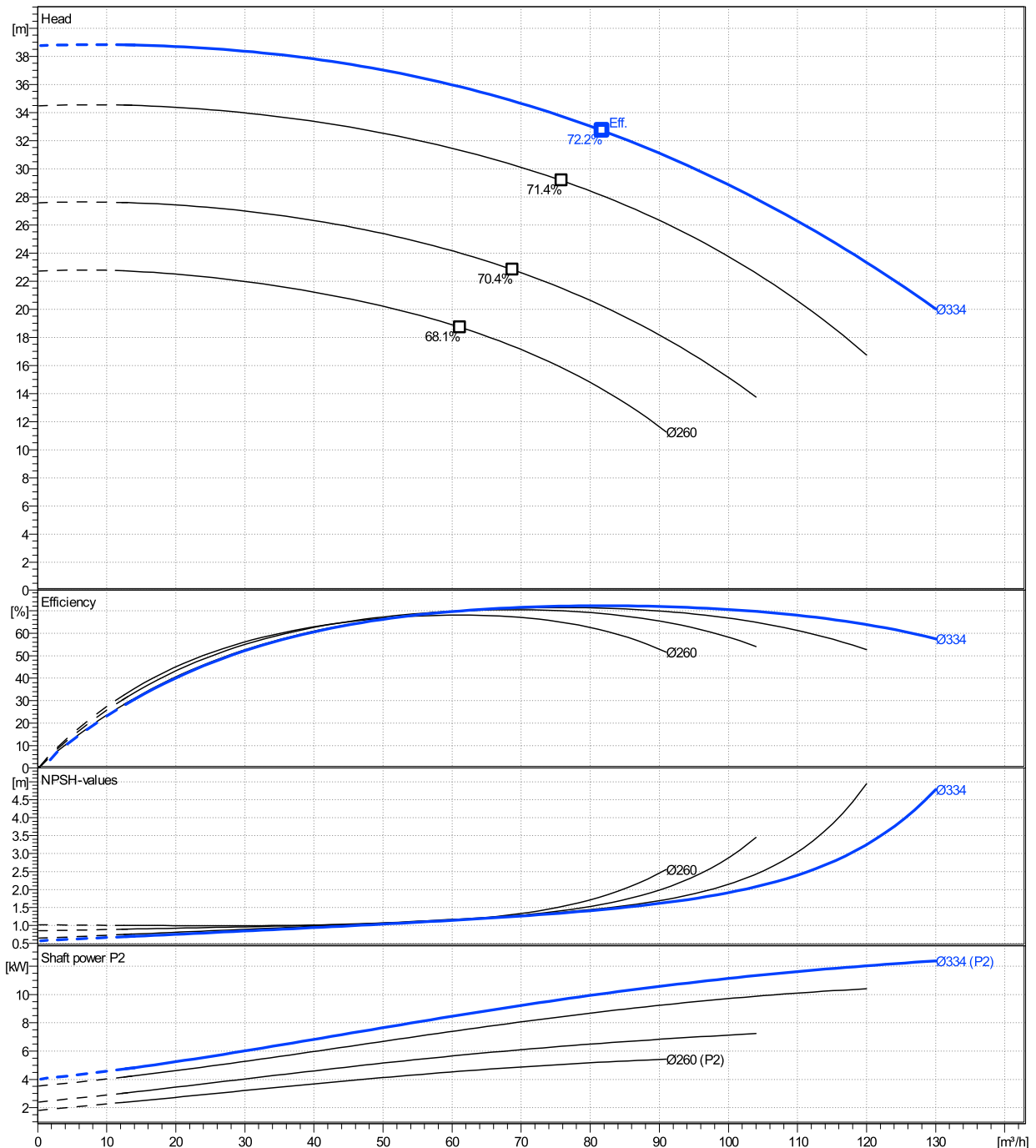

# NSCS 65-315/150/P45VCC4

## Dimensions

Company name  
Contact  
Phone number  
e-mail address

Blockpump  
Standard Design (Type B)  
PLM 160 B35 15 kW

Electrical and dimensional data refer to IE3 motor

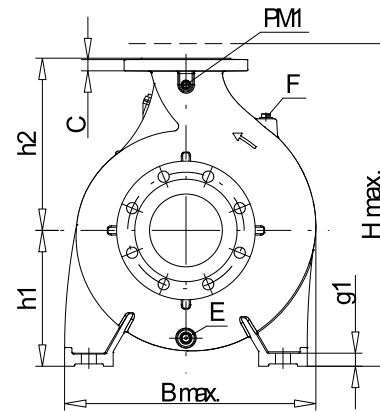

PM1...Pressure gauge connector  
E...Drain  
F...Filling



Value C, D may vary from Standard

Dimensions [ mm ]			
a	125	L	859
A	254	m1	160
AA	49	m2	120
AB	304	n1	400
AD	240	n2	315
B	254	P	350
b	80	PM1	1/4"
BB	304	s1	19
Bmax	437	Trim	0
CTO	0	Type	B
DNd	65	Volumen	0.18957
DNs	80	w	348
E	3/8"	x	140
f	240		
F	3/8"		
g1	20		
H	160		
h1	225		
h2	280		
h3	0		
HA	5		
Hmax	505		
hs	65		
K	15		

Weight	
Total weight	221 kg

Connections			
<b>Suction nozzle</b>		<b>Discharge nozzle</b>	
DN80		DN65	
PN10/16		PN10/16	
EN1092-2		EN1092-2	
C	22	C	20
D	200	D	185
d1	132	d1	118
K	160	K	145
L	19	L	19
z	8	z	4

### Dimensions and weight without obligation

Project	Xylect-20255621	Created by		Created on	11/26/2024	Last update	11/26/2024
Block	NSCS 65-315/900/L25VCC4 E4						