

NSCS150-200/300/L46UCC4

Technical data

Company name
Contact
Phone number
e-mail address

Operating data				
1	Pumpe type	Single head pump	Fluid	Water, pure
2	No. of pumps	1	Operating temperature t A	°F 39.2
3	Nominal flow	US g.p.m. 0	Max / Min Operating Temperature mech. Seal	°F 120 / -25
4	Nominal head	ft 0	pH-value at t A	7
5	Static head	ft 0	Density at t A	lb/ft ³ 62.4
6	Inlet pressure	psi 0	Kin. viscosity at t A	ft ² /s 1.689E-5
7	Environmental temperature	°F 68	Vapor pressure at t A	psi 14.5
8	Available system NPSH	ft 0	Altitude	0

Pump data				
9	Lubrication	32		
10	Execution	Standard Design (Type B)		
11	Design	Horizontal		
12	Operating speed	1770 rpm	Stages	1
13	Suction nozzle	DN200 / PN16 / EN1092-2	Impeller Ø	Max. inch 9 5/16
14	Discharge nozzle	DN150 / PN10/16 / EN1092-2		designed inch 9 5/16
15	Max. casing pressure	psi	Flow	Min. inch 7 1/2
16	Max. working pressure	psi 34.1		Nominal US g.p.m.
17	Impeller type	Radial impeller		Max- US g.p.m. 2729.8
18	Head H(Q=0)	ft 79	Head	Min- US g.p.m. 308.2
19	Max. shaft power	hp 33.9		Nominal ft
20	Pump weight	kg		at Qmax ft 34.6
21	Total weight	lb On demand	Shaft power hp	at Qmin ft 76.5
			Efficiency %	
			NPSH 3%	

Materials				
Pump		Shaft Seal		
22				
23	Volute Casing	Cast Iron, EN 1561 - GJL-250, ASTM Class 35		Single mechanical seal, without shaft sleeve
24	Impeller	Cast Iron, EN 1561 - GJL-200, ASTM Class 30		eMG12 - Ø38mm BQ7EGG-WA
25	Casing Cover	Cast Iron, EN 1561 - GJL-250, ASTM Class 35		Mechanical seal diameter 1 1/2 inch
26	Shaft	Stainless steel, 1.4057, AISI 431		1. Rotating ring Carbon graphite resin impregnated
27	Wear ring	Stainless steel, 1.4301, AISI 304		2. Stationary ring SiC, silicon carbide, sintered press.less
28	Impeller lock nut and washer	A4 (1.4401)		3. Secondary seal Ethylene propylene rubber (EPDM)
29	Impeller key	Stainless steel, 1.4571, AISI 316Ti		4. Springs CrNiMo - Steel
30	Fill and drain plugs	Galvanized carbon steel, EN 10277-3, AISI 1213 / 1215		5. Others EPDM - WRAS
31	Bearing bracket	Cast Iron, EN 1561 - GJL-250, ASTM Class 35		Gaskets of the pump Ethylene propylene rubber (EPDM)
32				
33				
34				
35				
36				
37				
38				
39				
40				
41				

Motor data				
Electrical and dimensional data refer to IE3 motor				
42	Manufacturer	Lowara		
43	Specific design	IE3 3ph Flange Motor - Premium Efficiency		
44	Type	3MAS 200 L B35 30 kW		
45	Rated power	40.231 hp	Rated current	55.7 A
46	Nominal speed	1764 rpm	Rated voltage	380 V
47	Frame size	200 L	Service factor	1
48	Weight	lb 461.9	Degree of protection	IP55

Remarks				
49				
50				
50				
52				

NSCS150-200/300/L46UCC4

Performance curve

Company name
Contact
Phone number
e-mail address

	Ø mm	Pump capacity			Pump head		Shaft power P2			Frequency	Hz	60
		Operating range Min. US g.p.m.	Max. US g.p.m.	η Max. US g.p.m.	H(Q=0) ft	η Max. ft	P2(Q=0) hp	Max. hp	η Max. hp	Operating speed	rpm	1770
actual	9 5/16	308	2730	2080	78.6	55.2		33.9	33.9	Nominal flow	US g.p.m.	0
Min.	0	/	/	1780	47.6	33.5		/	19.2	Nominal head	ft	0
Max.	9 5/16	/	/	2080	78.6	55.2		/	33.9	Inlet pressure	psi	0
										Static head	ft	0

Power datas referred to:

hydr. Performance acceptance acc. To EN ISO 9906 Class Grade 3B

Water, pure [100%] ; 39.2°F; 62.4lb/ft³; 1.69E-5ft²/s

MEI: >=0,70 - according to Ecodesign Directive 2009/125/EC and Regulation (EU) No.547/2012

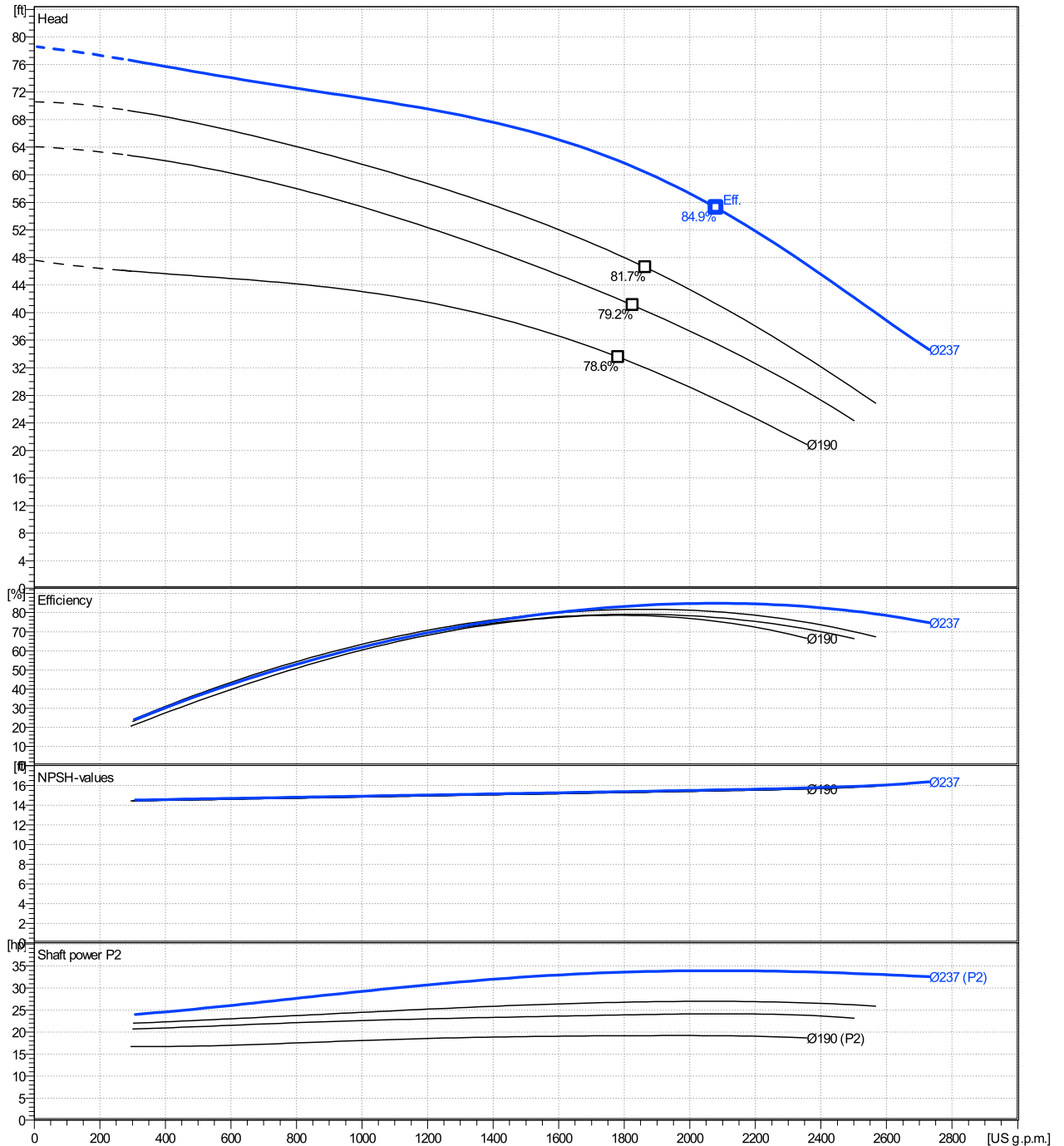

NSCS150-200/300/L46UCC4

Dimensions

Company name
Contact
Phone number
e-mail address

Blockpump
Standard Design (Type B)
3MAS 200 L B35 30 kW

Electrical and dimensional data refer to IE3 motor

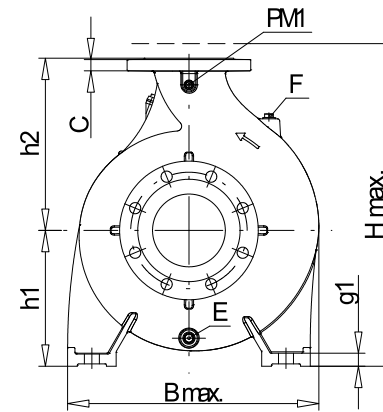

PM1...Pressure gauge connector
E...Drain
F...Filling



Value C, D may vary from Standard

Dimensions [inch]			
a	6 ⁵ / ₁₆	m1	7 ⁷ / ₈
A	12 ¹ / ₂	m2	5 ⁷ / ₈
AA	2 ¹¹ / ₁₆	n1	21 ⁵ / ₈
AB	16 ¹ / ₁₆	n2	17 ¹¹ / ₁₆
AD	11 ¹³ / ₁₆	P	15 ³ / ₄
b	3 ¹⁵ / ₁₆	PM1	1/4"
B	12 ¹ / ₆₄	s1	7/8
BB	14	Trim	
Bmax	23 ¹¹ / ₁₆	Type	B
CTO		w	14 ¹⁵ / ₁₆
DNd	5 ⁷ / ₈	x	5 ¹ / ₂
DNs	7 ⁷ / ₈		
E	3/8"		
f	9 ¹¹ / ₁₆		
F	3/8"		
g1	1 ¹ / ₃₂		
H	7 ⁷ / ₈		
h1	11 ¹ / ₃₂		
h2	15 ³ / ₄		
h3			
HA	1 ¹ / ₁₆		
Hmax	26 ³ / ₄		
hs	3 ¹ / ₈		
K	3/4		

Weight	
Total weight	On demand kg

Connections			
Suction nozzle		Discharge nozzle	
DN200		DN150	
PN16		PN10/16	
EN1092-2		EN1092-2	
C	1 ³ / ₁₆	C	1 ¹ / ₃₂
D	13 ⁹ / ₁₆	D	11 ¹ / ₄
d1	10 ¹ / ₂	d1	8 ⁵ / ₁₆
K	11 ⁵ / ₈	K	9 ⁷ / ₁₆
L	7/8	L	7/8
Z	1/2	Z	5/16

Dimensions and weight without obligation

Project	Xylect-20178897	Created by		Last update	1/10/2025
Block	NSCS150-200/300/L46UCC4	Created on	1/10/2025		